

KH-A-S Ball valve with SAE Flange adapter connection

SAE Flange / Ball valve 2/2 way steel
(ISO 6162-1/-2)

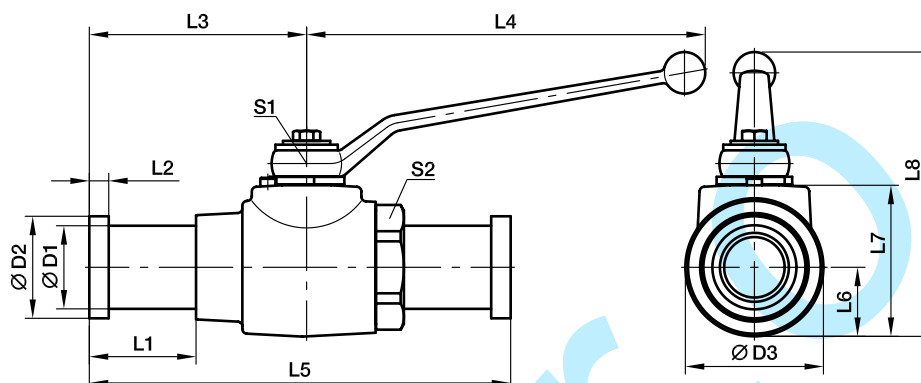

3000 PSI Series

| Nom. flange size | | | | | | | | | | | | | | | | | Weight (steel) kg/piece | | PN (bar) ¹⁾ S |
|---------------------|-------------|----|------|----|------|-----|-------|-----|-------|------|-----|-----|----|----|------------|-------------|-------------------------------|-----|--------------------------------|
| SAE (in) | ISO (DN) | D1 | D2 | D3 | L1 | L2 | L3 | L4 | L5 | L6 | L7 | L8 | S1 | S2 | O-ring | Order code* | | | |
| 1/2 | 12 | 24 | 30.2 | 35 | 42.0 | 6.7 | 75.5 | 112 | 151.0 | 17.0 | 40 | 92 | 10 | 32 | 18.66×3.53 | 0.9 | KH12A32 | 350 | |
| 3/4 | 20 | 32 | 38.1 | 45 | 43.0 | 6.7 | 81.0 | 187 | 162.0 | 24.0 | 55 | 113 | 14 | 41 | 25.00×3.53 | 1.7 | KH20A33 | 315 | |
| 1 | 25 | 38 | 44.4 | 55 | 38.9 | 8.0 | 89.0 | 187 | 178.0 | 26.0 | 60 | 118 | 14 | 50 | 32.92×3.53 | 2.5 | KH25A34 | 315 | |
| 1 1/4 | 32 | 43 | 50.8 | 73 | 40.3 | 8.0 | 99.0 | 227 | 190.5 | 36.5 | 80 | 155 | 17 | 60 | 37.70×3.53 | 3.1 | KH32A35 | 276 | |
| 1 1/2 | 40 | 50 | 60.3 | 85 | 58.3 | 8.0 | 115.5 | 227 | 231.0 | 42.5 | 90 | 165 | 17 | 70 | 47.22×3.53 | 4.3 | KH40A36 | 207 | |
| 2 | 50 | 62 | 71.4 | 99 | 50.9 | 9.5 | 116.0 | 227 | 232.0 | 49.5 | 104 | 179 | 17 | 85 | 56.74×3.53 | 5.8 | KH50A38 | 207 | |

6000 PSI Series

| | | | | | | | | | | | | | | | | | | |
|-------|----|----|------|----|------|------|-------|-----|-------|------|-----|-----|----|----|------------|-----|----------------|-----|
| 1/2 | 12 | 24 | 31.7 | 35 | 42.0 | 7.7 | 75.5 | 112 | 151.0 | 17.0 | 40 | 92 | 10 | 32 | 18.66×3.53 | 1.0 | KH12A62 | 420 |
| 3/4 | 20 | 32 | 41.3 | 45 | 49.0 | 8.8 | 87.0 | 187 | 174.0 | 24.0 | 55 | 113 | 14 | 46 | 25.00×3.53 | 1.9 | KH20A63 | 315 |
| 1 | 25 | 38 | 47.6 | 55 | 49.0 | 9.5 | 99.0 | 187 | 198.0 | 26.0 | 60 | 118 | 14 | 50 | 32.92×3.53 | 2.8 | KH25A64 | 315 |
| 1 1/4 | 32 | 44 | 54.0 | 73 | 56.5 | 10.3 | 115.0 | 227 | 223.0 | 36.5 | 80 | 155 | 17 | 60 | 37.70×3.53 | 3.3 | KH32A65 | 315 |
| 1 1/2 | 40 | 51 | 63.5 | 85 | 83.5 | 12.6 | 140.5 | 227 | 281.0 | 42.5 | 90 | 165 | 17 | 70 | 47.22×3.53 | 4.8 | KH40A66 | 315 |
| 2 | 50 | 67 | 79.4 | 99 | 93.0 | 12.6 | 158.0 | 227 | 316.0 | 49.5 | 104 | 179 | 17 | 85 | 56.74×3.53 | 7.4 | KH50A68 | 315 |

¹⁾ Pressure shown = Item deliverable

The pressure specification PN for quarter turn ball valves applies to the design factor 1.5 (according DIN 3230 T5 and ISO 5208).

$$\frac{PN \text{ (bar)}}{10} = PN \text{ (MPa)}$$

Materials:

Body made of steel, coating DIN 50938-FE/A/T4, ball of hard chrome plated carbon steel, stem of zinc plated steel.

Seals:

Ball seat of POM (e.g. Delrin), stem seal of NBR (e.g. Perbunan).

Applications:

Suitable for petroleum-based hydraulic fluid, lubricants and fuel oil. For air applications suitable up to 100 bar.

Temperature range:

-10 up to +100° C

| Order code suffixes | | | |
|---------------------------------|-----------------------------|------------|---|
| Material | Suffix surface and material | Example | Standard sealing material (no additional suffix needed) |
| Steel, zinc plated, Cr(VI)-free | CF | KH12A63CFX | POM / NBR |
| Steel | DIN 50938-FE//A/T4 | KH12A63X | POM / NBR |