

## Flange - MF1 / MF2



Intended for fixed mounting of cylinder.  
Flange can be fitted to front or rear end cover of cylinder.

### Materials:

Flange: Surface-treated steel  
Mounting screws acc. to DIN 6912:  
Zinc-plated steel 8.8  
Supplied complete with mounting screws for attachment to the cylinder.

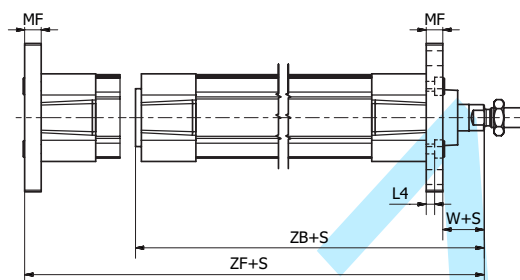
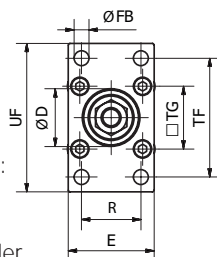

### According to ISO 15552

Cyl.-bore	D <sub>(H11)</sub>	E	ØFB <sub>(H13)</sub>	L4	MF	R	TF	TG	UF	W*	ZB*	ZF*	Weight	Order code
[mm]	[mm]	[mm]	[mm]	[mm]	[mm]	[mm]	[mm]	[mm]	[mm]	[mm]	[mm]	[mm]	[kg]	
Ø32	30	45	7	5.0	10	32	64	32.5	80	16	123.5	130	0.21	<b>P1C-4KMB</b>
Ø40	35	52	9	5.0	10	36	72	38.0	90	20	138.5	145	0.27	<b>P1C-4LMB</b>
Ø50	40	65	9	6.5	12	45	90	46.5	110	25	146.5	155	0.53	<b>P1C-4MMB</b>
Ø63	45	75	9	6.5	12	50	100	56.5	120	25	161.5	170	0.66	<b>P1C-4NMB</b>
Ø80	45	95	12	9.0	16	63	126	72.0	150	30	177.5	190	1.45	<b>P1C-4PMB</b>
Ø100	55	115	14	9.0	16	75	150	89.0	170	35	192.5	205	1.60	<b>P1C-4QMB</b>
Ø125	60	140	16	10.5	20	90	180	110.0	205	45	230.5	245	3.34	<b>P1C-4RMB</b>

\*Does not apply to cylinders with piston rod extension or lock units.

## Foot Bracket - MS1



Intended for fixed mounting of cylinder.  
Foot bracket can be fitted to front or rear end cover of the cylinder.

### Materials:

Flange: Surface-treated steel  
Mounting screws acc. to DIN 6912:  
Zinc-plated steel 8.8:

Supplied complete with mounting screws for attachment to the cylinder.

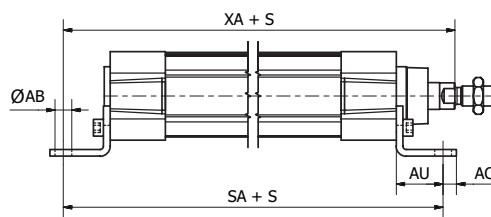
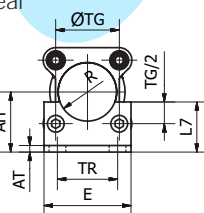

### According to ISO 15552

Cyl.-bore	ØAB <sub>(H14)</sub>	AH <sub>(JS15)</sub>	AO	AT	AU	E	L7	R	SA*	TG	TR <sub>(JS14)</sub>	XA*	Weight **	Order code
[mm]	[mm]	[mm]	[mm]	[mm]	[mm]	[mm]	[mm]	[mm]	[mm]	[mm]	[mm]	[mm]	[kg]	
Ø32	7.0	32	11	4	24	45	30	15.0	142	32.5	32	144	0.08	<b>P1C-4KMF</b>
Ø40	10.0	36	8	4	28	52	30	17.5	161	38.0	36	163	0.09	<b>P1C-4LMF</b>
Ø50	10.0	45	15	5	32	65	36	20.0	170	46.5	45	175	0.18	<b>P1C-4MMF</b>
Ø63	10.0	50	13	5	32	75	35	22.5	185	56.5	50	190	0.20	<b>P1C-4NMF</b>
Ø80	12.0	63	14	6	41	95	47	22.5	210	72.0	63	215	0.40	<b>P1C-4PMF</b>
Ø100	14.5	71	16	6	41	115	53	27.5	220	89.0	75	230	0.54	<b>P1C-4QMF</b>
Ø125	16.5	90	25	8	45	140	70	30.0	250	110.0	90	270	1.10	<b>P1C-4RMF</b>

\*Does not apply to cylinders with piston rod extension or lock units.

\*\* per bracket