

# Metal Quick Exhaust Valves

This range of metal quick exhaust valves is offered in nickel-plated brass, aluminium and stainless steel. These valves, which are suitable for **any environment**, increase the **return speed** of the cylinder rod by allowing the exhaust to pass directly to atmosphere.

## Product Advantages

<b>Time-Saving &amp; Compact</b>	Reduction in cycle times: return speed improved Dimensions optimised for space reduction Exhaust silencer incorporated on some models Excellent exhaust capacity Robust
<b>Nickel-Plated Brass or Stainless Steel</b>	Ideal for applications in restrictive environments Orientation as required Many installation options and choice of silencer Designed without retention areas to optimise frequent cleaning operations (stainless steel)
<b>Aluminium</b>	Protection of individuals through low noise emissions Lightweight and robust Silencer integrated for greater compactness



## Technical Characteristics

<b>Compatible Fluids</b>	Compressed air
<b>Working Pressure</b>	<b>7970:</b> 0.7 to 10 bar <b>7971 and 7899:</b> 2 to 10 bar
<b>Working Temperature</b>	<b>7970:</b> -20°C to +70°C <b>7971:</b> -10°C to +70°C <b>7899:</b> Threads G1/8 and G1/4: -10°C to +120°C Threads G3/8 to G1: -20°C to +180°C

**Component Materials**

**Body:**  
Model 7970: nickel-plated brass  
Model 7971: anodised aluminium  
Model 7899: stainless steel

**Integrated silencer:**  
stainless steel (model 7971)

**Lip seals:**  
7970-7971: polyurethane elastomer  
7899: G1/8 and G1/4 FKM  
G3/8 to G1, polyurethane

**Silicone-free**

**Regulations**

DI: 2002/95/EC (RoHS)  
RG: 1907/2006 (REACH)  
DI: 97/23/EC (PED)

## Operation

**Mounted on Cylinder**

**Installation Diagram**

The diagrams illustrate the valve's operation and installation. Diagram A shows the valve mounted on a cylinder with the exhaust port pointing upwards, allowing for 'Free exhaust'. Diagram B shows the valve mounted on a cylinder with the exhaust port pointing to the side. The schematic diagram shows a pneumatic circuit with a cylinder, a control valve, and the quick exhaust valve connected to the cylinder's exhaust port.

# Metal Quick Exhaust Valves

## 7970 Elbow Quick Exhaust Valve, Female BSPP and Metric Thread

Nickel-plated brass

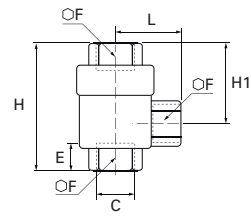

C		E	F	H	H1	L	Kg
M5x0.8	7970 19 19	5	10	24.8	15.6	4	0.029
G1/8	7970 10 10	7.5	14	42	28	8	0.084
G1/4	7970 13 13	11	19	53	34.5	11	0.148
G3/8	7970 17 17	12	21	58	36	12	0.153
G1/2	7970 21 21	14	26	71	44	14	0.316
G3/4	7970 27 27	16	32	86	52	18	0.449
G1	7970 34 34	19	38	94	56	19	0.531

Noise level:  
7971 10 10: 70 dBa  
7971 13 13: 70 dBa  
7971 17 17: 72 dBa  
7971 21 21: 88 dBa

## 7971 Elbow Quick Exhaust Valve, Male BSPT/Female BSPP Thread

Treated aluminium

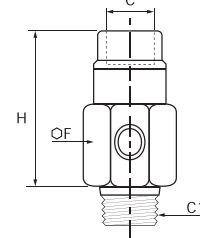

C	C1		F	H	Kg
G1/8	R1/8	7971 10 10	18	51	0.013
G1/4	R1/4	7971 13 13	18	49	0.018
G3/8	R3/8	7971 17 17	27	56	0.048
G1/2	R1/2	7971 21 21	34	70	0.086

## 7899 Quick Exhaust Valve, Female BSPP Thread

Stainless steel 316L

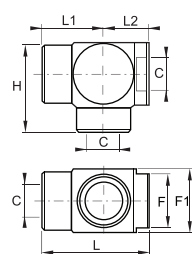

C	DN		F	F1	H	L	L1	L2	Kg
G1/8	7	7899 00 10	17	22	31.5	37.5	21	16.5	0.097
G1/4	7	7899 00 13	17	22	31.5	37.5	21	16.5	0.084
G3/8	9	7899 00 17	22	26	37	44.5	25.5	19	0.140
G1/2	12	7899 00 21	27	32	45	54	31	23	0.236
G3/4	18	7899 00 27	38	46	65	79	44	35	0.801
G1	18	7899 00 34	38	46	65	79	44	35	0.674

To complement our exhaust valves 7970 and 7899, you will find a full range of silencers on the following pages.