

## 20 Connection cables SCK

### Connection cables SCK

- Compact size
- Interference-free
- Compatible with all diagnosis sensors and diagnostic measuring devices
- Push-pull plug
- Various lengths available
- Oil-resistant material

#### Cables for CAN bus sensors

Parker CAN bus cables are used to connect Parker CAN bus sensors to **The Parker Service Master Plus** SCM-500 or **The Parker Serviceman Plus** SCM-155-2-05.

The quick-plug-screw connection SPEEDCON\* makes connecting simple and secure.

#### CAN connection cable

SCK-401-xx-4F-4M



#### CAN Y-junction

SCK-401-0.3-Y



#### CAN T-junction

SCK-401-T



#### CAN Y-junction

SCK-401-Y

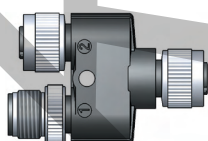

#### CAN terminating resistor

SCK-401-R



#### Cables for analogue sensors

The **SensoControl®** diagnostic cables were designed for use in harsh working conditions.

#### 5-pin version

The 5-pin cables with push-pull plugs are suitable for all 5-pin analogue connections.

#### 4-pin version

Diagnostic cables with 4-pin plugs are only compatible with the Serviceman types SCM-150-1-01/02 and SCM-152-2-08.

#### Connection cable (5 pin)

SCK-102-xx-02



#### Extension cable (5 pin)

SCK-102-05-12



#### Adapter

SCK-002-08

(for connecting 4-pin sensors to newer devices)



#### Connection cable (4 pin)

SCK-102-02-08

(for connecting newer analogue sensors to devices with 4-pin connection)



SPEEDCON® is a registered trademark of PHOENIX CONTACT GmbH & Co. KG

## Technical data

Plug housing		
Material		Cu alloy
Surface		Chrome plated
Protection class (while plugged in)		analogue IP54 CAN IP67
Cable		
Sheathing		PUR
Colour		black
Permitted temperature	Stationary operation	-20 ... +70 °C
	Non-stationary operation	-5 ... +70 °C
Shielding		Cu meshed shield

## Supply range and accessories

SCK analogue connection cables	Order code
3 m (male 5 pin - male 5 pin)	SCK-102-03-02
5 m (male 5 pin - male 5 pin)	SCK-102-05-02
5-m extension cable (male 5 pin - female 5 pin)	SCK-102-05-12
Adapter (female 4 pin - male 5 pin)	SCK-002-08
2 m (4 pin) is only for the older versions of the Serviceman (SCM-150-1-01/02 and SCM-152-2-08)	SCK-102-02-08

SCK connection cables CAN*	Order code
0.5 m (male 5 pin - female 5 pin)	SCK-401-0.5-4F-4M
2 m (male 5 pin - female 5 pin)	SCK-401-02-4F-4M
5 m (male 5 pin - female 5 pin)	SCK-401-05-4F-4M
10 m (male 5 pin - female 5 pin)	SCK-401-10-4F-4M
20 m (male 5 pin - female 5 pin)	SCK-401-20-4F-4M
CAN Y-junction	SCK-401-Y
CAN Y-junction incl. 0.3-m cable	SCK-401-0.3-Y
CAN T-junction	SCK-401-T
Terminating resistor** CAN (female 5 pin - female 5 pin)	SCK-401-R

\* Other lengths available on request

\*\* Each CAN network requires a terminating resistor.

# SCK cable

## Device features

- One cable for all
- Compact size
- Interference-free
- Compatible to:
  - Sensors
  - Controllers
- M12 plug
- DIN EN 175301 (Device plug)
- Available in a variety of lengths



The **SensoControl®** cable was designed for use with the industrial sensors and switches.

Thus the M12 cable and M12 plug are

- Compact
- Shielded
- Five-pole

### 5-pole version

The 5-pole cable is suitable for both 4-pole and 5-pole connections. The sensor variants with a 4-pole connector are fully compatible with the 5-pole cable.

So despite different pin counts on the pressures switch (Controller Family SCxSD and SCOTC) and sensors, it is always possible to use just one cable version (5-pole) regardless of the plug version.

The SCK-400-xxx-x5 cables fit to all components in this catalogue using M12 connectors.

### Shielding

Shielding protects against interference and ensures improved operational safety.

- Higher EMC protection

## Pin assignment

### SCK-400-xx-x5

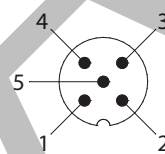

PIN			
1	bn	brown	braun
2	wh	white	weiß
3	bu	blue	blau
4	bk	black	schwarz
5	gy	grey	grau

### SCK-400-xx-56

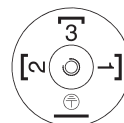

PIN			
1	ye	yellow	gelb
2	gn	green	grün
3	bn	brown	braun

# SCK cable

## Connection cable

SCK-400-xx-45

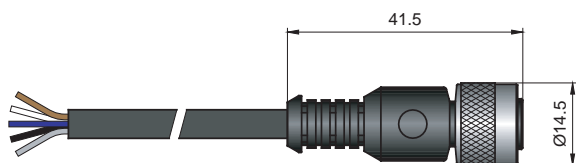

SCK-400-xx-55

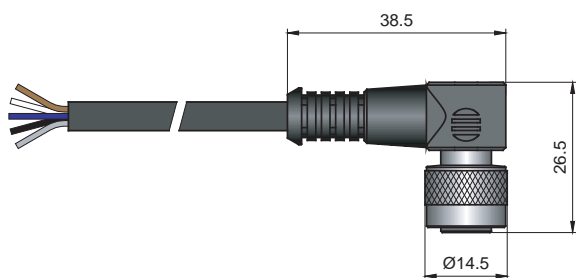

SCK-400-xx-56

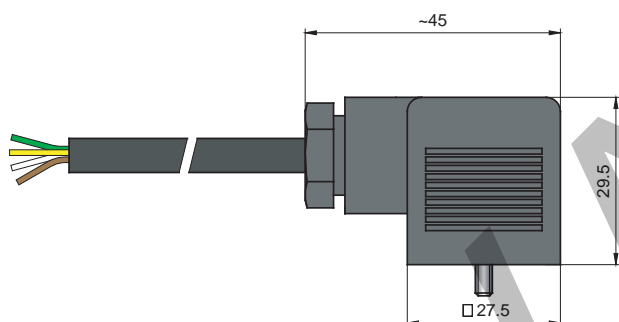

## Single connector

SCK-145

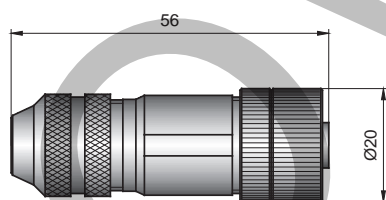

SCK-155

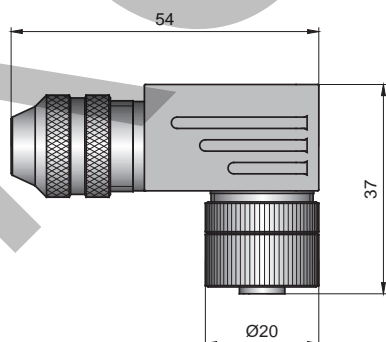

## Single connector

SCK-006 (Device plug)

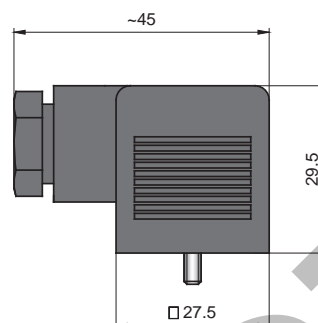

## Connection cable and single plug

### Connection cable, assembled

(open cable end)

#### Cable length (m)

2 m	02
5 m	05
10 m	10

#### Connecting plug

M12 cable jack; straight	45
M12 cable jack; 90° angled	55
Cable socket DIN EN 175301-803 Form A (old DIN 43650)	56

### Single connector

M12 cable jack; straight  
M12 cable jack; 90° angled  
Cable socket DIN EN 175301-803 Form A (old DIN 43650)

**SCK-145**  
**SCK-155**  
**SCK-006**