

192YX – Sealing Head (60°) BSP Swivel Nut

YX Series

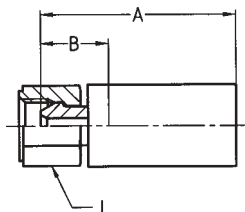

Part No. #	DN size mm inch				Connection Type Thread Size	A mm	B mm	J mm
192YX-4-03	5	-03	4.8	3/16	G 1/4	42	16	17
192YX-4-04	6	-04	6.3	1/4	G 1/4	44	17	17
192YX-6-05	8	-05	7.9	3/16	G 3/8	45	17	19
192YX-6-06	10	-06	9.5	3/8	G 3/8	46	19	22
192YX-8-06	10	-06	9.5	3/8	G 1/2	46	19	27
192YX-8-08	12	-08	12.7	1/2	G 1/2	52	21	27
192YX-12-10	16	-10	15.9	5/8	G 3/4	50	19	32
192YX-12-12	20	-12	19.0	3/4	G 3/4	56	21	32
192YX-16-12	20	-12	19.0	3/4	G 1	56	22	41
192YX-16-16	25	-16	25.4	1	G 1	57	22	41
192YX-20-16	25	-16	25.4	1	G 1 1/4	58	24	50

Material: Steel, surface protection according to DIN 50 961 Fe/Zn, special materials available upon request.
Stainless steel (1.4571) fittings available on request.

1B1YX – Sealing Head (60°) 45° Elbow BSP Swivel Nut

YX Series

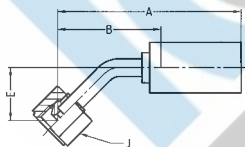

Part No. #	DN size mm inch				Connection Type Thread Size	A mm	B mm	E mm	J mm
1B1YX-4-03	5	-03	4.8	3/16	G 1/4	58	32	17	17
1B1YX-4-04	6	-04	6.4	1/4	G 1/4	69	41	21	17
1B1YX-6-05	8	-05	7.9	5/16	G 3/8	68	39	17	22
1B1YX-6-06	10	-06	9.5	3/8	G 3/8	64	36	14	22
1B1YX-8-06	10	-06	9.5	3/8	G 1/2	65	37	15	27
1B1YX-8-08	12	-08	12.7	1/2	G 1/2	86	54	18	27
1B1YX-12-10	16	-10	15.9	5/8	G 3/4	99	68	26	32
1B1YX-12-12	20	-12	19.0	3/4	G 3/4	117	82	30	32
1B1YX-16-16	25	-16	25.4	1	G 1	120	85	43	41
1B1YX-20-16	25	-16	25.4	1	G 1 1/4	116	81	34	50

Material: Steel, surface protection according to DIN 50 961 Fe/Zn, special materials available upon request.
Stainless steel (1.4571) fittings available on request.