

# LF 3000® Push-In Fittings / Stud Fittings



A range of technical polymer fittings to cover most needs of low pressure pneumatic applications.

Ø metric: 3 to 16 mm  
Ø inch: 1/8" to 1/2"

## Technical Characteristics

- **Compatible Fluids:** Compressed air  
Other fluids: please consult us
- **Working Pressure:** Vacuum to 20 bar
- **Working Temperature:** -20°C to +80°C

| Tightening Torque (daN.m) | Threads |         |       |        |          |      |      |      |      |
|---------------------------|---------|---------|-------|--------|----------|------|------|------|------|
|                           | M3 x0.5 | M5 x0.8 | M7 x1 | M10 x1 | M12 x1.5 | G1/8 | G1/4 | G3/8 | G1/2 |
|                           | 0.06    | 0.16    | 0.8   | 0.8    | 1.1      | 0.8  | 1.2  | 3    | 3.5  |

Reliable performance is dependent upon the type of fluid conveyed, component materials and tubing being used.

Use is guaranteed with a vacuum of 755 mm Hg (99% vacuum).

## Advantages

- Robust, lightweight, compact to build your pneumatic circuits
- Full flow connections to optimize flow rates
- Use in vacuum as well as in compressed air
- Customised products upon request. Please, contact us.

## Component Materials

Silicone-free

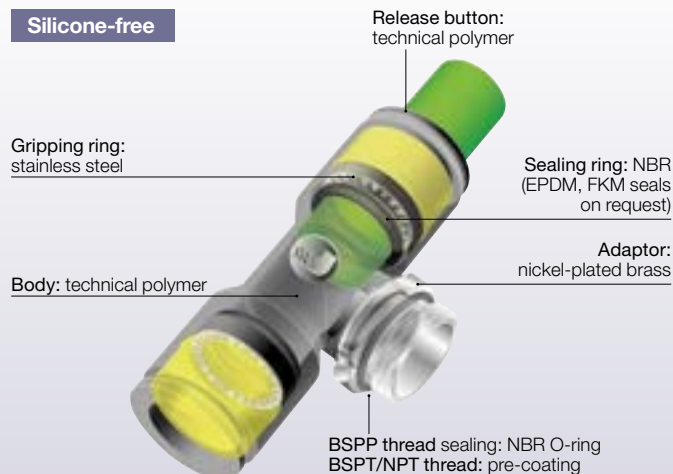

## Regulations

- ISO 14743
- PED
- RoHS
- REACH

## 3175 Stud Fitting, Male BSPT Thread

Nickel-plated brass, NBR

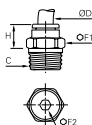

| ØD | C    |                   | F1 | F2 | H    | Kg    |
|----|------|-------------------|----|----|------|-------|
| 4  | R1/8 | <b>3175 04 10</b> | 10 | 3  | 9.5  | 0.005 |
|    | R1/4 | <b>3175 04 13</b> | 14 | 3  | 6.5  | 0.011 |
|    | R3/8 | <b>3175 04 17</b> | 17 | 3  | 8    | 0.024 |
| 6  | R1/8 | <b>3175 06 10</b> | 11 | 4  | 11.5 | 0.005 |
|    | R1/4 | <b>3175 06 13</b> | 14 | 4  | 8.5  | 0.011 |
|    | R3/8 | <b>3175 06 17</b> | 17 | 4  | 8.5  | 0.021 |
| 8  | R1/2 | <b>3175 06 21</b> | 21 | 4  | 9    | 0.043 |
|    | R1/8 | <b>3175 08 10</b> | 13 | 5  | 20   | 0.011 |
|    | R1/4 | <b>3175 08 13</b> | 14 | 6  | 17   | 0.014 |
| 10 | R3/8 | <b>3175 08 17</b> | 17 | 6  | 13   | 0.021 |
|    | R1/2 | <b>3175 08 21</b> | 21 | 6  | 12   | 0.039 |
|    | R1/8 | <b>3175 10 10</b> | 16 | 5  | 22.5 | 0.017 |
| 12 | R1/4 | <b>3175 10 13</b> | 16 | 7  | 20   | 0.017 |
|    | R3/8 | <b>3175 10 17</b> | 17 | 8  | 16.5 | 0.019 |
|    | R1/2 | <b>3175 10 21</b> | 21 | 8  | 14   | 0.036 |
| 14 | R1/4 | <b>3175 12 13</b> | 19 | 7  | 26.5 | 0.029 |
|    | R3/8 | <b>3175 12 17</b> | 19 | 9  | 24   | 0.028 |
|    | R1/2 | <b>3175 12 21</b> | 21 | 10 | 19.5 | 0.036 |
| 16 | R3/8 | <b>3175 14 17</b> | 22 | 9  | 28.5 | 0.044 |
|    | R1/2 | <b>3175 14 21</b> | 24 | 10 | 23.5 | 0.046 |
|    | R3/8 | <b>3175 16 17</b> | 27 | 9  | 32.5 | 0.068 |
|    | R1/2 | <b>3175 16 21</b> | 27 | 12 | 32.5 | 0.079 |

Pre-coated thread

## 3175 Stud Fitting, Male NPT Thread

Nickel-plated brass, NBR

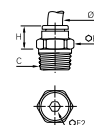

| ØD | C      |                   | F1 | F2 | H    | Kg    |
|----|--------|-------------------|----|----|------|-------|
| 6  | NPT1/8 | <b>3175 06 11</b> | 11 | 4  | 11.5 | 0.006 |
|    | NPT1/4 | <b>3175 06 14</b> | 14 | 4  | 8.5  | 0.012 |
|    | NPT1/4 | <b>3175 10 14</b> | 16 | 7  | 20   | 0.018 |
| 10 | NPT3/8 | <b>3175 10 18</b> | 18 | 8  | 16.5 | 0.023 |
|    | NPT1/2 | <b>3175 10 22</b> | 22 | 8  | 14   | 0.038 |
| 12 | NPT3/8 | <b>3175 12 18</b> | 19 | 9  | 24   | 0.030 |
|    | NPT1/2 | <b>3175 12 22</b> | 22 | 10 | 19.5 | 0.037 |

Pre-coated thread  
5/32" (4 mm) and 5/16" (8 mm) are also available.

## 3175 Stud Fitting, Male NPT Thread

Inch

Nickel-plated brass, NBR

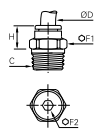

| ØD  | C      |                   | F1 | F2  | H    | Kg    |
|-----|--------|-------------------|----|-----|------|-------|
| 1/8 | NPT1/8 | <b>3175 53 11</b> | 11 | 2   | 7.2  | 0.006 |
|     | NPT1/4 | <b>3175 53 14</b> | 14 | 2   | 8    | 0.015 |
|     | NPT1/8 | <b>3175 56 11</b> | 11 | 4   | 11.9 | 0.007 |
| 1/4 | NPT1/4 | <b>3175 56 14</b> | 14 | 4   | 9.4  | 0.013 |
|     | NPT3/8 | <b>3175 56 18</b> | 18 | 5   | 7.6  | 0.024 |
| 3/8 | NPT1/8 | <b>3175 60 11</b> | 16 | 4   | 22.7 | 0.019 |
|     | NPT1/4 | <b>3175 60 14</b> | 16 | 7   | 20.5 | 0.019 |
|     | NPT3/8 | <b>3175 60 18</b> | 18 | 7   | 17.5 | 0.026 |
| 1/2 | NPT3/8 | <b>3175 62 18</b> | 22 | 9.5 | 25.9 | 0.048 |
|     | NPT1/2 | <b>3175 62 22</b> | 24 | 9.5 | 22.1 | 0.064 |

Pre-coated thread

## 3175 Stud Fitting, Male BSPT Thread

Inch

Nickel-plated brass, NBR

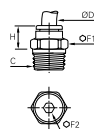

| ØD   | C    |                   | F1   | F2  | H    | Kg    |
|------|------|-------------------|------|-----|------|-------|
| 1/8  | R1/8 | <b>3175 53 10</b> | 11   | 3   | 8.5  | 0.005 |
| 3/16 | R1/8 | <b>3175 55 10</b> | 11.1 | 3.2 | 15.5 | 0.009 |
|      | R1/4 | <b>3175 55 13</b> | 14.3 | 4   | 15   | 0.020 |
| 1/4  | R1/8 | <b>3175 56 10</b> | 11   | 4   | 12   | 0.006 |
|      | R1/4 | <b>3175 56 13</b> | 14   | 4   | 9.5  | 0.021 |
|      | R1/4 | <b>3175 60 13</b> | 16   | 7   | 20.5 | 0.018 |
| 3/8  | R3/8 | <b>3175 60 17</b> | 17   | 7   | 16.5 | 0.019 |
|      | R1/2 | <b>3175 60 21</b> | 21   | 7   | 14   | 0.037 |
|      | R1/4 | <b>3175 62 13</b> | 22   | 6   | 26.9 | 0.044 |
| 1/2  | R3/8 | <b>3175 62 17</b> | 22   | 7   | 25.9 | 0.048 |
|      | R1/2 | <b>3175 62 21</b> | 24   | 7   | 20.5 | 0.049 |

Pre-coated thread

## 3101 Stud Fitting, Male BSPP and Metric Thread

Nickel-plated brass, NBR

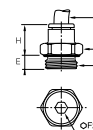

| ØD | C       |                    | E   | F1 | F2  | H    | Kg    |
|----|---------|--------------------|-----|----|-----|------|-------|
| 3  | M3x0.5  | <b>3101 03 09*</b> | 2.5 | 8  |     | 12.5 | 0.003 |
|    | M5x0.8  | <b>3101 03 19</b>  | 3.5 | 8  | 2.5 | 12.5 | 0.004 |
|    | M3x0.5  | <b>3101 04 09*</b> | 2.5 | 8  |     | 14.5 | 0.003 |
| 4  | M5x0.8  | <b>3101 04 19</b>  | 3   | 9  | 2.5 | 14   | 0.004 |
|    | M7x1    | <b>3101 04 55</b>  | 5   | 10 | 2.5 | 14   | 0.004 |
|    | G1/8    | <b>3101 04 10</b>  | 5   | 13 | 3   | 11.5 | 0.007 |
|    | G1/4    | <b>3101 04 13</b>  | 5.5 | 16 | 3   | 10.5 | 0.011 |
|    | M5x0.8  | <b>3101 06 19</b>  | 3.5 | 11 | 2.5 | 16   | 0.005 |
|    | M7x1    | <b>3101 06 55</b>  | 5   | 10 | 3   | 16   | 0.006 |
| 6  | M10x1   | <b>3101 06 60</b>  | 5   | 13 | 4   | 13   | 0.007 |
|    | M12x1.5 | <b>3101 06 67</b>  | 5.5 | 15 | 4   | 13   | 0.009 |
|    | G1/8    | <b>3101 06 10</b>  | 5   | 13 | 4   | 13   | 0.007 |
|    | G1/4    | <b>3101 06 13</b>  | 5.5 | 16 | 4   | 12.5 | 0.011 |
|    | G3/8    | <b>3101 06 17</b>  | 5.5 | 20 | 4   | 13   | 0.020 |
|    | G1/2    | <b>3101 06 21</b>  | 7   | 24 | 4   | 20   | 0.039 |
|    | M10x1   | <b>3101 08 60</b>  | 5   | 13 | 5   | 21   | 0.011 |
|    | M12x1.5 | <b>3101 08 67</b>  | 5.5 | 15 | 5   | 21   | 0.015 |
|    | G1/8    | <b>3101 08 10</b>  | 4.5 | 13 | 5   | 20.5 | 0.011 |
| 8  | G1/4    | <b>3101 08 13</b>  | 5.5 | 16 | 6   | 19.5 | 0.016 |
|    | G3/8    | <b>3101 08 17</b>  | 5.5 | 20 | 6   | 18   | 0.022 |
|    | G1/2    | <b>3101 08 21</b>  | 7   | 24 | 6   | 16.5 | 0.038 |
| 10 | G1/4    | <b>3101 10 13</b>  | 5.5 | 16 | 7   | 23   | 0.018 |
|    | G3/8    | <b>3101 10 17</b>  | 5.5 | 20 | 8   | 19.5 | 0.021 |
|    | G1/2    | <b>3101 10 21</b>  | 7   | 24 | 8   | 18.5 | 0.033 |
| 12 | G1/4    | <b>3101 12 13</b>  | 5.5 | 19 | 7   | 27.5 | 0.027 |
|    | G3/8    | <b>3101 12 17</b>  | 5.5 | 20 | 9   | 27   | 0.028 |
|    | G1/2    | <b>3101 12 21</b>  | 7   | 24 | 11  | 22.5 | 0.035 |
| 14 | G3/8    | <b>3101 14 17</b>  | 5.5 | 22 | 9   | 29.5 | 0.041 |
|    | G1/2    | <b>3101 14 21</b>  | 7   | 24 | 11  | 28   | 0.046 |
|    | G3/8    | <b>3101 16 17</b>  | 7.5 | 27 | 9   | 32.5 | 0.061 |
| 16 | G1/2    | <b>3101 16 21</b>  | 9   | 27 | 12  | 32.5 | 0.068 |

\*Bi-material O ring seal

## 3181 Stud Fitting Round Body, Male Metric Thread

Nickel-plated brass, NBR

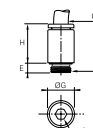

| ØD | C      |                   | E   | F   | G   | H    | Kg    |
|----|--------|-------------------|-----|-----|-----|------|-------|
| 4  | M5x0.8 | <b>3181 04 19</b> | 3.5 | 2.5 | 8.5 | 14.5 | 0.003 |
|    | M7x1   | <b>3181 04 55</b> | 5   | 3   | 10  | 14   | 0.004 |
| 6  | M5x0.8 | <b>3181 06 19</b> | 3.5 | 2.5 | 11  | 16.5 | 0.005 |
|    | M7x1   | <b>3181 06 55</b> | 5   | 3   | 10  | 16   | 0.005 |

The internal hexagon and circular external shape ensure that model 3181 provides highly compact assembly.

They can be easily installed with an Allen key without the need of a spanner.

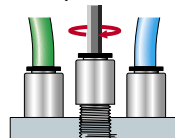

# LF 3000® Push-In Fittings / Stud Fittings

## 3114 Stud Fitting, Female BSPP and Metric Thread

Nickel-plated brass, NBR

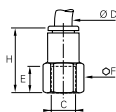

| ØD | C      |                   | E    | F  | H    | Kg    |
|----|--------|-------------------|------|----|------|-------|
| 4  | M5x0.8 | <b>3114 04 19</b> | 6.5  | 8  | 19.5 | 0.005 |
|    | G1/8   | <b>3114 04 10</b> | 9.5  | 13 | 22.5 | 0.010 |
|    | G1/4   | <b>3114 04 13</b> | 13.5 | 16 | 26.5 | 0.015 |
| 6  | G1/8   | <b>3114 06 10</b> | 9.5  | 13 | 24.5 | 0.011 |
|    | G1/4   | <b>3114 06 13</b> | 13.5 | 16 | 28.5 | 0.016 |
|    | G1/8   | <b>3114 08 10</b> | 9.5  | 13 | 29   | 0.015 |
| 8  | G1/4   | <b>3114 08 13</b> | 13.5 | 16 | 33   | 0.021 |
|    | G3/8   | <b>3114 08 17</b> | 14   | 19 | 34   | 0.025 |
|    | G1/4   | <b>3114 10 13</b> | 13.5 | 16 | 36   | 0.028 |
| 10 | G3/8   | <b>3114 10 17</b> | 14   | 19 | 36   | 0.027 |
|    | G1/2   | <b>3114 10 21</b> | 19.5 | 24 | 41.5 | 0.047 |
|    | G3/8   | <b>3114 12 17</b> | 14   | 19 | 40   | 0.033 |
| 12 | G1/2   | <b>3114 12 21</b> | 19.5 | 24 | 45.5 | 0.052 |
|    | G3/8   | <b>3114 14 17</b> | 14   | 22 | 42.5 | 0.057 |
| 16 | G1/2   | <b>3114 16 21</b> | 15   | 27 | 49   | 0.096 |

## 3131 Stud Standpipe, Male BSPP and Metric Thread

Technical polymer, Nickel-plated brass, NBR

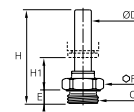

| ØD | C      |                   | E   | F  | H    | H1   | Kg    |
|----|--------|-------------------|-----|----|------|------|-------|
| 4  | M5x0.8 | <b>3131 04 19</b> | 3.5 | 8  | 31   | 16   | 0.002 |
|    | G1/8   | <b>3131 04 10</b> | 5   | 13 | 30   | 13.5 | 0.005 |
|    | G1/4   | <b>3131 04 13</b> | 5.5 | 16 | 31   | 13.5 | 0.010 |
| 6  | G1/8   | <b>3131 06 10</b> | 5   | 13 | 32   | 13.5 | 0.005 |
|    | G1/4   | <b>3131 06 13</b> | 5.5 | 16 | 33   | 13.5 | 0.010 |
|    | G1/8   | <b>3131 08 10</b> | 5   | 13 | 35.5 | 12.5 | 0.008 |
| 8  | G1/4   | <b>3131 08 13</b> | 5.5 | 16 | 34.5 | 10.5 | 0.010 |
|    | G3/8   | <b>3131 08 17</b> | 5.5 | 20 | 34.5 | 10.5 | 0.015 |
|    | G1/4   | <b>3131 10 13</b> | 5.5 | 16 | 43.5 | 17.5 | 0.012 |
| 10 | G3/8   | <b>3131 10 17</b> | 5.5 | 20 | 41.5 | 15.5 | 0.015 |
|    | G1/2   | <b>3131 10 21</b> | 7   | 24 | 41.5 | 15.5 | 0.024 |
|    | G3/8   | <b>3131 12 17</b> | 5.5 | 20 | 42   | 12   | 0.015 |
| 12 | G1/2   | <b>3131 12 21</b> | 7   | 24 | 43.5 | 12   | 0.024 |
|    | G3/8   | <b>3131 14 17</b> | 5.5 | 20 | 46.5 | 14   | 0.016 |
| 14 | G1/2   | <b>3131 14 21</b> | 7   | 24 | 48   | 13.5 | 0.025 |

## 3121 Stud Standpipe, Male BSPT Thread

Technical polymer, Nickel-plated brass

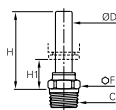

| ØD | C    |                   | F  | H    | H1   | Kg    |
|----|------|-------------------|----|------|------|-------|
| 4  | R1/8 | <b>3121 04 10</b> | 10 | 26   | 14   | 0.005 |
|    | R1/4 | <b>3121 04 13</b> | 14 | 26.5 | 14.5 | 0.014 |
| 6  | R1/8 | <b>3121 06 10</b> | 10 | 28   | 14   | 0.005 |
|    | R1/4 | <b>3121 06 13</b> | 14 | 28.5 | 14.5 | 0.014 |
| 8  | R1/8 | <b>3121 08 10</b> | 10 | 29.5 | 11   | 0.005 |
|    | R1/4 | <b>3121 08 13</b> | 14 | 28.5 | 10   | 0.012 |
| 10 | R1/4 | <b>3121 10 13</b> | 15 | 36   | 15.5 | 0.012 |
|    | R3/8 | <b>3121 10 17</b> | 17 | 36   | 15.5 | 0.017 |
| 12 | R1/2 | <b>3121 10 21</b> | 21 | 36   | 15.5 | 0.032 |
|    | R3/8 | <b>3121 12 17</b> | 17 | 36.5 | 12   | 0.018 |
|    | R1/2 | <b>3121 12 21</b> | 21 | 36.5 | 12   | 0.030 |

Pre-coated thread

## 3109 Stud Elbow, Male BSPT Thread

Technical polymer, Nickel-plated brass, NBR

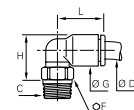

| ØD | C    |                   | F  | G    | H    | L    | Kg    |
|----|------|-------------------|----|------|------|------|-------|
| 4  | R1/8 | <b>3109 04 10</b> | 10 | 8.5  | 13.5 | 14   | 0.006 |
|    | R1/4 | <b>3109 04 13</b> | 14 | 8.5  | 14   | 14   | 0.015 |
|    | R3/8 | <b>3109 04 17</b> | 17 | 8.5  | 13.5 | 14   | 0.019 |
| 6  | R1/8 | <b>3109 06 10</b> | 10 | 10.5 | 15.5 | 16   | 0.006 |
|    | R1/4 | <b>3109 06 13</b> | 14 | 10.5 | 16   | 16   | 0.015 |
|    | R3/8 | <b>3109 06 17</b> | 17 | 10.5 | 16   | 16   | 0.020 |
| 8  | R1/2 | <b>3109 06 21</b> | 21 | 10.5 | 16.5 | 16   | 0.035 |
|    | R1/8 | <b>3109 08 10</b> | 10 | 13.5 | 19   | 23   | 0.007 |
|    | R1/4 | <b>3109 08 13</b> | 14 | 13.5 | 18   | 23   | 0.014 |
| 10 | R3/8 | <b>3109 08 17</b> | 17 | 13.5 | 18   | 23   | 0.018 |
|    | R1/2 | <b>3109 08 21</b> | 21 | 13.5 | 19.5 | 23   | 0.032 |
|    | R1/8 | <b>3109 10 10</b> | 15 | 16   | 23   | 26.5 | 0.012 |
| 12 | R1/4 | <b>3109 10 13</b> | 15 | 16   | 22   | 26.5 | 0.014 |
|    | R3/8 | <b>3109 10 17</b> | 17 | 16   | 22   | 26.5 | 0.020 |
|    | R1/2 | <b>3109 10 21</b> | 21 | 16   | 22   | 26.5 | 0.034 |
| 14 | R1/4 | <b>3109 12 13</b> | 15 | 19   | 25   | 31   | 0.016 |
|    | R3/8 | <b>3109 12 17</b> | 17 | 19   | 25   | 31   | 0.022 |
|    | R1/2 | <b>3109 12 21</b> | 21 | 19   | 25   | 31   | 0.037 |
| 16 | R3/8 | <b>3109 14 17</b> | 20 | 22   | 30.5 | 35.5 | 0.031 |
|    | R1/2 | <b>3109 14 21</b> | 24 | 22   | 28.5 | 35.5 | 0.042 |
|    | R3/8 | <b>3109 16 17</b> | 27 | 27   | 53   | 39   | 0.106 |
|    | R1/2 | <b>3109 16 21</b> | 27 | 27   | 53   | 39   | 0.104 |

Pre-coated thread  
The body swivels for positioning purposes.

## 3109 Stud Elbow, Male NPT Thread

Technical polymer, Nickel-plated brass, NBR

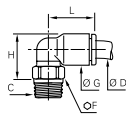

| ØD | C      |                   | F  | G    | H    | L    | Kg    |
|----|--------|-------------------|----|------|------|------|-------|
| 4  | NPT1/8 | <b>3109 04 11</b> | 11 | 8.4  | 13.5 | 14   | 0.007 |
|    | NPT1/4 | <b>3109 04 14</b> | 14 | 8.4  | 14   | 14   | 0.016 |
| 6  | NPT1/8 | <b>3109 06 11</b> | 11 | 10.5 | 15.5 | 16   | 0.007 |
|    | NPT1/4 | <b>3109 06 14</b> | 14 | 10.5 | 16   | 16   | 0.016 |
| 8  | NPT1/8 | <b>3109 08 11</b> | 11 | 13.5 | 19   | 23.1 | 0.009 |
|    | NPT1/4 | <b>3109 08 14</b> | 14 | 13.5 | 18   | 23.1 | 0.015 |
|    | NPT1/4 | <b>3109 10 14</b> | 15 | 16   | 23   | 26.5 | 0.017 |
| 10 | NPT3/8 | <b>3109 10 18</b> | 18 | 16   | 22   | 26.5 | 0.023 |
|    | NPT1/2 | <b>3109 10 22</b> | 22 | 16   | 23   | 26.5 | 0.046 |
| 12 | NPT1/2 | <b>3109 12 22</b> | 22 | 19   | 26   | 31   | 0.048 |

Pre-coated thread  
The body swivels for positioning purposes.

## 3109 Stud Elbow, Male NPT Thread

Inch

Technical polymer, Nickel-plated brass, NBR

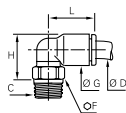

| ØD  | C      |                   | F  | G    | H    | L    | Kg    |
|-----|--------|-------------------|----|------|------|------|-------|
| 1/8 | NPT1/8 | <b>3109 53 11</b> | 11 | 8.6  | 13.5 | 14.5 | 0.007 |
|     | NPT1/4 | <b>3109 53 14</b> | 14 | 8.6  | 14   | 14.5 | 0.015 |
| 1/4 | NPT1/8 | <b>3109 56 11</b> | 11 | 11   | 17   | 18   | 0.008 |
|     | NPT1/4 | <b>3109 56 14</b> | 14 | 11   | 16   | 18   | 0.014 |
|     | NPT3/8 | <b>3109 56 18</b> | 18 | 11   | 16.5 | 18   | 0.021 |
| 3/8 | NPT1/8 | <b>3109 60 11</b> | 15 | 16   | 23.1 | 27.4 | 0.014 |
|     | NPT1/4 | <b>3109 60 14</b> | 15 | 16   | 23.1 | 27.4 | 0.017 |
|     | NPT3/8 | <b>3109 60 18</b> | 18 | 16   | 22.1 | 27.4 | 0.024 |
| 1/2 | NPT3/8 | <b>3109 62 18</b> | 20 | 22.1 | 31   | 35.1 | 0.033 |
|     | NPT1/2 | <b>3109 62 22</b> | 24 | 22.1 | 28.4 | 35.1 | 0.045 |

Pre-coated thread  
The body swivels for positioning purposes.  
5/32"(4 mm) and 5/16"(8 mm) are also available.

## 3109 Stud Elbow, Male BSPT Thread

Inch

Technical polymer, Nickel-plated brass, NBR

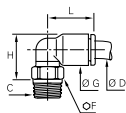

| ØD  | C    |                   | F  | G    | H    | L    | Kg    |
|-----|------|-------------------|----|------|------|------|-------|
| 1/8 | R1/8 | <b>3109 53 10</b> | 10 | 8.6  | 13.5 | 14.5 | 0.011 |
| 1/4 | R1/8 | <b>3109 56 10</b> | 10 | 11   | 17   | 18   | 0.006 |
|     | R1/4 | <b>3109 56 13</b> | 14 | 11   | 17   | 18   | 0.013 |
| 3/8 | R1/4 | <b>3109 60 13</b> | 15 | 16   | 22.1 | 26.4 | 0.016 |
|     | R3/8 | <b>3109 60 17</b> | 17 | 16   | 22.1 | 26.4 | 0.054 |
| 1/2 | R1/4 | <b>3109 62 13</b> | 20 | 22.1 | 31   | 35.1 | 0.064 |
|     | R3/8 | <b>3109 62 17</b> | 20 | 22.1 | 31   | 35.1 | 0.067 |
|     | R1/2 | <b>3109 62 21</b> | 24 | 22.1 | 28.4 | 35.1 | 0.046 |

Pre-coated thread  
The body swivels for positioning purposes.  
5/32"(4 mm) and 5/16"(8 mm) are also available.

## 3199 Stud Elbow, Male BSPP and Metric Thread

Technical polymer, Nickel-plated brass, NBR

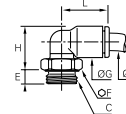

| ØD | C       |                    | E   | F  | G    | H    | L    | Kg    |
|----|---------|--------------------|-----|----|------|------|------|-------|
| 3  | M3x0.5  | <b>3199 03 09*</b> | 2.5 | 8  | 8.5  | 15   | 14.5 | 0.003 |
|    | M5x0.8  | <b>3199 03 19</b>  | 3.5 | 8  | 8.5  | 13.5 | 14.5 | 0.003 |
| 4  | M3x0.5  | <b>3199 04 09*</b> | 2.5 | 8  | 8.5  | 15   | 14.5 | 0.003 |
|    | M5x0.8  | <b>3199 04 19</b>  | 3.5 | 8  | 8.5  | 13.5 | 14   | 0.002 |
|    | M7x1    | <b>3199 04 55</b>  | 4.5 | 10 | 8.5  | 15   | 14   | 0.005 |
|    | G1/8    | <b>3199 04 10</b>  | 5   | 13 | 8.5  | 13   | 14   | 0.006 |
|    | G1/4    | <b>3199 04 13</b>  | 5.5 | 16 | 8.5  | 13   | 14   | 0.011 |
| 6  | M5x0.8  | <b>3199 06 19</b>  | 3.5 | 8  | 10.5 | 15.5 | 16   | 0.003 |
|    | M7x1    | <b>3199 06 55</b>  | 4.5 | 10 | 10.5 | 17.5 | 16   | 0.006 |
|    | M10x1   | <b>3199 06 60</b>  | 5   | 13 | 10.5 | 15   | 14   | 0.006 |
|    | M12x1.5 | <b>3199 06 67</b>  | 5.5 | 15 | 10.5 | 15   | 16   | 0.009 |
|    | G1/8    | <b>3199 06 10</b>  | 5   | 13 | 10.5 | 15   | 16   | 0.006 |
|    | G1/4    | <b>3199 06 13</b>  | 5.5 | 16 | 10.5 | 15   | 16   | 0.011 |
|    | G3/8    | <b>3199 06 17</b>  | 5.5 | 20 | 10.5 | 15.5 | 16   | 0.022 |
| 8  | G1/2    | <b>3199 06 21</b>  | 7   | 24 | 10.5 | 16   | 16   | 0.027 |
|    | M10x1   | <b>3199 08 60</b>  | 5   | 13 | 13.5 | 20.5 | 23   | 0.009 |
|    | M12x1.5 | <b>3199 08 67</b>  | 5.5 | 15 | 13.5 | 18   | 23   | 0.009 |
|    | G1/8    | <b>3199 08 10</b>  | 4.5 | 13 | 13.5 | 20.5 | 23   | 0.009 |
|    | G1/4    | <b>3199 08 13</b>  | 5.5 | 16 | 13.5 | 18.5 | 23   | 0.012 |
|    | G3/8    | <b>3199 08 17</b>  | 5.5 | 20 | 13.5 | 18.5 | 23   | 0.017 |
|    | G1/2    | <b>3199 08 21</b>  | 7   | 24 | 13.5 | 19   | 23   | 0.027 |
| 10 | G1/4    | <b>3199 10 13</b>  | 5.5 | 16 | 16   | 23.5 | 26.5 | 0.014 |
|    | G3/8    | <b>3199 10 17</b>  | 5.5 | 20 | 16   | 22   | 26.5 | 0.017 |
|    | G1/2    | <b>3199 10 21</b>  | 7   | 24 | 16   | 22   | 26.5 | 0.026 |
| 12 | G1/4    | <b>3199 12 13</b>  | 5.5 | 16 | 19   | 26.5 | 31   | 0.016 |
|    | G3/8    | <b>3199 12 17</b>  | 5.5 | 20 | 19   | 25   | 31   | 0.019 |
| 14 | G1/2    | <b>3199 12 21</b>  | 7   | 24 | 19   | 25   | 31   | 0.029 |
|    | G3/8    | <b>3199 14 17</b>  | 5.5 | 20 | 22   | 32.5 | 35.5 | 0.029 |
| 16 | G1/2    | <b>3199 14 21</b>  | 7   | 24 | 22   | 27   | 35.5 | 0.028 |
|    | G3/8    | <b>3199 16 17</b>  | 7.5 | 27 | 27   | 54.5 | 39   | 0.101 |
|    | G1/2    | <b>3199 16 21</b>  | 9   | 27 | 27   | 54.5 | 39   | 0.097 |

The body swivels for positioning purposes.  
\*Bi-material seal

# LF 3000® Push-In Fittings / Stud Fittings

## 3192 Stud Elbow, Female BSPP Thread

Technical polymer, Nickel-plated brass, NBR

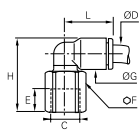

| ØD | C    |                   | E    | F  | G    | H    | L    | Kg    |
|----|------|-------------------|------|----|------|------|------|-------|
| 4  | G1/8 | <b>3192 04 10</b> | 8.5  | 13 | 8.5  | 23   | 14   | 0.010 |
|    | G1/4 | <b>3192 04 13</b> | 11.5 | 16 | 8.5  | 27   | 14   | 0.016 |
| 6  | G1/8 | <b>3192 06 10</b> | 8.5  | 13 | 10.5 | 25   | 16   | 0.010 |
|    | G1/4 | <b>3192 06 13</b> | 11.5 | 16 | 10.5 | 29   | 16   | 0.017 |
| 8  | G1/8 | <b>3192 08 10</b> | 8.5  | 13 | 13.5 | 28   | 23   | 0.012 |
|    | G1/4 | <b>3192 08 13</b> | 11.5 | 16 | 13.5 | 32   | 23   | 0.020 |
| 10 | G3/8 | <b>3192 10 17</b> | 12   | 19 | 16   | 35   | 26.5 | 0.025 |
|    | G1/2 | <b>3192 10 21</b> | 16   | 24 | 16   | 41   | 26.5 | 0.048 |
| 12 | G1/4 | <b>3192 12 13</b> | 11   | 16 | 19   | 38   | 30.5 | 0.022 |
|    | G3/8 | <b>3192 12 17</b> | 12   | 19 | 19   | 38.5 | 30.5 | 0.027 |
|    | G1/2 | <b>3192 12 21</b> | 16   | 24 | 19   | 43.5 | 30.5 | 0.050 |

The body swivels for positioning purposes.

## 3169 Extended Stud Elbow, Male BSPP and Metric Thread

Technical polymer, Nickel-plated brass, NBR

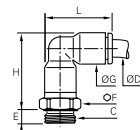

| ØD | C      |                   | E   | F  | G    | H    | L    | Kg    |
|----|--------|-------------------|-----|----|------|------|------|-------|
| 4  | M5x0.8 | <b>3169 04 19</b> | 3.5 | 8  | 8.5  | 23   | 19   | 0.006 |
|    | G1/8   | <b>3169 04 10</b> | 5   | 13 | 8.5  | 22.5 | 19   | 0.008 |
| 6  | G1/4   | <b>3169 04 13</b> | 5.5 | 16 | 8.5  | 22.5 | 19   | 0.014 |
|    | M5x0.8 | <b>3169 06 19</b> | 3.5 | 10 | 10.5 | 27.5 | 23   | 0.008 |
| 8  | M7x1   | <b>3169 06 55</b> | 4.5 | 10 | 10.5 | 26   | 23   | 0.012 |
|    | G1/8   | <b>3169 06 10</b> | 5   | 13 | 10.5 | 27   | 23   | 0.011 |
| 10 | G1/4   | <b>3169 06 13</b> | 5.5 | 16 | 10.5 | 27   | 23   | 0.016 |
|    | G1/8   | <b>3169 08 10</b> | 5   | 13 | 13.5 | 36   | 29.5 | 0.018 |
| 12 | G1/4   | <b>3169 08 13</b> | 5.5 | 16 | 13.5 | 33   | 29.5 | 0.021 |
|    | G3/8   | <b>3169 08 17</b> | 5.5 | 20 | 13.5 | 33   | 29.5 | 0.028 |
| 14 | G1/4   | <b>3169 10 13</b> | 5.5 | 16 | 16   | 40.5 | 34.5 | 0.028 |
|    | G3/8   | <b>3169 10 17</b> | 5.5 | 20 | 16   | 40.5 | 34.5 | 0.036 |
| 16 | G1/2   | <b>3169 10 21</b> | 7   | 24 | 16   | 40.5 | 34.5 | 0.049 |
|    | G1/4   | <b>3169 12 13</b> | 5.5 | 19 | 19   | 44.5 | 40.5 | 0.044 |
| 18 | G3/8   | <b>3169 12 17</b> | 5.5 | 20 | 19   | 42   | 40.5 | 0.038 |
|    | G1/2   | <b>3169 12 21</b> | 7   | 24 | 19   | 42   | 40.5 | 0.043 |
| 20 | G3/8   | <b>3169 14 17</b> | 5.5 | 22 | 22   | 51   | 46.5 | 0.059 |
|    | G1/2   | <b>3169 14 21</b> | 7   | 24 | 22   | 48.5 | 46.5 | 0.063 |
| 22 | G3/8   | <b>3169 16 17</b> | 7.5 | 27 | 27   | 82.5 | 52   | 0.220 |
|    | G1/2   | <b>3169 16 21</b> | 9   | 27 | 27   | 82.5 | 52   | 0.206 |

The body swivels for positioning purposes.

## 3129 Extended Stud Elbow, Male BSPT Thread

Technical polymer, Nickel-plated brass, NBR

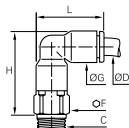

| ØD | C    |                   | F  | G    | H    | L    | Kg    |
|----|------|-------------------|----|------|------|------|-------|
| 4  | R1/8 | <b>3129 04 10</b> | 10 | 8.5  | 23   | 19   | 0.008 |
|    | R1/4 | <b>3129 04 13</b> | 14 | 8.5  | 23.5 | 19   | 0.018 |
| 6  | R1/8 | <b>3129 06 10</b> | 10 | 10.5 | 27   | 22.5 | 0.010 |
|    | R1/4 | <b>3129 06 13</b> | 14 | 10.5 | 27.5 | 22.5 | 0.020 |
| 8  | R1/8 | <b>3129 08 10</b> | 13 | 13.5 | 34.5 | 29.5 | 0.018 |
|    | R1/4 | <b>3129 08 13</b> | 14 | 13.5 | 32.5 | 29.5 | 0.022 |
| 10 | R3/8 | <b>3129 08 17</b> | 17 | 13.5 | 33   | 29.5 | 0.032 |
|    | R1/4 | <b>3129 10 13</b> | 15 | 16   | 39.5 | 34.5 | 0.031 |
| 12 | R3/8 | <b>3129 10 17</b> | 17 | 16   | 39.5 | 34.5 | 0.042 |
|    | R1/2 | <b>3129 10 21</b> | 21 | 16   | 39.5 | 34.5 | 0.058 |
| 14 | R1/4 | <b>3129 12 13</b> | 19 | 19   | 45.5 | 40.5 | 0.051 |
|    | R3/8 | <b>3129 12 17</b> | 19 | 19   | 45.5 | 40.5 | 0.047 |
| 16 | R1/2 | <b>3129 12 21</b> | 21 | 19   | 45.5 | 40.5 | 0.053 |
|    | R3/8 | <b>3129 14 17</b> | 21 | 22   | 51.5 | 46.5 | 0.065 |
|    | R1/2 | <b>3129 14 21</b> | 21 | 22   | 51.5 | 46.5 | 0.071 |

Pre-coated thread

The body swivels for positioning purposes.

## 3113 45° Elbow, Male BSPT Thread

Technical polymer, Nickel-plated brass, NBR

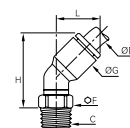

| ØD | C    |                   | F  | G    | H    | L    | Kg    |
|----|------|-------------------|----|------|------|------|-------|
| 4  | R1/8 | <b>3113 04 10</b> | 10 | 9    | 21   | 13   | 0.006 |
|    | R1/8 | <b>3113 06 10</b> | 10 | 11   | 24.5 | 14.5 | 0.006 |
| 6  | R1/4 | <b>3113 06 13</b> | 14 | 11   | 25   | 14.5 | 0.015 |
|    | R1/8 | <b>3113 08 10</b> | 10 | 13.5 | 30   | 19.5 | 0.007 |
| 8  | R1/4 | <b>3113 08 13</b> | 14 | 13.5 | 28.5 | 19.5 | 0.014 |
|    | R3/8 | <b>3113 08 17</b> | 17 | 13.5 | 28.5 | 19.5 | 0.018 |
| 10 | R1/4 | <b>3113 10 13</b> | 15 | 16   | 33.5 | 23   | 0.014 |
|    | R3/8 | <b>3113 10 17</b> | 17 | 16   | 33.5 | 23   | 0.020 |
| 12 | R1/2 | <b>3113 10 21</b> | 21 | 16   | 34   | 23   | 0.032 |
|    | R1/4 | <b>3113 12 13</b> | 15 | 19   | 39   | 26   | 0.016 |
| 14 | R3/8 | <b>3113 12 17</b> | 17 | 19   | 39   | 26   | 0.022 |
|    | R1/2 | <b>3113 12 21</b> | 21 | 19   | 39   | 26   | 0.034 |

Pre-coated thread

The body swivels for positioning purposes.

This model prevents distortion of the tube.

## 3133 45° Elbow, Male BSPP and Metric Thread

Technical polymer, Nickel-plated brass, NBR

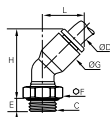

| ØD | C      |                   | E   | F  | G    | H    | L    | Kg    |
|----|--------|-------------------|-----|----|------|------|------|-------|
| 4  | M5x0.8 | <b>3133 04 19</b> | 3.5 | 8  | 9    | 23   | 13   | 0.003 |
|    | G1/8   | <b>3133 04 10</b> | 4.5 | 13 | 9    | 20.5 | 13   | 0.006 |
| 6  | M5x0.8 | <b>3133 06 19</b> | 3.5 | 8  | 11   | 28   | 14.5 | 0.003 |
|    | G1/8   | <b>3133 06 10</b> | 4.5 | 13 | 11   | 24   | 14.5 | 0.006 |
| 8  | G1/4   | <b>3133 06 13</b> | 5.5 | 16 | 11   | 24   | 14.5 | 0.011 |
|    | G1/8   | <b>3133 08 10</b> | 4.5 | 13 | 13.5 | 31   | 19.5 | 0.009 |
| 10 | G1/4   | <b>3133 08 13</b> | 5.5 | 16 | 13.5 | 29   | 19.5 | 0.012 |
|    | G3/8   | <b>3133 08 17</b> | 5.5 | 20 | 13.5 | 29   | 19.5 | 0.017 |
| 12 | G1/4   | <b>3133 10 13</b> | 5.5 | 16 | 16   | 35   | 23   | 0.014 |
|    | G3/8   | <b>3133 10 17</b> | 5.5 | 20 | 16   | 33.5 | 23   | 0.017 |
| 16 | G1/2   | <b>3133 10 21</b> | 7   | 24 | 16   | 33.5 | 23   | 0.026 |
|    | G1/4   | <b>3133 12 13</b> | 5.5 | 16 | 19   | 40.5 | 26   | 0.016 |
| 20 | G3/8   | <b>3133 12 17</b> | 5.5 | 20 | 19   | 39   | 26   | 0.019 |
|    | G1/2   | <b>3133 12 21</b> | 7   | 24 | 19   | 39   | 26   | 0.029 |

The body swivels for positioning purposes.  
This model prevents distortion of the tube.

## 3198 Stud Branch Tee, Male BSPP and Metric Thread

Technical polymer, Nickel-plated brass, NBR

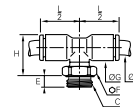

| ØD | C      |                   | E   | F  | G    | H    | L/2  | Kg    |
|----|--------|-------------------|-----|----|------|------|------|-------|
| 4  | M5x0.8 | <b>3198 04 19</b> | 3.5 | 8  | 8.5  | 17.5 | 14   | 0.003 |
|    | G1/8   | <b>3198 04 10</b> | 5   | 13 | 8.5  | 15   | 14   | 0.006 |
| 6  | G1/4   | <b>3198 04 13</b> | 5.5 | 16 | 8.5  | 15   | 14   | 0.011 |
|    | M5x0.8 | <b>3198 06 19</b> | 3.5 | 8  | 10.5 | 19.5 | 16   | 0.004 |
| 8  | G1/8   | <b>3198 06 10</b> | 5   | 13 | 10.5 | 17   | 16   | 0.007 |
|    | G1/4   | <b>3198 06 13</b> | 5.5 | 16 | 10.5 | 17   | 16   | 0.012 |
| 10 | G1/8   | <b>3198 08 10</b> | 4.5 | 13 | 13.5 | 23.5 | 23   | 0.011 |
|    | G1/4   | <b>3198 08 13</b> | 5.5 | 16 | 13.5 | 21.5 | 23   | 0.014 |
| 12 | G3/8   | <b>3198 08 17</b> | 5.5 | 20 | 13.5 | 21.5 | 23   | 0.019 |
|    | G1/4   | <b>3198 10 13</b> | 5.5 | 16 | 16   | 26   | 26.5 | 0.017 |
| 16 | G3/8   | <b>3198 10 17</b> | 5.5 | 20 | 16   | 24   | 26.5 | 0.020 |
|    | G1/2   | <b>3198 10 21</b> | 7   | 24 | 16   | 24   | 26.5 | 0.029 |
| 20 | G1/4   | <b>3198 12 13</b> | 5.5 | 16 | 19   | 29   | 31   | 0.021 |
|    | G3/8   | <b>3198 12 17</b> | 5.5 | 20 | 19   | 27   | 31   | 0.024 |
| 24 | G1/2   | <b>3198 12 21</b> | 7   | 24 | 19   | 27   | 31   | 0.033 |
|    | G3/8   | <b>3198 14 17</b> | 5.5 | 20 | 22   | 32.5 | 35.5 | 0.036 |
| 32 | G1/2   | <b>3198 14 21</b> | 7   | 24 | 22   | 27   | 35.5 | 0.036 |
|    | G3/8   | <b>3198 16 17</b> | 7.5 | 27 | 27   | 54.5 | 38.5 | 0.121 |
| 40 | G1/2   | <b>3198 16 21</b> | 9   | 27 | 27   | 54.5 | 38.5 | 0.117 |

The body swivels for positioning purposes.

## 3108 Stud Branch Tee, Male BSPT Thread

Technical polymer, Nickel-plated brass, NBR

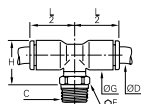

| ØD | C    |                   | F  | G    | H    | L/2  | Kg    |
|----|------|-------------------|----|------|------|------|-------|
| 4  | R1/8 | <b>3108 04 10</b> | 10 | 8.5  | 15.5 | 14   | 0.006 |
|    | R1/4 | <b>3108 04 13</b> | 14 | 8.5  | 16   | 14   | 0.015 |
| 6  | R1/8 | <b>3108 06 10</b> | 10 | 10.5 | 17.5 | 16   | 0.007 |
|    | R1/4 | <b>3108 06 13</b> | 14 | 10.5 | 18   | 16   | 0.016 |
| 8  | R1/8 | <b>3108 08 10</b> | 10 | 13.5 | 22   | 23   | 0.009 |
|    | R1/4 | <b>3108 08 13</b> | 14 | 13.5 | 21   | 23   | 0.016 |
| 10 | R3/8 | <b>3108 08 17</b> | 17 | 13.5 | 21   | 23   | 0.020 |
|    | R1/4 | <b>3108 10 13</b> | 15 | 16   | 24   | 26.5 | 0.017 |
| 12 | R3/8 | <b>3108 10 17</b> | 17 | 16   | 24   | 26.5 | 0.022 |
|    | R1/2 | <b>3108 10 21</b> | 21 | 16   | 24   | 26.5 | 0.034 |
| 16 | R1/4 | <b>3108 12 13</b> | 15 | 19   | 27   | 31   | 0.021 |
|    | R3/8 | <b>3108 12 17</b> | 17 | 19   | 27   | 31   | 0.027 |
| 20 | R1/2 | <b>3108 12 21</b> | 21 | 19   | 27   | 31   | 0.041 |
|    | R3/8 | <b>3108 14 17</b> | 20 | 22   | 30.5 | 35   | 0.038 |
| 24 | R1/2 | <b>3108 14 21</b> | 24 | 22   | 28.5 | 35   | 0.049 |
|    | R3/8 | <b>3108 16 17</b> | 27 | 27   | 53   | 38.5 | 0.128 |
| 32 | R1/2 | <b>3108 16 21</b> | 27 | 27   | 53   | 38.5 | 0.124 |

Pre-coated thread  
The body swivels for positioning purposes.

## 3103 Stud Run Tee, BSPT Thread

Technical polymer, Nickel-plated brass, NBR

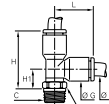

| ØD | C    |                   | F  | G    | H    | H1   | L    | Kg    |
|----|------|-------------------|----|------|------|------|------|-------|
| 4  | R1/8 | <b>3103 04 10</b> | 10 | 8.5  | 23.5 | 9    | 14.5 | 0.006 |
|    | R1/4 | <b>3103 04 13</b> | 14 | 8.5  | 24   | 9.5  | 14.5 | 0.015 |
| 6  | R1/8 | <b>3103 06 10</b> | 10 | 10.5 | 27.5 | 10   | 17.5 | 0.007 |
|    | R1/4 | <b>3103 06 13</b> | 14 | 10.5 | 28   | 10.5 | 17.5 | 0.016 |
| 8  | R1/8 | <b>3103 08 10</b> | 10 | 13.5 | 35   | 12   | 23   | 0.009 |
|    | R1/4 | <b>3103 08 13</b> | 14 | 13.5 | 34   | 11   | 23   | 0.015 |
| 10 | R3/8 | <b>3103 08 17</b> | 17 | 13.5 | 34   | 11   | 23   | 0.020 |
|    | R1/4 | <b>3103 10 13</b> | 15 | 16   | 40.5 | 14   | 26.5 | 0.017 |
| 12 | R3/8 | <b>3103 10 17</b> | 17 | 16   | 40.5 | 14   | 26.5 | 0.022 |
|    | R1/2 | <b>3103 10 21</b> | 21 | 16   | 40.5 | 14   | 26.5 | 0.035 |
| 16 | R1/4 | <b>3103 12 13</b> | 15 | 19   | 46.5 | 15.5 | 31   | 0.021 |
|    | R3/8 | <b>3103 12 17</b> | 17 | 19   | 46.5 | 15.5 | 31   | 0.026 |
| 20 | R1/2 | <b>3103 12 21</b> | 21 | 19   | 46.5 | 15.5 | 31   | 0.041 |
|    | R3/8 | <b>3103 14 21</b> | 24 | 22   | 52.5 | 17.5 | 35.5 | 0.049 |
| 24 | R3/8 | <b>3103 16 17</b> | 27 | 27   | 78   | 27   | 38.5 | 0.126 |
|    | R1/2 | <b>3103 16 21</b> | 27 | 27   | 78   | 27   | 38.5 | 0.124 |

Pre-coated thread  
The body swivels for positioning purposes.

# LF 3000® Push-In Fittings / Stud Fittings

## 3193 Stud Run Tee, Male BSPP and Metric Thread

Technical polymer, Nickel-plated brass, NBR

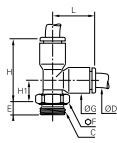

| ØD | C      |                   | E   | F  | G    | H    | H1   | L    | Kg    |
|----|--------|-------------------|-----|----|------|------|------|------|-------|
| 4  | M5x0.8 | <b>3193 04 19</b> | 3.5 | 8  | 8.5  | 26   | 11.5 | 14.5 | 0.003 |
|    | G1/8   | <b>3193 04 10</b> | 5   | 13 | 8.5  | 23   | 8.5  | 14.5 | 0.006 |
|    | G1/4   | <b>3193 04 13</b> | 5.5 | 16 | 8.5  | 23   | 8.5  | 14.5 | 0.011 |
|    | M5x0.8 | <b>3193 06 19</b> | 3.5 | 8  | 10.5 | 29.5 | 12.5 | 17.5 | 0.004 |
| 6  | G1/8   | <b>3193 06 10</b> | 5   | 13 | 10.5 | 27   | 10   | 17.5 | 0.007 |
|    | G1/4   | <b>3193 06 13</b> | 5.5 | 16 | 10.5 | 27   | 10   | 17.5 | 0.012 |
|    | G1/8   | <b>3193 08 10</b> | 4.5 | 13 | 13.5 | 36.5 | 14   | 23   | 0.011 |
| 8  | G1/4   | <b>3193 08 13</b> | 5.5 | 16 | 13.5 | 34.5 | 12   | 23   | 0.014 |
|    | G3/8   | <b>3193 08 17</b> | 5.5 | 20 | 13.5 | 34.5 | 12   | 23   | 0.019 |
| 10 | G1/4   | <b>3193 10 13</b> | 5.5 | 16 | 16   | 42   | 15.5 | 26.5 | 0.017 |
|    | G3/8   | <b>3193 10 17</b> | 5.5 | 20 | 16   | 40.5 | 14   | 26.5 | 0.020 |
|    | G1/2   | <b>3193 10 21</b> | 7   | 24 | 16   | 40.5 | 14   | 26.5 | 0.029 |
|    | G1/4   | <b>3193 12 13</b> | 5.5 | 16 | 19   | 48   | 17   | 31   | 0.021 |
| 12 | G3/8   | <b>3193 12 17</b> | 5.5 | 20 | 19   | 46.5 | 15.5 | 31   | 0.024 |
|    | G1/2   | <b>3193 12 21</b> | 7   | 24 | 19   | 46.5 | 15.5 | 31   | 0.033 |
| 14 | G3/8   | <b>3193 14 17</b> | 5.5 | 20 | 22   | 56.5 | 21.5 | 35.5 | 0.036 |
|    | G1/2   | <b>3193 14 21</b> | 7   | 24 | 22   | 51   | 16   | 35.5 | 0.036 |
| 16 | G3/8   | <b>3193 16 17</b> | 7.5 | 27 | 27   | 79.5 | 41   | 38.5 | 0.121 |
|    | G1/2   | <b>3193 16 21</b> | 9   | 27 | 27   | 79.5 | 41   | 38.5 | 0.117 |

The body swivels for positioning purposes.

## 3158 Y Piece, Male BSPP and Metric Thread

Technical polymer, Nickel-plated brass, NBR

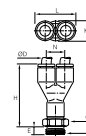

| ØD | C      |                   | E   | F  | H    | K    | L    | N    | Kg    |
|----|--------|-------------------|-----|----|------|------|------|------|-------|
| 4  | M5x0.8 | <b>3158 04 19</b> | 3.5 | 8  | 32.5 | 8.5  | 17.5 | 9    | 0.006 |
|    | M5x0.8 | <b>3158 06 19</b> | 3.5 | 10 | 39.5 | 10.5 | 21.5 | 11   | 0.009 |
| 6  | G1/8   | <b>3158 06 10</b> | 5   | 13 | 39   | 10.5 | 21.5 | 11   | 0.012 |
|    | G1/4   | <b>3158 06 13</b> | 5.5 | 16 | 39.5 | 10.5 | 21.5 | 11   | 0.017 |
|    | G1/8   | <b>3158 08 10</b> | 5   | 13 | 49   | 13.5 | 28   | 14.5 | 0.020 |
| 8  | G1/4   | <b>3158 08 13</b> | 5.5 | 16 | 49.5 | 13.5 | 28   | 14.5 | 0.023 |
|    | G3/8   | <b>3158 08 17</b> | 6   | 19 | 48   | 13.5 | 28   | 14.5 | 0.031 |
| 10 | G1/4   | <b>3158 10 13</b> | 5.5 | 16 | 58   | 16   | 33   | 17   | 0.032 |
|    | G3/8   | <b>3158 10 17</b> | 6   | 20 | 57.5 | 16   | 33   | 17   | 0.040 |
| 12 | G1/2   | <b>3158 10 21</b> | 7   | 24 | 58   | 16   | 33   | 17   | 0.054 |
|    | G3/8   | <b>3158 12 17</b> | 6   | 20 | 62   | 19   | 39   | 20   | 0.044 |
| 12 | G1/2   | <b>3158 12 21</b> | 7   | 24 | 63   | 19   | 39   | 20   | 0.050 |

The body swivels for positioning purposes.

## 3132 Double Y, Male BSPP Thread

Technical polymer, Nickel-plated brass, NBR

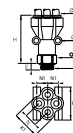

| ØD | C    |                   | E   | F  | H    | K    | K1   | N  | N1  | ØT  | Kg    |
|----|------|-------------------|-----|----|------|------|------|----|-----|-----|-------|
| 4  | G1/8 | <b>3132 04 10</b> | 5   | 13 | 41   | 25.5 | 21   | 10 | 8.5 | 3.7 | 0.022 |
|    | G1/4 | <b>3132 04 13</b> | 5.5 | 16 | 40   | 25.5 | 21   | 10 | 8.5 | 3.7 | 0.026 |
| 6  | G1/8 | <b>3132 06 10</b> | 5   | 19 | 53.5 | 31.5 | 26.5 | 12 | 10  | 3.7 | 0.041 |
|    | G1/4 | <b>3132 06 13</b> | 5.5 | 19 | 52.5 | 31.5 | 26.5 | 12 | 10  | 3.7 | 0.042 |

The body swivels for positioning purposes.

## 3148 Y Piece, Male BSPT Thread

Technical polymer, Nickel-plated brass, NBR

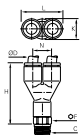

| ØD | C    |                   | F  | H    | K    | L    | N    | Kg    |
|----|------|-------------------|----|------|------|------|------|-------|
| 4  | R1/8 | <b>3148 04 10</b> | 10 | 32.5 | 8.5  | 17.5 | 9    | 0.009 |
|    | R1/4 | <b>3148 04 13</b> | 14 | 33   | 8.5  | 17.5 | 9    | 0.018 |
| 6  | R1/8 | <b>3148 06 10</b> | 10 | 39.5 | 10.5 | 21.5 | 11   | 0.012 |
|    | R1/4 | <b>3148 06 13</b> | 14 | 40   | 10.5 | 21.5 | 11   | 0.021 |
| 8  | R1/8 | <b>3148 08 10</b> | 13 | 56.5 | 13.5 | 28   | 14.5 | 0.020 |
|    | R1/4 | <b>3148 08 13</b> | 14 | 55.5 | 13.5 | 28   | 14.5 | 0.025 |
| 10 | R3/8 | <b>3148 08 17</b> | 16 | 48.5 | 13.5 | 28   | 14.5 | 0.034 |
|    | R1/4 | <b>3148 10 13</b> | 14 | 60   | 19   | 39   | 20   | 0.033 |
| 12 | R3/8 | <b>3148 10 17</b> | 16 | 60.5 | 19   | 39   | 20   | 0.043 |
|    | R1/2 | <b>3148 10 21</b> | 24 | 61   | 19   | 39   | 20   | 0.062 |
| 12 | R3/8 | <b>3148 12 17</b> | 19 | 66   | 19   | 39   | 20   | 0.054 |
|    | R1/2 | <b>3148 12 21</b> | 21 | 66   | 19   | 39   | 20   | 0.059 |

Pre-coated thread

The body swivels for positioning purposes.

# LF 3000® Push-In Fittings / Stud Fittings

## 3100 Carstick® Cartridge

Brass, NBR

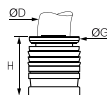

| ØD |                   | G    | G1   | H    | L    | Kg    |
|----|-------------------|------|------|------|------|-------|
| 4  | <b>3100 04 00</b> | 8    | 11   | 10   | 554  | 0.007 |
| 6  | <b>3100 06 00</b> | 10   | 14.5 | 11.5 | 629  | 0.002 |
| 8  | <b>3100 08 00</b> | 13   | 15   | 15   | 794  | 0.002 |
| 10 | <b>3100 10 00</b> | 15.5 | 19.5 | 17   | 930  | 0.005 |
| 12 | <b>3100 12 00</b> | 19.5 | 21   | 19.5 | 1038 | 0.010 |
| 14 | <b>3100 14 00</b> | 21   | 24.5 | 22.5 | 1110 | 0.013 |

50 cartridges per Carstick®.

Cavity dimensions are available upon request

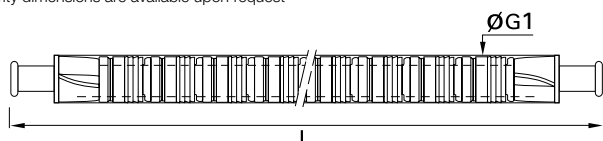

## 3100 Carstick® Cartridge

Inch

Nickel-plated brass, NBR

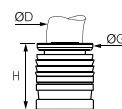

| ØD   |                      | G    | G1   | H    | L   | Kg    |
|------|----------------------|------|------|------|-----|-------|
| 1/8  | <b>3100 53 00 99</b> | 7    | 10   | 9    | 508 | 0.002 |
| 5/32 | <b>3100 04 00 99</b> | 8    | 11   | 10   | 554 | 0.007 |
| 1/4  | <b>3100 56 00 99</b> | 10.5 | 14.5 | 12   | 600 | 0.003 |
| 5/16 | <b>3100 08 00 99</b> | 13   | 15   | 15   | 794 | 0.002 |
| 3/8  | <b>3100 60 00 99</b> | 15.5 | 19   | 16.5 | 930 | 0.006 |

50 cartridges per Carstick®.

(4 mm) and 5/16" (8 mm) also available.

Cavity dimensions are available upon request



## Cavity Dimensions

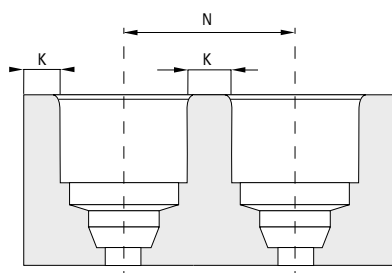
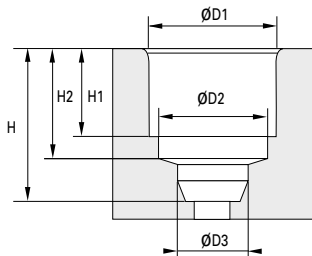

### Carstick® Metric

| Cavity | ØD3   | H    | H1   | H2    |
|--------|-------|------|------|-------|
| 4      | 4.1   | 10   | 6    | 8.15  |
| 6      | 6.1   | 12   | 7.5  | 9.65  |
| 8      | 8.15  | 15.5 | 9.9  | 12.45 |
| 10     | 10.25 | 19   | 11.7 | 14.35 |
| 12     | 12.17 | 22   | 13.9 | 16.75 |

### Carstick®

Inch

| Cavity | ØD3  | H    | H1   | H2    |
|--------|------|------|------|-------|
| 1/8    | 3.25 | 9.5  | 5.3  | 7.45  |
| 5/32*  | 4.1  | 10   | 6    | 8.15  |
| 1/4    | 6.45 | 12.5 | 8    | 10.15 |
| 5/16*  | 8.15 | 15.5 | 9.9  | 12.45 |
| 3/8    | 9.65 | 19   | 11.7 | 14.35 |

### Polyamide Cavity

| Cavity | ØD1   | ØD2   | N    | K   |
|--------|-------|-------|------|-----|
| 4      | 8.25  | 7.05  | 9.8  | 1.5 |
| 6      | 10.2  | 9.15  | 12.2 | 2   |
| 8      | 12.15 | 10.85 | 14.2 | 2   |
| 10     | 14.8  | 13.2  | 16.8 | 2   |
| 12     | 17.5  | 15.5  | 20   | 2.5 |

| Cavity | ØD1   | ØD2   | N    | K   |
|--------|-------|-------|------|-----|
| 1/8    | 7.05  | 6.02  | 8.6  | 1.5 |
| 5/32*  | 8.25  | 7.05  | 9.75 | 1.5 |
| 1/4    | 10.55 | 9.35  | 12.6 | 2   |
| 5/16*  | 12.15 | 10.85 | 14.2 | 2   |
| 3/8    | 14.8  | 13.1  | 16.8 | 2   |

### Aluminium Cavity

| Cavity | ØD1   | ØD2   | N    | K   |
|--------|-------|-------|------|-----|
| 4      | 8.25  | 7.5   | 11.5 | 3   |
| 6      | 10.3  | 9.15  | 13.5 | 3   |
| 8      | 12.2  | 10.85 | 15.2 | 3   |
| 10     | 15.05 | 13.2  | 17.1 | 2   |
| 12     | 17.5  | 15.5  | 20   | 2.5 |

| Cavity | ØD1   | ØD2   | N     | K   |
|--------|-------|-------|-------|-----|
| 1/8    | 7.1   | 6.2   | 8.6   | 1.5 |
| 5/32*  | 8.25  | 7.05  | 11.25 | 3   |
| 1/4    | 10.6  | 9.35  | 12.65 | 2   |
| 5/16*  | 12.2  | 10.85 | 15.2  | 3   |
| 3/8    | 15.05 | 13.1  | 17.1  | 2   |

### Brass Cavity

| Cavity | ØD1   | ØD2   | N     | K   |
|--------|-------|-------|-------|-----|
| 4      | 8.25  | 7.05  | 10.25 | 2   |
| 6      | 10.25 | 9.1   | 12.25 | 2   |
| 8      | 12.2  | 10.85 | 14.25 | 2   |
| 10     | 15.05 | 13.2  | 17.1  | 2   |
| 12     | 17.65 | 15.5  | 20    | 2.5 |

| Cavity | ØD1   | ØD2   | N     | K   |
|--------|-------|-------|-------|-----|
| 1/8    | 7.1   | 6.2   | 8.6   | 1.5 |
| 5/32*  | 8.25  | 7.05  | 10.25 | 2   |
| 1/4    | 10.6  | 9.35  | 12.65 | 2   |
| 5/16*  | 12.2  | 10.85 | 14.25 | 2   |
| 3/8    | 15.05 | 13.1  | 17.1  | 2   |

\*5/32" = 4 mm and 5/16" = 8 mm

Please consult us for detailed drawings of cavity dimensions and tolerances.

All our dimensions are in millimeters.

# LF 3000® Push-In Fittings / Tube-to-Tube Fittings

## 3106 Equal and Unequal Tube-to-Tube Connector

Technical polymer, NBR

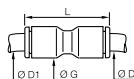

| ØD | ØD1 |                   | G    | L    | Kg    |
|----|-----|-------------------|------|------|-------|
| 3  | 3   | <b>3106 03 00</b> | 8.5  | 25   | 0.002 |
|    | 4   | <b>3106 03 04</b> | 8.5  | 25   | 0.002 |
|    | 1/4 | <b>3106 04 56</b> | 11   | 29.5 | 0.005 |
| 4  | 4   | <b>3106 04 00</b> | 8.5  | 25   | 0.001 |
|    | 6   | <b>3106 04 06</b> | 11   | 28   | 0.002 |
|    | 8   | <b>3106 04 08</b> | 13.5 | 38   | 0.005 |
| 6  | 1/4 | <b>3106 06 56</b> | 13.5 | 36   | 0.009 |
|    | 6   | <b>3106 06 00</b> | 10.5 | 28.5 | 0.002 |
|    | 8   | <b>3106 06 08</b> | 13.5 | 38   | 0.005 |
| 8  | 10  | <b>3106 06 10</b> | 16   | 42   | 0.008 |
|    | 8   | <b>3106 08 00</b> | 13.5 | 38   | 0.004 |
|    | 10  | <b>3106 08 10</b> | 16   | 42   | 0.007 |
| 10 | 12  | <b>3106 08 12</b> | 19   | 50.5 | 0.026 |
|    | 10  | <b>3106 10 00</b> | 16   | 42   | 0.005 |
|    | 12  | <b>3106 10 12</b> | 19   | 50.5 | 0.018 |
| 12 | 1/2 | <b>3106 12 62</b> | 22   | 56.5 | 0.041 |
|    | 12  | <b>3106 12 00</b> | 19   | 50.5 | 0.009 |
|    | 14  | <b>3106 12 14</b> | 22   | 56   | 0.025 |
| 14 | 16  | <b>3106 12 16</b> | 27   | 61   | 0.066 |
|    | 14  | <b>3106 14 00</b> | 22   | 56   | 0.014 |
| 16 | 16  | <b>3106 16 00</b> | 27   | 60.5 | 0.041 |

## 3106 Equal and Unequal Tube-to-Tube Connector Inch

Technical polymer, NBR

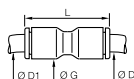

| ØD  | ØD1 |                   | G  | L    | Kg    |
|-----|-----|-------------------|----|------|-------|
| 1/4 | 1/4 | <b>3106 56 00</b> | 11 | 29.5 | 0.002 |
|     | 3/8 | <b>3106 60 00</b> | 16 | 42   | 0.006 |
| 3/8 | 10  | <b>3106 60 10</b> | 12 | 50.5 | 0.028 |
|     | 1/4 | <b>3106 60 56</b> | 16 | 41   | 0.016 |
| 1/2 | 1/2 | <b>3106 62 00</b> | 22 | 55   | 0.016 |

5/32"(4 mm) and 5/16"(8 mm) also available

## 3102 Equal and Unequal Elbow

Technical polymer, NBR

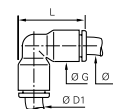

| ØD | ØD1 |                   | G    | L    | Kg    |
|----|-----|-------------------|------|------|-------|
| 4  | 4   | <b>3102 04 00</b> | 8.5  | 19   | 0.001 |
|    | 6   | <b>3102 04 06</b> | 10.5 | 22.5 | 0.003 |
| 6  | 6   | <b>3102 06 00</b> | 10.5 | 22.5 | 0.002 |
|    | 8   | <b>3102 06 08</b> | 13.5 | 29.5 | 0.008 |
| 8  | 8   | <b>3102 08 00</b> | 13.5 | 29.5 | 0.004 |
|    | 10  | <b>3102 08 10</b> | 16   | 34.5 | 0.011 |
| 10 | 10  | <b>3102 10 00</b> | 16   | 34.5 | 0.006 |
|    | 12  | <b>3102 10 12</b> | 19   | 40.5 | 0.019 |
| 12 | 12  | <b>3102 12 00</b> | 19   | 40.5 | 0.010 |
| 14 | 14  | <b>3102 14 00</b> | 22   | 46.5 | 0.015 |
| 16 | 16  | <b>3102 16 00</b> | 27   | 52   | 0.043 |

## 3102 Equal and Unequal Elbow Inch

Technical polymer, NBR

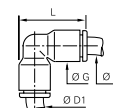

| ØD  | ØD1 |                   | G  | L   | Kg    |
|-----|-----|-------------------|----|-----|-------|
| 1/4 | 1/4 | <b>3102 56 00</b> | 11 | 2.5 | 0.002 |
| 3/8 | 3/8 | <b>3102 60 00</b> | 16 | 34  | 0.006 |
| 1/2 | 1/2 | <b>3102 62 00</b> | 22 | 35  | 0.017 |

5/32"(4 mm) and 5/16"(8 mm) also available

## 3104 Equal and Unequal Tee

Technical polymer, NBR

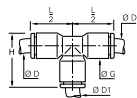

| ØD | ØD1 |                   | G    | H    | L/2  | Kg    |
|----|-----|-------------------|------|------|------|-------|
| 3  | 3   | <b>3104 03 00</b> | 8.5  | 19   | 14.5 | 0.004 |
| 4  | 4   | <b>3104 04 00</b> | 8.5  | 19   | 14.5 | 0.002 |
|    | 6   | <b>3104 04 06</b> | 10.5 | 22.5 | 17.5 | 0.007 |
| 6  | 4   | <b>3104 06 04</b> | 10.5 | 22.5 | 17.5 | 0.005 |
|    | 6   | <b>3104 06 00</b> | 10.5 | 22.5 | 17.5 | 0.003 |
| 8  | 8   | <b>3104 06 08</b> | 13.5 | 29.5 | 23   | 0.015 |
|    | 4   | <b>3104 08 04</b> | 13.5 | 29   | 17.5 | 0.013 |
| 8  | 6   | <b>3104 08 06</b> | 13.5 | 29.5 | 23   | 0.010 |
|    | 8   | <b>3104 08 00</b> | 13.5 | 29.5 | 23   | 0.006 |
| 10 | 10  | <b>3104 08 10</b> | 16   | 34.5 | 26.5 | 0.020 |
|    | 4   | <b>3104 10 04</b> | 16   | 33   | 26   | 0.023 |
| 10 | 8   | <b>3104 10 08</b> | 16   | 34.5 | 26.5 | 0.014 |
|    | 10  | <b>3104 10 00</b> | 16   | 34.5 | 26.5 | 0.009 |
| 12 | 12  | <b>3104 10 12</b> | 19   | 40.5 | 31   | 0.033 |
|    | 4   | <b>3104 12 04</b> | 19   | 39   | 31   | 0.040 |
| 12 | 10  | <b>3104 12 10</b> | 19   | 40.5 | 31   | 0.023 |
|    | 12  | <b>3104 12 00</b> | 19   | 40.5 | 31   | 0.014 |
| 14 | 8   | <b>3104 14 08</b> | 22   | 46   | 35.5 | 0.054 |
|    | 14  | <b>3104 14 00</b> | 22   | 46   | 35.5 | 0.022 |
| 16 | 12  | <b>3104 16 12</b> | 27   | 52.5 | 39   | 0.088 |
|    | 16  | <b>3104 16 00</b> | 27   | 52   | 39   | 0.063 |

## 3104 Equal and Unequal Tee

Inch

Technical polymer, NBR

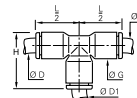

| ØD   | ØD1  |                   | G    | H    | L/2  | Kg    |
|------|------|-------------------|------|------|------|-------|
| 5/32 | 1/4  | <b>3104 04 56</b> | 11   | 23.5 | 18   | 0.008 |
| 1/8  | 1/8  | <b>3104 53 00</b> | 8.4  | 19   | 14.5 | 0.003 |
|      | 1/4  | <b>3104 53 56</b> | 11   | 23.5 | 18   | 0.011 |
| 3/16 | 3/16 | <b>3104 55 00</b> | 11   | 27.2 | 21.6 | 0.016 |
|      | 5/32 | <b>3104 56 04</b> | 11   | 23.5 | 18.5 | 0.014 |
| 1/4  | 1/4  | <b>3104 56 00</b> | 11   | 23   | 24   | 0.003 |
|      | 1/8  | <b>3104 56 53</b> | 11   | 23.5 | 18.5 | 0.007 |
| 3/8  | 3/8  | <b>3104 56 60</b> | 16   | 33.5 | 24.5 | 0.017 |
|      | 1/4  | <b>3104 60 56</b> | 16   | 32.5 | 25.5 | 0.019 |
| 3/8  | 3/8  | <b>3104 60 00</b> | 16   | 34   | 26   | 0.009 |
|      | 1/2  | <b>3104 62 00</b> | 22   | 46   | 35   | 0.026 |
| 1/2  | 1/4  | <b>3104 62 56</b> | 22.1 | 45.2 | 35.3 | 0.059 |
|      | 3/8  | <b>3104 62 60</b> | 22   | 46   | 35   | 0.047 |

5/32"(4 mm) and 5/16"(8 mm) also available

## 3140 Equal and Unequal Single Y Piece

Technical polymer, NBR

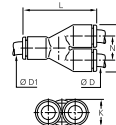

| ØD | ØD1 |                   | H    | K    | L    | N    | Kg    |
|----|-----|-------------------|------|------|------|------|-------|
| 4  | 4   | <b>3140 04 00</b> | 17.5 | 8.5  | 28.5 | 9    | 0.002 |
|    | 6   | <b>3140 04 06</b> | 17.5 | 10.5 | 33   | 9    | 0.002 |
| 6  | 6   | <b>3140 06 00</b> | 21.5 | 10.5 | 35   | 11   | 0.004 |
|    | 8   | <b>3140 06 08</b> | 22.5 | 13.5 | 41   | 11.5 | 0.005 |
| 8  | 8   | <b>3140 08 00</b> | 28   | 13.5 | 45   | 14.5 | 0.006 |
|    | 10  | <b>3140 08 10</b> | 28   | 16   | 47   | 14.5 | 0.008 |
| 10 | 10  | <b>3140 10 00</b> | 33   | 16   | 53   | 17   | 0.010 |
|    | 12  | <b>3140 10 12</b> | 33   | 19   | 57   | 17   | 0.012 |
| 12 | 12  | <b>3140 12 00</b> | 39   | 19   | 57   | 20   | 0.017 |

## 3107 Equal and Unequal Cross

Technical polymer, NBR

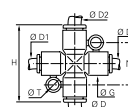

| ØD | ØD1 | ØD2 |                   | G    | H  | N    | ØT  | Kg    |
|----|-----|-----|-------------------|------|----|------|-----|-------|
| 4  | 4   | 4   | <b>3107 04 00</b> | 11   | 36 | 20   | 4.2 | 0.014 |
| 6  | 4   | 6   | <b>3107 04 06</b> | 11   | 36 | 20   | 4.2 | 0.009 |
| 4  | 4   | 6   | <b>3107 06 04</b> | 11   | 36 | 20   | 4.2 | 0.011 |
| 6  | 6   | 6   | <b>3107 06 00</b> | 11   | 36 | 20   | 4.2 | 0.005 |
| 8  | 6   | 8   | <b>3107 06 08</b> | 11   | 46 | 22.5 | 4.2 | 0.018 |
| 6  | 6   | 8   | <b>3107 08 06</b> | 13.5 | 46 | 22.5 | 4.2 | 0.022 |
| 8  | 8   | 8   | <b>3107 08 00</b> | 13.5 | 46 | 22.5 | 4.2 | 0.009 |

# LF 3000® Push-In Fittings / Bulkhead Connector Fittings

## 3116 Equal Bulkhead Connector

Technical polymer, NBR

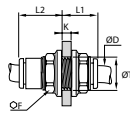

| ØD |                   | F  | K max | L1   | L2   | ØT min | Kg    |
|----|-------------------|----|-------|------|------|--------|-------|
| 4  | <b>3116 04 00</b> | 13 | 5.5   | 15   | 10   | 10.5   | 0.003 |
| 6  | <b>3116 06 00</b> | 15 | 8     | 19   | 11.5 | 12.5   | 0.004 |
| 8  | <b>3116 08 00</b> | 18 | 14.5  | 25   | 13.5 | 15.5   | 0.007 |
| 10 | <b>3116 10 00</b> | 22 | 14.5  | 27.5 | 15.5 | 18.5   | 0.011 |
| 12 | <b>3116 12 00</b> | 26 | 18.5  | 33   | 18   | 22.5   | 0.019 |
| 14 | <b>3116 14 00</b> | 29 | 20.5  | 37.5 | 20.5 | 25.5   | 0.028 |

## 3136 Bulkhead Connector, Female BSPP Thread

Nickel-plated brass, NBR

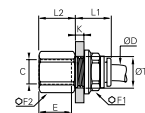

| ØD | C                      | E    | F1 | F2 | K max | L1   | L2   | ØT min | Kg    |
|----|------------------------|------|----|----|-------|------|------|--------|-------|
| 4  | G1/8 <b>3136 04 10</b> | 9.5  | 13 | 13 | 7     | 17   | 11.5 | 10.5   | 0.015 |
|    | G1/4 <b>3136 04 13</b> | 13.5 | 13 | 16 | 7     | 17   | 15.5 | 10.5   | 0.021 |
| 6  | G1/8 <b>3136 06 10</b> | 9.5  | 15 | 15 | 8     | 19   | 10.5 | 12.5   | 0.021 |
|    | G1/4 <b>3136 06 13</b> | 13.5 | 15 | 17 | 7     | 19   | 15.5 | 12.5   | 0.027 |
| 8  | G3/8 <b>3136 06 17</b> | 12   | 15 | 22 | 8     | 19   | 16   | 12.5   | 0.041 |
|    | G1/8 <b>3136 08 10</b> | 9.5  | 18 | 17 | 8     | 20.5 | 10.5 | 15.5   | 0.029 |
| 10 | G1/4 <b>3136 08 13</b> | 13.5 | 18 | 17 | 8     | 20.5 | 14.5 | 15.5   | 0.029 |
|    | G3/8 <b>3136 10 17</b> | 14   | 22 | 22 | 8.5   | 23   | 16   | 18.5   | 0.050 |
| 12 | G3/8 <b>3136 12 17</b> | 14   | 26 | 24 | 8.5   | 27   | 16   | 22.5   | 0.079 |
|    | G1/2 <b>3136 12 21</b> | 19.5 | 26 | 27 | 8.5   | 27   | 21.5 | 22.5   | 0.098 |
| 16 | G3/8 <b>3136 16 17</b> | 12   | 29 | 29 | 10.5  | 30   | 15   | 27.5   | 0.125 |
|    | G1/2 <b>3136 16 21</b> | 15   | 29 | 29 | 10.5  | 30   | 19.5 | 27.5   | 0.126 |

## 3146 Equal Mixed Bulkhead Connector

Nickel-plated brass, NBR

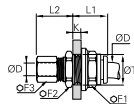

| ØD |                   | F1 | F2 | F3 | K max | L1   | L2   | ØT min | Kg    |
|----|-------------------|----|----|----|-------|------|------|--------|-------|
| 4  | <b>3146 04 00</b> | 13 | 13 | 10 | 7     | 17.5 | 17.5 | 10.5   | 0.018 |
| 6  | <b>3146 06 00</b> | 15 | 17 | 13 | 8     | 19   | 18   | 12.5   | 0.028 |
| 8  | <b>3146 08 00</b> | 18 | 19 | 14 | 8     | 20.5 | 20.5 | 15.5   | 0.036 |
| 10 | <b>3146 10 00</b> | 22 | 22 | 19 | 8.5   | 23   | 24.5 | 18.5   | 0.062 |
| 12 | <b>3146 12 00</b> | 26 | 25 | 22 | 8.5   | 27   | 25   | 22.5   | 0.095 |
| 14 | <b>3146 14 00</b> | 29 | 29 | 24 | 10.5  | 27   | 27   | 25.5   | 0.124 |

Push-in connection with compression fitting

## 3139 Equal Bulkhead Elbow

Technical polymer, Nickel-plated brass, NBR

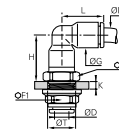

| ØD |                   | F  | F1 | G    | H    | K max | L    | ØT min | Kg    |
|----|-------------------|----|----|------|------|-------|------|--------|-------|
| 4  | <b>3139 04 00</b> | 13 | 13 | 8.5  | 17   | 6.5   | 14.5 | 10.5   | 0.014 |
| 6  | <b>3139 06 00</b> | 17 | 15 | 10.5 | 19.5 | 7     | 17.5 | 12.5   | 0.021 |
| 8  | <b>3139 08 00</b> | 19 | 18 | 13.5 | 24   | 8     | 23   | 15.5   | 0.032 |
| 10 | <b>3139 10 00</b> | 22 | 22 | 16   | 28   | 8.5   | 26   | 18.5   | 0.048 |
| 12 | <b>3139 12 00</b> | 24 | 26 | 19   | 33   | 8.5   | 31   | 22.5   | 0.084 |
| 14 | <b>3139 14 00</b> | 27 | 29 | 25.5 | 37.5 | 10.5  | 36   | 25.5   | 0.117 |

The body swivels for positioning purposes.

Boxes protect the contents and are designed to meet your requirements:

- part numbers and corresponding product pictures allow for immediate visual identification
- bar codes
- easy storage
- tamper-proof system of opening/closing
- recyclable material



## 3144 Equal and Unequal Multiple Y Piece

Technical polymer, NBR

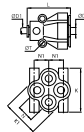

| ØD | ØD1 |                   | K    | K1   | L    | N  | N1  | ØT  | Kg    |
|----|-----|-------------------|------|------|------|----|-----|-----|-------|
| 4  | 4   | <b>3144 04 04</b> | 25.5 | 21   | 30.5 | 10 | 8.5 | 3.7 | 0.015 |
|    | 6   | <b>3144 04 06</b> | 25.5 | 21   | 30.5 | 10 | 8.5 | 3.7 | 0.013 |
| 6  | 6   | <b>3144 06 06</b> | 31.5 | 26.5 | 37.5 | 12 | 10  | 3.7 | 0.032 |
|    | 8   | <b>3144 06 08</b> | 31.5 | 26.5 | 38   | 12 | 10  | 3.7 | 0.026 |

## 3304 Multiple Tee

Technical polymer, NBR

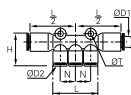

| ØD1 | ØD2 |                   | H    | L  | L/2  | N    | ØT  | Kg    |
|-----|-----|-------------------|------|----|------|------|-----|-------|
| 6   | 4   | <b>3304 06 04</b> | 24.5 | 34 | 37   | 11.5 | 4.2 | 0.015 |
| 8   | 4   | <b>3304 08 04</b> | 24.5 | 34 | 37   | 11.5 | 4.2 | 0.012 |
|     | 6   | <b>3304 08 06</b> | 24.5 | 34 | 37   | 11.5 | 4.2 | 0.010 |
| 10  | 6   | <b>3304 10 06</b> | 36   | 44 | 40.5 | 14.5 | 4.2 | 0.019 |
|     | 8   | <b>3304 10 08</b> | 36   | 44 | 40.5 | 15.5 | 4.2 | 0.015 |

## 3306 90° Multiple Elbow

Technical polymer, NBR

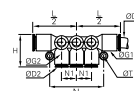

| ØD1 | ØD2 |                   | G    | G1   | H    | L/2  | N  | N1   | ØT  | Kg    |
|-----|-----|-------------------|------|------|------|------|----|------|-----|-------|
| 6   | 4   | <b>3306 06 04</b> | 13.5 | 11   | 18.5 | 36   | 43 | 11.5 | 4.2 | 0.034 |
| 8   | 4   | <b>3306 08 04</b> | 13.5 | 11   | 18.5 | 36.5 | 43 | 11.5 | 4.2 | 0.025 |
|     | 6   | <b>3306 08 06</b> | 13.5 | 11   | 18.5 | 36.5 | 43 | 11.5 | 4.2 | 0.022 |
| 10  | 6   | <b>3306 10 06</b> | 16   | 13.5 | 23   | 42   | 52 | 14.5 | 4.2 | 0.048 |
|     | 8   | <b>3306 10 08</b> | 16   | 13.5 | 23.5 | 42   | 52 | 14.5 | 4.2 | 0.021 |

## 3310 In-Line Manifold

Treated aluminium, NBR

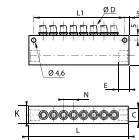

| ØD | C    |                   | Number of Outlets | E  | H  | K  | L     | L1    | N    | Kg    |
|----|------|-------------------|-------------------|----|----|----|-------|-------|------|-------|
| 4  | G1/4 | <b>3310 04 13</b> | 8                 | 10 | 33 | 20 | 114   | 104   | 11.5 | 0.164 |
| 6  | G1/4 | <b>3310 06 13</b> | 8                 | 10 | 33 | 20 | 114   | 104   | 12.5 | 0.160 |
| 8  | G3/8 | <b>3310 08 17</b> | 6                 | 12 | 33 | 20 | 114   | 104   | 15   | 0.149 |
| 10 | G1/2 | <b>3310 10 21</b> | 6                 | 16 | 48 | 25 | 145.5 | 135.5 | 17   | 0.329 |
| 12 | G1/2 | <b>3310 12 21</b> | 4                 | 16 | 45 | 25 | 158   | 148   | 20.5 | 0.354 |

Parker Legris offers the solution to enable many types of configuration options.

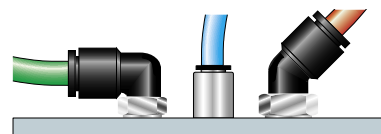

## 3182 Equal and Unequal Plug-In Elbow

Technical polymer, NBR

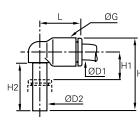

| ØD1 | ØD2 |                   | G    | H    | H1   | H2   | L    | Kg    |
|-----|-----|-------------------|------|------|------|------|------|-------|
| 4   | 4   | <b>3182 04 00</b> | 8.5  | 23   | 6    | 15.5 | 14   | 0.005 |
| 4   | 6   | <b>3182 04 06</b> | 10.5 | 26.5 | 7    | 17   | 16   | 0.004 |
| 6   | 4   | <b>3182 06 04</b> | 10.5 | 24.5 | 7    | 15.5 | 16   | 0.001 |
| 6   | 6   | <b>3182 06 00</b> | 10.5 | 26.5 | 7    | 17   | 16   | 0.001 |
| 8   | 8   | <b>3182 06 08</b> | 13.5 | 33.5 | 8    | 21.5 | 23   | 0.007 |
| 8   | 8   | <b>3182 08 00</b> | 13.5 | 33.5 | 8    | 21.5 | 23   | 0.003 |
| 10  | 10  | <b>3182 08 10</b> | 16   | 39   | 10   | 24.5 | 26.5 | 0.010 |
| 10  | 10  | <b>3182 10 00</b> | 16   | 39   | 10   | 24.5 | 26.5 | 0.004 |
| 12  | 12  | <b>3182 10 12</b> | 19   | 44.5 | 10.5 | 27.5 | 31   | 0.016 |
| 12  | 12  | <b>3182 12 00</b> | 19   | 45.5 | 10.5 | 27.5 | 31   | 0.007 |

The references in diameter 4mm and 12mm are not grooved in standard version

## 3180 45° Plug-In Equal Elbow

Technical polymer, NBR

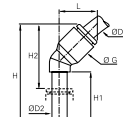

| ØD1 | ØD2 |                   | G    | H    | H1   | H2   | L    | Kg    |
|-----|-----|-------------------|------|------|------|------|------|-------|
| 4   | 4   | <b>3180 04 00</b> | 9    | 33.5 | 19   | 21   | 13   | 0.001 |
| 6   | 6   | <b>3180 06 00</b> | 11   | 39   | 21   | 25   | 14.5 | 0.002 |
| 8   | 8   | <b>3180 08 00</b> | 13.5 | 44   | 21.5 | 25.5 | 19.5 | 0.003 |
| 10  | 10  | <b>3180 10 00</b> | 16   | 53   | 27   | 32.5 | 23   | 0.004 |
| 12  | 12  | <b>3180 12 00</b> | 19   | 58.5 | 27.5 | 34   | 26.5 | 0.007 |

## 3182 Equal Plug-In Elbow

Inch

Technical polymer, NBR

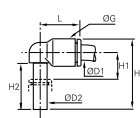

| ØD1 | ØD2 |                   | G  | H    | H1  | H2 | L    | Kg    |
|-----|-----|-------------------|----|------|-----|----|------|-------|
| 1/4 | 1/4 | <b>3182 56 00</b> | 11 | 27.5 | 7.5 | 18 | 18.5 | 0.002 |
| 3/8 | 3/8 | <b>3182 60 00</b> | 16 | 38.5 | 9   | 24 | 26   | 0.010 |

5/32"(4 mm) and 5/16"(8 mm) also available

## 3183 Equal and Unequal Plug-In Run Tee

Technical polymer, NBR

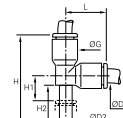

| ØD1 | ØD2 |                   | G    | H    | H1   | H2   | L    | Kg    |
|-----|-----|-------------------|------|------|------|------|------|-------|
| 4   | 4   | <b>3183 04 00</b> | 8.5  | 33   | 6    | 15.5 | 14.5 | 0.002 |
| 6   | 6   | <b>3183 04 06</b> | 10.5 | 38.5 | 7    | 17   | 17.5 | 0.006 |
| 6   | 6   | <b>3183 06 00</b> | 10.5 | 38.5 | 7    | 17   | 17   | 0.002 |
| 8   | 8   | <b>3183 06 08</b> | 13.5 | 48.5 | 8    | 21.5 | 23   | 0.014 |
| 8   | 8   | <b>3183 08 00</b> | 13.5 | 49   | 8    | 21.5 | 23   | 0.004 |
| 10  | 10  | <b>3183 08 10</b> | 16   | 56.5 | 10.5 | 24.5 | 26.5 | 0.018 |
| 10  | 10  | <b>3183 10 00</b> | 16   | 57   | 10.5 | 24.5 | 26.5 | 0.007 |
| 12  | 12  | <b>3183 10 12</b> | 19   | 65.5 | 10.5 | 27.5 | 31   | 0.034 |
| 12  | 12  | <b>3183 12 00</b> | 19   | 65.5 | 10.5 | 27.5 | 31   | 0.011 |

## 3184 Extended Equal and Unequal Plug-In Elbow

Technical polymer, NBR

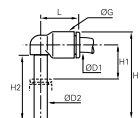

| ØD1 | ØD2 |                   | G    | H    | H1   | H2   | L    | Kg    |
|-----|-----|-------------------|------|------|------|------|------|-------|
| 4   | 4   | <b>3184 04 00</b> | 8.5  | 32.5 | 15.5 | 25   | 14   | 0.004 |
| 6   | 6   | <b>3184 04 06</b> | 10.5 | 38.5 | 19   | 29   | 16   | 0.004 |
| 6   | 6   | <b>3184 06 00</b> | 10.5 | 38.5 | 19   | 29   | 16   | 0.002 |
| 8   | 8   | <b>3184 06 08</b> | 13.5 | 49   | 23.5 | 37   | 23   | 0.007 |
| 8   | 8   | <b>3184 08 00</b> | 13.5 | 49   | 23.5 | 37   | 23   | 0.003 |
| 10  | 10  | <b>3184 08 10</b> | 16   | 56   | 26.5 | 41.5 | 26.5 | 0.011 |
| 10  | 10  | <b>3184 10 00</b> | 16   | 56   | 26.5 | 41.5 | 26.5 | 0.005 |
| 12  | 12  | <b>3184 10 12</b> | 19   | 62.5 | 28   | 45.5 | 31   | 0.017 |
| 12  | 12  | <b>3184 12 00</b> | 19   | 62.5 | 28   | 45.5 | 31   | 0.008 |

The references in diameter 4mm and 12mm are not grooved in standard version

## 3188 Equal and Unequal Plug-In Branch Tee

Technical polymer, NBR

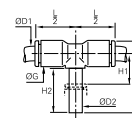

| ØD1 | ØD2 |                   | G    | H    | H1   | H2   | L/2  | Kg    |
|-----|-----|-------------------|------|------|------|------|------|-------|
| 4   | 4   | <b>3188 04 00</b> | 8.5  | 25   | 8    | 15.5 | 14.5 | 0.001 |
| 6   | 6   | <b>3188 04 06</b> | 10.5 | 28.5 | 9    | 17   | 16   | 0.007 |
| 6   | 6   | <b>3188 06 00</b> | 10.5 | 28.5 | 9    | 17   | 16   | 0.002 |
| 8   | 8   | <b>3188 06 08</b> | 13.5 | 36.5 | 11   | 21.5 | 22   | 0.014 |
| 8   | 8   | <b>3188 08 00</b> | 13.5 | 36.5 | 11   | 21.5 | 23   | 0.004 |
| 10  | 10  | <b>3188 08 10</b> | 16   | 41   | 12.5 | 24.5 | 26.5 | 0.018 |
| 10  | 10  | <b>3188 10 00</b> | 16   | 41   | 12.5 | 24.5 | 26.5 | 0.007 |
| 12  | 12  | <b>3188 10 12</b> | 19   | 46.5 | 12.5 | 27.5 | 31   | 0.030 |
| 12  | 12  | <b>3188 12 00</b> | 19   | 46.5 | 12.5 | 27.5 | 31   | 0.012 |

## 3142 Equal and Unequal Plug-In Single Y Piece

Technical polymer, NBR

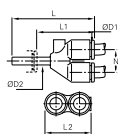

| ØD1 | ØD2 |                   | L    | L1   | L2   | N    | Kg    |
|-----|-----|-------------------|------|------|------|------|-------|
| 4   | 4   | <b>3142 04 00</b> | 34   | 21.5 | 17.5 | 9    | 0.002 |
|     | 6   | <b>3142 04 06</b> | 35.5 | 21.5 | 17.5 | 9    | 0.002 |
| 6   | 6   | <b>3142 06 00</b> | 39.5 | 25.5 | 21.5 | 11   | 0.004 |
|     | 8   | <b>3142 06 08</b> | 44.5 | 26   | 22   | 11   | 0.006 |
| 8   | 8   | <b>3142 08 00</b> | 50.5 | 32   | 28   | 14.5 | 0.007 |
|     | 10  | <b>3142 08 10</b> | 53.5 | 32   | 28   | 14.5 | 0.022 |
| 10  | 10  | <b>3142 10 00</b> | 57.5 | 36   | 33   | 17   | 0.010 |
|     | 12  | <b>3142 10 12</b> | 60   | 35   | 33   | 17   | 0.035 |
| 12  | 12  | <b>3142 12 00</b> | 66   | 41   | 39   | 20   | 0.017 |

## 3143 Multiple Plug-In Y Piece

Technical polymer, Nickel-plated brass, NBR

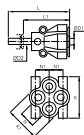

| ØD1 | ØD2 |                   | K    | K1   | L    | L1   | N  | N1  | Kg    |
|-----|-----|-------------------|------|------|------|------|----|-----|-------|
| 4   | 6   | <b>3143 04 06</b> | 26   | 21.5 | 49.5 | 35.5 | 11 | 8.5 | 0.018 |
|     | 8   | <b>3143 04 08</b> | 26   | 21.5 | 51   | 32   | 11 | 8.5 | 0.021 |
| 6   | 8   | <b>3143 06 08</b> | 31.5 | 26.5 | 57.5 | 39   | 12 | 10  | 0.035 |

## 3120 Stem Connector

Technical polymer

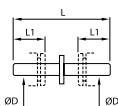

| ØD |                   | L    | L1   | Kg    |
|----|-------------------|------|------|-------|
| 4  | <b>3120 04 00</b> | 34.5 | 12   | 0.001 |
| 6  | <b>3120 06 00</b> | 38.5 | 14   | 0.001 |
| 8  | <b>3120 08 00</b> | 41   | 18.5 | 0.001 |
| 10 | <b>3120 10 00</b> | 51.5 | 20.5 | 0.002 |
| 12 | <b>3120 12 00</b> | 60   | 24.5 | 0.004 |
| 14 | <b>3120 14 00</b> | 69.5 | 25.5 | 0.007 |

This model exists in nickel-plated brass; please use suffix 85. Example: 3120 06 00 85  
Only compatible with Parker Legris fittings. Drawing available upon request.

## 3166 Plug-In Reducer

Technical polymer, NBR

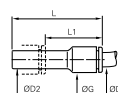

| ØD1 | ØD2 |                   | G    | L    | L1   | Kg    |
|-----|-----|-------------------|------|------|------|-------|
| 3   | 4   | <b>3166 03 04</b> | 8.5  | 37.5 | 23.5 | 0.002 |
|     | 6   | <b>3166 04 06</b> | 8.5  | 37.5 | 23.5 | 0.001 |
| 4   | 8   | <b>3166 04 08</b> | 8.5  | 37.5 | 19   | 0.001 |
|     | 10  | <b>3166 04 10</b> | 10.5 | 38   | 18   | 0.003 |
| 6   | 8   | <b>3166 06 08</b> | 10.5 | 37.5 | 20   | 0.001 |
|     | 10  | <b>3166 06 10</b> | 10.5 | 38   | 17.5 | 0.002 |
| 8   | 12  | <b>3166 08 12</b> | 14.5 | 46   | 23   | 0.005 |
|     | 14  | <b>3166 08 14</b> | 14.5 | 48   | 23   | 0.007 |
| 10  | 10  | <b>3166 10 10</b> | 13.5 | 49   | 28.5 | 0.003 |
|     | 12  | <b>3166 10 12</b> | 13.5 | 49   | 24.5 | 0.004 |
| 12  | 14  | <b>3166 12 14</b> | 17   | 48   | 23   | 0.007 |
|     | 12  | <b>3166 12 12</b> | 21.5 | 56.5 | 33.5 | 0.005 |
| 14  | 14  | <b>3166 14 14</b> | 21.5 | 58.5 | 33.5 | 0.005 |
|     | 12  | <b>3166 14 12</b> | 23.5 | 58.5 | 33.5 | 0.007 |

## 3166 Plug-In Reducer

Inch

Technical polymer, NBR

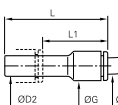

| ØD1 | ØD2  |                   | G  | L  | L1 | Kg    |
|-----|------|-------------------|----|----|----|-------|
| 1/4 | 5/16 | <b>3166 56 08</b> | 11 | 41 | 23 | 0.002 |
|     | 3/8  | <b>3166 56 60</b> | 11 | 41 | 21 | 0.002 |

## 3168 Plug-In Increaser

Technical polymer, NBR

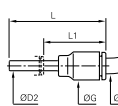

| ØD1 | ØD2 |                   | G    | L    | L1   | Kg    |
|-----|-----|-------------------|------|------|------|-------|
| 6   | 4   | <b>3168 06 04</b> | 10.5 | 35   | 23   | 0.002 |
|     | 6   | <b>3168 08 06</b> | 13.5 | 45   | 31.5 | 0.003 |
| 8   | 1/4 | <b>3168 08 56</b> | 16   | 40   | 25.5 | 0.009 |
|     | 8   | <b>3168 10 08</b> | 16   | 42.5 | 21   | 0.004 |
| 12  | 10  | <b>3168 12 10</b> | 19   | 49   | 24.5 | 0.006 |

## 3168 Plug-In Increaser

Inch

Technical polymer, NBR

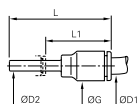

| ØD1 | ØD2  |                   | G    | L  | L1 | Kg    |
|-----|------|-------------------|------|----|----|-------|
| 1/4 | 3/16 | <b>3168 56 55</b> | 20.5 | 41 | 25 | 0.002 |
|     | 5/32 | <b>3168 56 04</b> | 11   | 41 | 29 | 0.002 |

## 3126 Blanking Plug

Technical polymer

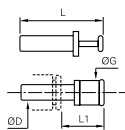

| ØD |                    | G  | L  | L1   | Kg    |
|----|--------------------|----|----|------|-------|
| 3  | <b>3126 03 00</b>  | 6  | 25 | 13.5 | 0.001 |
| 4  | <b>3126 04 00</b>  | 4  | 30 | 15.5 | 0.001 |
| 6  | <b>3126 06 00</b>  | 8  | 33 | 16.5 | 0.001 |
| 8  | <b>3126 08 00</b>  | 10 | 35 | 17.5 | 0.001 |
| 10 | <b>3126 10 00</b>  | 12 | 42 | 21   | 0.002 |
| 12 | <b>3126 12 00</b>  | 14 | 45 | 22   | 0.003 |
| 14 | <b>3126 14 00</b>  | 16 | 49 | 23.5 | 0.005 |
| 16 | <b>3126 16 00*</b> | 19 | 57 | 30   | 0.064 |

\*Nickel-plated brass

## 3126 Blanking Plug

Inch

Technical polymer

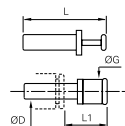

| ØD  |                   | G  | L    | L1   | Kg    |
|-----|-------------------|----|------|------|-------|
| 1/4 | <b>3126 56 00</b> | 8  | 36.5 | 22   | 0.001 |
| 3/8 | <b>3126 60 00</b> | 12 | 42   | 22   | 0.002 |
| 1/2 | <b>3126 62 00</b> | 15 | 48.5 | 21.5 | 0.003 |

5/32"(4 mm) and 5/16"(8 mm) also available

## 3122 Plug-In Barb Connector

Technical polymer

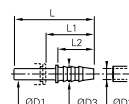

| ØD1 | ØD2  | ØD3  |                   | L    | L1   | L2   | Kg    |
|-----|------|------|-------------------|------|------|------|-------|
| 4   | 3.2  | 5    | <b>3122 04 53</b> | 37   | 25   | 17   | 0.004 |
|     | 5    | 7    | <b>3122 04 05</b> | 37   | 25   | 17   | 0.001 |
| 6   | 5    | 7    | <b>3122 06 05</b> | 39   | 25   | 17   | 0.001 |
| 8   | 6.3  | 8.5  | <b>3122 08 56</b> | 39.5 | 21   | 17   | 0.001 |
|     | 8    | 10   | <b>3122 08 08</b> | 44.5 | 26   | 22   | 0.001 |
| 10  | 6.3  | 8    | <b>3122 10 56</b> | 45   | 24.5 | 17   | 0.002 |
|     | 8    | 10   | <b>3122 10 08</b> | 50   | 29.5 | 22   | 0.002 |
| 12  | 8    | 10   | <b>3122 12 08</b> | 50   | 26   | 22   | 0.002 |
|     | 10   | 12   | <b>3122 12 10</b> | 48.5 | 25.5 | 22.5 | 0.002 |
| 14  | 12.5 | 14.5 | <b>3122 12 62</b> | 57   | 34   | 22.5 | 0.004 |
|     | 12.5 | 14.5 | <b>3122 14 62</b> | 59.5 | 34.5 | 22.5 | 0.006 |

## 3151 End Cap

Technical polymer, NBR

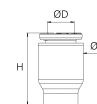

| ØD |                   | G    | H  | Kg    |
|----|-------------------|------|----|-------|
| 4  | <b>3151 04 00</b> | 8.5  | 15 | 0.001 |
| 6  | <b>3151 06 00</b> | 10.5 | 17 | 0.001 |
| 8  | <b>3151 08 00</b> | 13.5 | 22 | 0.002 |
| 10 | <b>3151 10 00</b> | 16   | 22 | 0.003 |
| 12 | <b>3151 12 00</b> | 19   | 28 | 0.005 |
| 14 | <b>3151 14 00</b> | 22   | 31 | 0.009 |