

# Metric Standpipe (BEL)

23.6000.

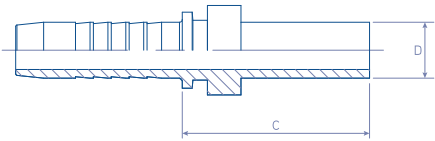

REFERENCE	hose	hose Ø	d - tube	C cut off
	dash	inch	inch	mm
23.6000.0304	-3	3/16"	4	24.5
23.6000.0306	-3	3/16"	6	29.5
23.6000.0308	-3	3/16"	8	31.0
23.6000.0406	-4	1/4"	6	28.0
23.6000.0408	-4	1/4"	8	30.5
23.6000.0410	-4	1/4"	10	33.0
23.6000.0412	-4	1/4"	12	33.0
23.6000.0510	-5	5/16"	10	33.5
23.6000.0512	-5	5/16"	12	33.5
23.6000.0610	-6	3/8"	10	30.5
23.6000.0612	-6	3/8"	12	30.5
23.6000.0614	-6	3/8"	14	30.5
23.6000.0615	-6	3/8"	15	30.5
23.6000.0814	-8	1/2"	14	36.0
23.6000.0815	-8	1/2"	15	32.0
23.6000.0816	-8	1/2"	16	37.0
23.6000.0818	-8	1/2"	18	37.0
23.6000.1018	-10	5/8"	18	34.0
23.6000.1020	-10	5/8"	20	44.0
23.6000.1022	-10	5/8"	22	44.5
23.6000.1220	-12	3/4"	20	44.5
23.6000.1222	-12	3/4"	22	36.5
23.6000.1225	-12	3/4"	25	49.5
23.6000.1625	-16	1"	25	51.0
23.6000.1628	-16	1"	28	40.0
23.6000.1630	-16	1"	30	54.0
23.6000.1638	-16	1"	38	60.0
23.6000.2030	-20	1.1/4"	30	58.0
23.6000.2035	-20	1.1/4"	35	48.0
23.6000.2038	-20	1.1/4"	38	62.0
23.6000.2438	-24	1.1/2"	38	63.0
23.6000.2442	-24	1.1/2"	42	50.0

**MATERIAL:** Carbon Steel

**FINISH:** Chromium-(VI) Free plating / ROHS compliant

**VERSIONS:** Stainless Steel (add an 'S' at the end of the REFERENCE)