

ED Eolastic soft seal (for BSPP and metric parallel threads)

For Type: GE...ED, EGE...ED, EVGE...ED, EW...ED, EV...ED, ET...ED, EL...ED,
VSTI...ED, RI...ED

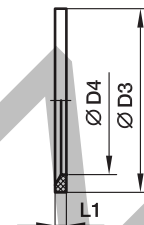

| Male stud metric thread T1 | Male stud BSP thread T1 | D3 | D4 | L1 | Weight g/1 piece | Order code NBR | Order code FKM |
|----------------------------------|-------------------------------|------|------|-----|---------------------|-------------------|---------------------|
| M 08×1.0 | | 9.9 | 6.5 | 1.0 | 0.1 | ED8X1X | ED8X1VITX |
| M 10×1.0 | G 1/8 A | 11.9 | 8.4 | 1.0 | 0.1 | ED10X1X | ED10X1VITX |
| M 12×1.5 | | 14.4 | 9.8 | 1.5 | 0.2 | ED12X1.5X | ED12X1.5VITX |
| M 14×1.5 | G 1/4 A | 16.5 | 11.6 | 1.5 | 0.2 | ED14X1.5X | ED14X1.5VITX |
| M 16×1.5 | | 18.9 | 13.8 | 1.5 | 0.1 | ED16X1.5X | ED16X1.5VITX |
| | G 3/8 A | 18.9 | 14.7 | 1.5 | 0.2 | ED3/8X | ED3/8VITX |
| M 18×1.5 | | 20.9 | 15.7 | 1.5 | 0.1 | ED18X1.5X | ED18X1.5VITX |
| M 20×1.5 | | 22.9 | 17.8 | 1.5 | 0.2 | ED20X1.5X | ED20X1.5VITX |
| | G 1/2 A | 23.9 | 18.5 | 1.5 | 0.3 | ED1/2X | ED1/2VITX |
| M 22×1.5 | | 24.3 | 19.6 | 1.5 | 0.2 | ED22X1.5X | ED22X1.5VITX |
| M 26×1.5 | G 3/4 A | 29.2 | 23.9 | 1.5 | 0.4 | ED26X1.5X | ED26X1.5VITX |
| M 27×2.0 | G 3/4 A | 29.2 | 23.9 | 1.5 | 0.4 | ED26X1.5X | ED26X1.5VITX |
| M 33×2.0 | G 1 A | 35.7 | 29.7 | 2.0 | 0.7 | ED33X2X | ED33X2VITX |
| M 42×2.0 | G 1 1/4 A | 45.8 | 38.8 | 2.0 | 0.9 | ED42X2X | ED42X2VITX |
| M 48×2.0 | G 1 1/2 A | 50.7 | 44.7 | 2.0 | 1.0 | ED48X2X | ED48X2VITX |