

BUZM Blanking plug with nut for cones

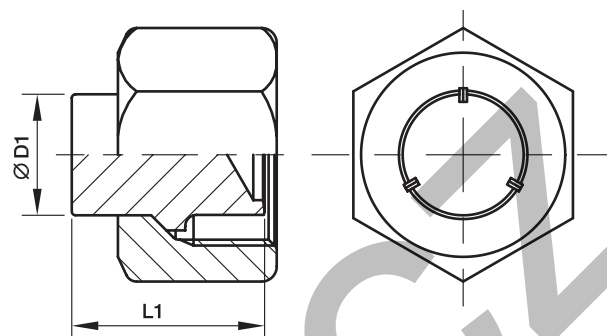

| Series | D1 | L1 | Weight g/1 piece | Order code* | PN (bar) ¹⁾ | |
|-----------------|--------|------|---------------------|-------------|------------------------|-----|
| | | | | | Steel | 71 |
| L ³⁾ | 06 | 19.5 | 15 | BUZM06L | 315 | 315 |
| | 08 | 19.5 | 23 | BUZM08L | 315 | 315 |
| | 10 | 21.0 | 31 | BUZM10L | 315 | 315 |
| | 12 | 21.8 | 45 | BUZM12L | 315 | 315 |
| | 15 | 22.0 | 71 | BUZM15L | 315 | 315 |
| | 18 | 24.0 | 107 | BUZM18L | 315 | 315 |
| | 22 | 26.0 | 156 | BUZM22L | 160 | 160 |
| | 28 | 26.5 | 206 | BUZM28L | 160 | 160 |
| | 35 | 32.0 | 354 | BUZM35L | 160 | 160 |
| | 42 | 32.5 | 524 | BUZM42L | 160 | 160 |
| S ⁴⁾ | 06 | 19.5 | 23 | BUZM06S | 630 | 630 |
| | 08 | 19.5 | 28 | BUZM08S | 630 | 630 |
| | 10 | 21.0 | 44 | BUZM10S | 630 | 630 |
| | 12 | 21.8 | 54 | BUZM12S | 630 | 630 |
| | 16 | 25.5 | 105 | BUZM16S | 400 | 400 |
| | 20 | 30.5 | 176 | BUZM20S | 400 | 400 |
| | 25 | 32.5 | 321 | BUZM25S | 400 | 400 |
| | 30 | 35.5 | 399 | BUZM30S | 400 | 400 |
| | 38 | 40.0 | 664 | BUZM38S | 315 | 315 |

¹⁾ Pressure shown = item deliverable

³⁾ L = light series; ⁴⁾ S = heavy series

$$\frac{PN \text{ (bar)}}{10} = PN \text{ (MPa)}$$

*Please add the **suffixes** below according to the material/surface required.

| Order code suffixes | | |
|---------------------|-----------------------------|-----------|
| Material | Suffix surface and material | Example |
| Steel | CF | BUZM16SCF |
| Stainless Steel | 71 | BUZM16S71 |