

## R119 Pilot Operated Regulators - Hi-Flow

- Adapted for control by a remote or distant small pilot regulator. Ideal for maximum capacity requirements in applications where units are not readily accessible
- High flow performance featuring rugged design for the most demanding applications
- Ideal for those installations calling for constant pressure with wide variation in flow
- Piston operated design with balanced poppet and dual constant bleed for quick and accurate regulation
- 2", 2-1/2" ports (NPT, BSPP)

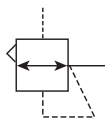

Port size	Description (0-125 psig reduced pressure)	Part number
2"	Without gauge, relieving, NPT	<b>R119-16J</b>
2-1/2"	Without gauge, relieving, NPT	<b>R119-20J</b>

### Operating information

Supply pressure (max):	300 psig (0 to 20.7 bar)
Air consumption:	
Constant bleed from	Air pilot chamber: approx. 0.17 scfm (10 scfh)
	Reduced pressure: approx. 0.17 scfm (10 scfh)
Operating temperature:	40°F to 120°F (4.4°C to 48.9°C)
Reduced pressure range:	Adjustable to within 5 to 7 psig (0.34 to 0.48 bar) of supply pressure
Flow capacity†:	
High flow	2" 1800 scfm (850 dm³/s, ANR)
	2-1/2" 1800 scfm (850 dm³/s, ANR)
Gauge ports (2):	
Can be used for full flow	1/4 inch
High pressure outlet for pilot	1/4 inch
Weight:	15 lb (6.8 kg)

† scfm = Standard cubic feet per minute at 100 psig inlet, 75 psig no flow secondary setting and 20 psig pressure drop.

### Ordering information:

<b>R119</b>	<b>-</b>	<b>16</b>	<b>J</b>
<b>Port Threads</b>			<b>Reduced Pressure Range</b>
NPT	-		J Air pilot operated
BSPP	G		
<b>Port Size</b>			
2 inch	16		
2-1/2 inch	20		

NOTE: Non-relieving not available.

Most popular.



For inventory, lead times, and kit  
lookup, visit [www.pdnplu.com](http://www.pdnplu.com)

H24

**Parker Hannifin Corporation**  
Pneumatic Division  
Richland, Michigan  
[www.parker.com/pneumatics](http://www.parker.com/pneumatics)

**Material Specifications**

Body, piston	Aluminum
Seals	Buna N
Innervolve	Brass & stainless

**Repair and Service Kits**

2" dial face 60 psig (0 to 4.1 bar), gauge	<b>K4520N14060</b>
2" dial face 160 psig (0 to 11.0 bar), gauge	<b>K4520N14160</b>
2" dial face 300 psig (0 to 20.7 bar), gauge	<b>K4520N14300</b>
1-3/4" digital round face 160 psig (0 to 11.0 bar), gauge	<b>K4517N14160D</b>
Piston type regulation (2", 2-1/2")	<b>RK119G</b>

**R119-16J, R119-20J**

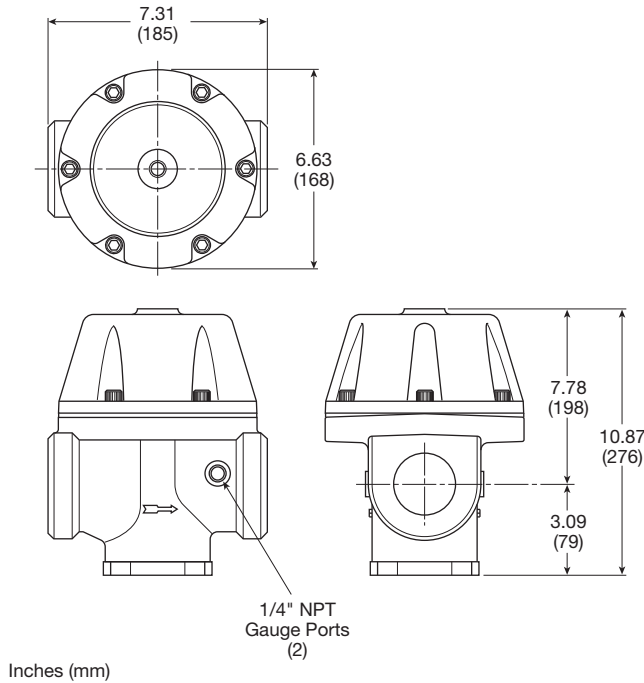

**Flow Charts**

**R119 2" Regulator**

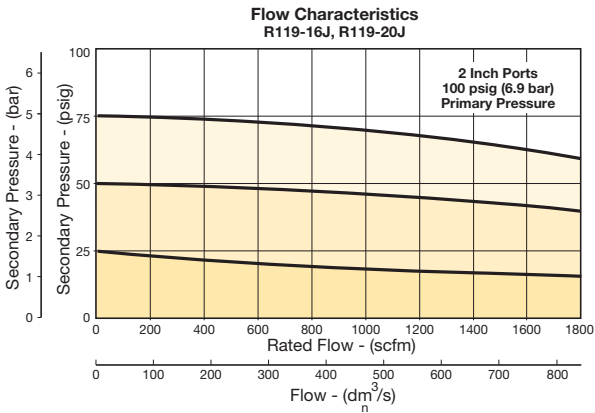

**WARNING**

Product rupture can cause serious injury.  
Do not connect regulator to bottled gas.  
Do not exceed Maximum primary pressure rating.