

Shock absorbers are hydraulic units that assist in bringing a moving load to rest, quickly and safely, without rebound or backward movement.

They provide a constant linear deceleration with the lowest possible reaction force in the shortest possible stopping time.

- Compact and heavy duty versions
- High energy absorption
- Low return force
- Long service life
- Increases productivity
- Reduces maintenance



### Operation information

Type	Self-compensating
Working temperature	
MC9 to MC 600	0 °C to +65 °C
SC925	-12 °C to +90 °C
MC33 to MC64	-12 °C to +70 °C

**Sizing software available on separate CD : PDE2524TCUK-CD**

For more information see [www.parker.com/euro\\_pneumatic](http://www.parker.com/euro_pneumatic)

### MC 9 to MC 600 series

Stroke (mm)	Ø	Order code
5	M6 x 0,5	MC9M-1-B
5	M6 x 0,5	MC9M-2-B
5	M8 x 1	MC10ML-B
5	M8 x 1	MC10MH-B
6,6	M10 x 1	MC25ML
6,6	M10 x 1	MC25M
6,6	M10 x 1	MC25MH
10	M12 x 1	MC75M-1
10	M12 x 1	MC75M-2
10	M12 x 1	MC75M-3
12,5	M14 x 1,5	MC150M
12,5	M14 x 1,5	MC150MH
12,5	M14 x 1,5	MC150MH2
12,5	M20 x 1,5	MC225M
12,5	M20 x 1,5	MC225MH
12,5	M20 x 1,5	MC225MH2
25,4	M25 x 1,5	MC600M
25,4	M25 x 1,5	MC600MH
25,4	M25 x 1,5	MC600MH2

### SC 925 series

Stroke (mm)	Ø	Order code
40	M25 x 1,5	SC925M-1
40	M25 x 1,5	SC925M-2
40	M25 x 1,5	SC925M-3

### Accessories

#### Stop collar

Series	Order code
MC 9 M	AH6
MC 10 M	AH8
MC 25 M	AH10
MC 75 M	AH12
MC 150 M	AH14
MC 225 M	AH20
MC 600M	AH25
SC 925 M	

#### Clamp

Series	Order code
MC 9 M	MB6
MC 10 M	MB8
MC 25 M	MB10
MC 75 M	MB12
MC 150 M	MB14
MC 225 M	MB20
MC 600M	MB25
SC 925 M	

#### Side load adaptor

Series	Order code
MC 10 M	BV8
MC 25 M	BV10
MC 75 M	BV12
MC 150 M	BV14
MC 225 M	BV20
MC 600M	BV25
SC 925 M	

Accessories

Rectangular flange

Series	Order code
MC 9 M	RF6
MC 10 M	RF8
MC 25 M	RF10
MC 75 M	RF12
MC 150 M	RF14
MC 225 M	RF20
MC 600M	RF25
SC 925 M	



Lock nut

Series	Order code
MC 9 M	KM6
MC 10 M	KM8
MC 25 M	KM10
MC 75 M	KM12
MC 150 M	KM14
MC 225 M	KM20
MC 600M	KM25
SC 925 M	



MC 33 to MC 64

Stroke (mm)	Ø	Order code
25	M33 x 1,5	MC 3325 M-1
50	M33 x 1,5	MC 3350 M-1
25	M45 x 1,5	MC 4525 M-1
50	M45 x 1,5	MC 4550 M-1
75	M45 x 1,5	MC 4575 M-1
50	M64 x 2	MC 6450 M-1
100	M64 x 2	MC 64100 M-1
150	M64 x 2	MC 64150 M-1



Accessories

Locking ring

Series	Order code
MC 33	NM33
MC 45	NM45
MC 64	NM64



Nylon button

Series	Order code
MC 33	PP33
MC 45	PP45
MC 64	PP64



Square flange

Series	Order code
MC 33	QF33
MC 45	QF45
MC 64	QF64



Side foot mounting kit

Series	Order code
S33	
MC4525M, MC4550M & MC4575M	S45
MC6450M, MC64100M & MC64150M	S64



Clevis mounting kit

Series	Order code
MC 33	C33
MC 45	C45
MC 64	C64



Female fitting

Series	Order code
MC 33	P1C-4KMC
MC 45	P1C-4MMC
MC 64	P1C-4PMC



Dimensions (mm)

Serie MC 9 M to MC 75 M

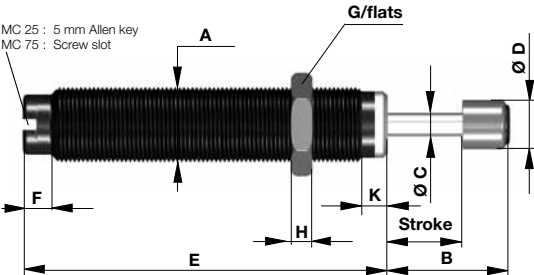

Serie MC 150 M to MC 600 M

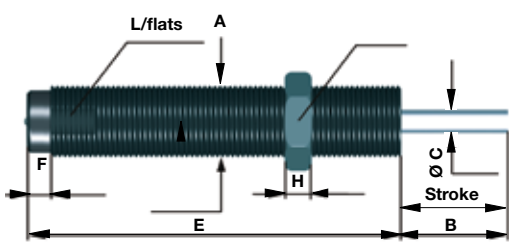

Part No	Stroke (mm)	A	B	C	D	E	F	G	H	K	L
MC 9 M-1-B	5	M6 x 0,5	10	2	4,8	26	2,5	8	2,5	1	-
MC 9 M-2-B	5	M6 x 0,5	10	2	4,8	26	2,5	8	2,5	1	-
MC 10 ML-B	5	M8 x 1	10	2	6,4	28,5	5	11	3	2	-
MC 10 MH-B	5	M8 x 1	10	2	6,4	28,5	5	11	3	2	-
MC 25 ML	6,6	M10 x 1	14,6	3,2	7,6	43,4	5	13	3	5	-
MC 25 M	6,6	M10 x 1	14,6	3,2	7,6	43,4	5	13	3	5	-
MC 25 MH	6,6	M10 x 1	14,6	3,2	7,6	43,4	5	13	3	5	-
MC 75 M-1	10	M12 x 1	18	3,2	7,6	52	5	14	4	3	-
MC 75 M-2	10	M12 x 1	18	3,2	7,6	52	5	14	4	3	-
MC 75 M-3	10	M12 x 1	18	3,2	7,6	52	5	14	4	3	-
MC 150 M	12,5	M14 x 1,5	17,5	4,8	-	70	8,5	17	5	-	12
MC 150 MH	12,5	M14 x 1,5	17,5	4,8	-	70	8,5	17	5	-	12
MC 150 MH2	12,5	M14 x 1,5	17,5	4,8	-	70	8,5	17	5	-	12
MC 225 M	12,5	M20 x 1,5	17,5	6,3	-	80	8,5	24	6	-	18
MC 225 MH	12,5	M20 x 1,5	17,5	6,3	-	80	8,5	24	6	-	18
MC 225 MH2	12,5	M20 x 1,5	17,5	6,3	-	80	8,5	24	6	-	18
MC 600 M	25,4	M25 x 1,5	32	8	-	111	9	30	8	-	23
MC 600 MH	25,4	M25 x 1,5	32	8	-	111	9	30	8	-	23
MC 600 MH2	25,4	M25 x 1,5	32	8	-	111	9	30	8	-	23

Serie SC 925

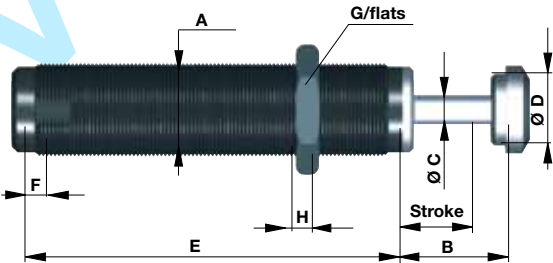

Part No	Stroke (mm)	A	B	C	D	E	F	G	H
SC 925 M-1	40	M25 x 1,5	51	6,3	23	138	7	30	8
SC 925 M-2	40	M25 x 1,5	51	6,3	23	138	7	30	8
SC 925 M-3	40	M25 x 1,5	51	6,3	23	138	7	30	8

Dimensions (mm)

Stop collar

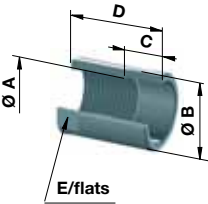

Part No	Used with series	ØA	ØB	C	D	E
AH6	MC 9 M	M 6 x 0,5	8	6	12	-
AH8	MC 10 M	M 8 x 1	11	6	12	-
AH10	MC 25 M	M 10 x 1	14	10	20	-
AH12	MC 75 M	M 12 x 1	16	10	20	-
AH14	MC 150 M	M 14 x 1,5	18	12	20	15
AH20	MC 225 M	M 20 x 1,5	25	12	25	22
AH25	MC 600 M	M 25 x 1,5	32	16	32	27
	SC 925 M	M 25 x 1,5	32	16	32	27

Clamp

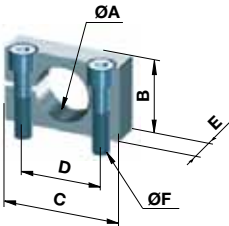

Part No	Used with series	ØA	B	C	D	E	ØF
MB6	MC 9 M	M 6 x 0,5	10	20	12	8	M3
MB8	MC 10 M	M 8 x 1	12	25	16	10	M4
MB10	MC 25 M	M 10 x 1	14	25	16	10	M4
MB12	MC 75 M	M 12 x 1	16	32	20	12	M5
MB14	MC 150 M	M 14 x 1,5	20	32	20	12	M5
MB20	MC 225 M	M 20 x 1,5	25	40	28	20	M6
MB25	MC 600 M	M 25 x 1,5	32	46	34	25	M6
	SC 925 M	M 25 x 1,5	32	46	34	25	M6

Side load adaptor

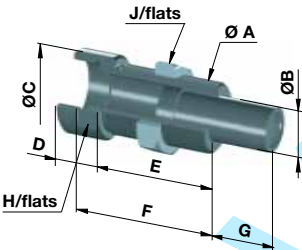

Part No	Used with series	ØA	ØB	ØC	D	E	ØF	G	H	J
BV8	MC 10 M	M 8 x 1	4	11	10	10	12	5	9	11
BV10	MC 25 M	M 10 x 1	6	13	11	12	15	6,5	11	13
BV12	MC 75 M	M 12 x 1	7	15	12	18	22	10	14	14
BV14	MC 150 M	M 14 x 1,5	9	18	12	20	24	12,5	16	17
BV20	MC 225 M	M 20 x 1,5	12	24	14	20	24	12,5	22	24
BV25	MC 600 M	M 25 x 1,5	16	30	16	38	44	25	27	30
	SC 925 M	M 25 x 1,5	16	30	16	38	44	25	27	30

**Dimensions (mm)**

**Rectangular flange**

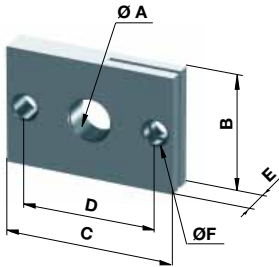

Part No	Used with series	ØA	B	C	D	E	ØF
RF6	MC 9 M	M 6 x 0,5	10	20	14	5	3,4
RF8	MC 10 M	M 8 x 1	14	25	18	6	4,5
RF10	MC 25 M	M 10 x 1	14	28	20	6	4,5
RF12	MC 75 M	M 12 x 1	20	32	24	6	5,5
RF14	MC 150 M	M 14 x 1,5	20	34	26	6	5,5
RF20	MC 225 M	M 20 x 1,5	32	46	36	8	6,5
RF25	MC 600 M	M 25 x 1,5	32	52	42	8	6,5
	SC 925 M	M 25 x 1,5	32	52	42	8	6,5

**Lock nut**



Part No	Used with series	A	B	C
KM6	MC 9 M	M6 x 0,5	2,5	8
KM8	MC 10 M	M 8 x 1	3	11
KM10	MC 25 M	M 10 x 1	3	13
KM12	MC 75 M	M 12 x 1	4	14
KM14	MC 150 M	M 14 x 1,5	5	17
KM20	MC 225 M	M 20 x 1,5	6	24
KM25	MC 600 M	M 25 x 1,5	8	30
	SC 925 M	M 25 x 1,5	8	30

Dimensions (mm)

Serie MC 33 to MC 64

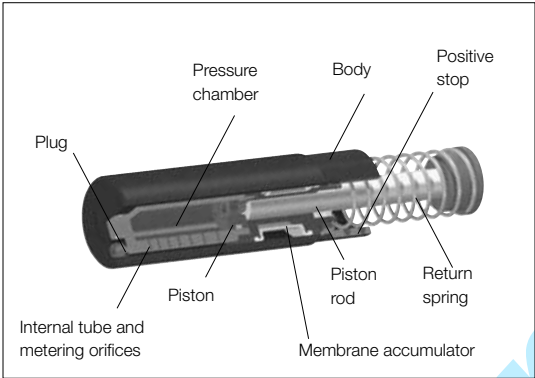

Serie	MC 3325 M	MC 3350 M	MC 4525 M	MC 4550 M	MC 4575 M	MC 6450 M	MC 64100 M	MC 64150 M
Thread (mm)	M33 x 1,5	M33 x 1,5	M45 x 1,5	M45 x 1,5	M45 x 1,5	M64 x 2	M64 x 2	M64 x 2
Type	Self-compensating							
Mechanical stop	Built-in end of stroke							
Impact velocity (m/s)	0,15 to 5							
Stroke (mm)	25	50	25	20	75	50	100	150
Max. capacity per cycle (Nm)	155	310	340	680	1020	1700	3400	5100
Temperature (°C)	- 12 to 70							

Dimensions (mm)

Serie MC 33 to MC 64

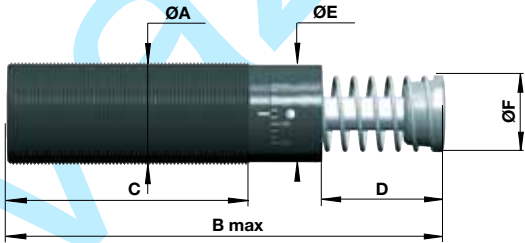

For the 3 ranges of effective weight

Part No	Stroke	A (mm)	B	C	D	E	F
MC 3325 M	25	M33 x 1,5	138	83	23	30	25
MC 3350 M	50	M33 x 1,5	189	108	48,5	30	25
MC 4525 M	25	M45 x 1,5	145	95	23	42	35
MC 4550 M	50	M45 x 1,5	195	120	48,5	42	35
MC 4575 M	75	M45 x 1,5	246	145	74	42	35
MC 6450 M	50	M64 x 2	225	140	48,5	60	48
MC 64100 M	100	M64 x 2	326	191	99,5	60	48
MC 64150 M	150	M64 x 2	450	241	150	60	48

# Dimensions (mm)

## Locking Ring

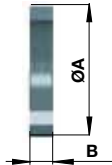

Part No	Used with serie	ØA	B
NM33	MC 3325 M & MC 3350 M	40	6
NM45	MC 4525 M & MC 4550 M & MC 4575 M	57	10
NM64	MC 6450 M & MC 64100 M & MC 64150 M	76	10

## Nylon Button

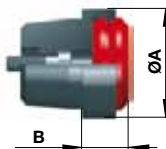

Part No	Used with serie	ØA	B
PP33	MC 3325 M & MC 3350 M	29	12
PP45	MC 4525 M & MC 4550 M & MC 4575 M	42	18
PP64	MC 6450 M & MC 64100 M & MC 64150 M	60	18

## Square Flange

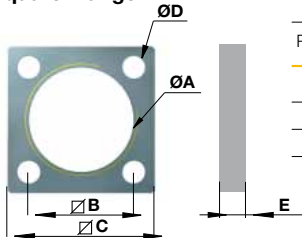

Part No	Used with serie	ØA	ØD	ØB	ØC	E
QF33	MC 3325 M & MC 3350 M	M33 x 1,5	6,6	32	44	12
QF45	MC 4525 M & MC 4550 M & MC 4575 M	M45 x 1,5	9	42	56	15
QF64	MC 6450 M & MC 64100 M & MC 64150 M	M64 x 2	11	58	80	20

## Side foot Mounting Kit

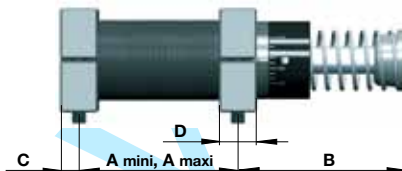

**S33** = 2 flanges + 4 screws M6 x40

**S45** = 2 flanges + 4 screws M8 x50

**S64** = 2 flanges + 4 screws M10 x80

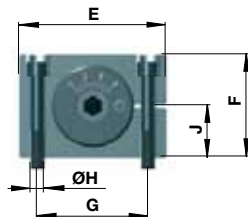

### Tightening torque

**S33** =11 Nm   **S45** = 27 Nm   **S64** = 50 Nm

### Removing torque

**S33** > 90 Nm   **S45** > 350 Nm   **S64** >350Nm

Part No	Used with serie	A mini	A maxi	B	C	D	E	F	G	ØH	J
S33	MC 3325 M	25	60	68	10	20	56	40	42	6,6	20
S33	MC 3350 M	32	86	93	10	20	56	40	42	6,6	20
S45	MC 4525 M	32	66	66	12,5	25	80	56	60	9	28
S45	MC 4550 M	40	92	91	12,5	25	80	56	60	9	28
S45	MC 4575 M	50	118	116	12,5	25	80	56	60	9	28
S64	MC 6450 M	50	112	100	12,5 <sup>2</sup>	25	100	80	78	11	40
S64	MC 64100 M	64	162	152	12,5	25	100	80	78	11	40
S64	MC 64150 M	80	212	226	12,5	25	100	80	78	11	40

Dimensions (mm)

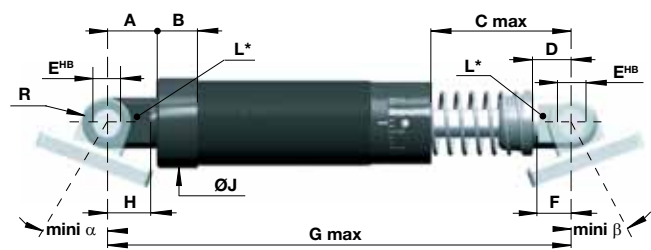

- S33 =
- S45 = 2 clevis shipped fitted onto shock absorber
- S64 =

Part No	Used with serie	A	B	Cmax	D	E <sup>HB</sup>	F	G max	H	ØJ	L*	R	mini α	mini β
C33	MC 3325 M	14	14	39	14	10	13	168	13	38	13	10	20°	0°
C33	MC 3350 M	14	14	64	14	10	13	218	13	38	13	10	20°	0°
C45	MC 4525 M	28	20	43	18	16	17	200	20	53	20	14	15°	15°
C45	MC 4550 M	28	20	68	18	13	17	250	20	53	20	14	15°	15°
C45	MC 4575 M	28	20	93	18	13	17	300	20	53	20	14	15°	15°
C64	MC 6450 M	35	25	85	35	20	30	310	30	74	24	20	20°	10°
C64	MC 64100 M	35	25	136	35	20	30	410	30	74	24	20	20°	10°
C64	MC 64150 M	35	25	187	35	20	30	530	30	74	24	20	20°	10°

L\* indicates the width of front and rear clevis

Female Fitting

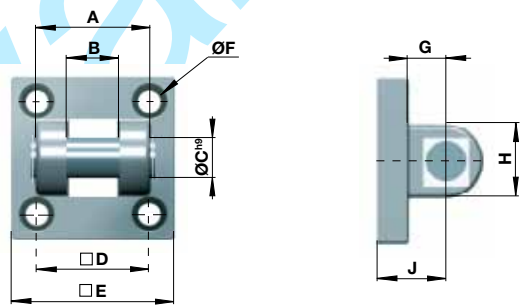

Supplied with 4 mounting screws

Part No	Used with serie	A	B	ØC <sup>HB</sup>	□ D	□ E	Ø F	G	H	J
P1C-4KMC	MC 3325 M , MC 3350 M	34	14	10	32	48	7	13	23	22
P1C-4MMC	MC 4525 M, MC 4550 M, MC 4575 M	45	21	16	46	65	9	15	29	27
P1C-4PMC	MC 6450 M, MC 64100 M, MC 64150 M	65	25	20	72	95	11	22	45	36