

Gerade Tülle

Douille droite double

Straight hose nozzle

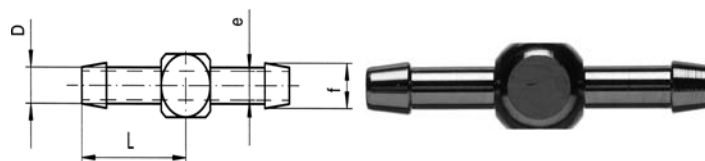

LO 1000

Type -d	Mat.-Nr.	L	f	e	kg/100
LO CV 1000-1.5	366.1000.015	8.0	2.0	1.0	0.060
LO CV 1000-2	366.1000.020	9.0	2.5	1.4	0.070
LO CV 1000-2,5	366.1000.025	10.5	3.0	1.9	0.120
LO CV 1000-3	366.1000.030	12.0	3.8	2.3	0.060
LO CV 1000-4	366.1000.040	14.5	5.0	3.2	0.325

Gerade Tülle reduziert

Douille droite double réduite

Straight hose nozzle reduced

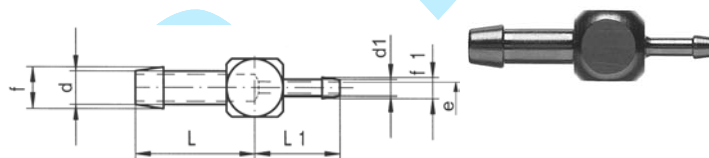

LO 1000 RED

Type -d -d1	Mat.-Nr.	L	L1	f	e	kg/100
LO CV 1000-2-1.5	366.1004.013	9.0	8.0	2.5	1.0	0.060
LO CV 1000-2.5-1.5	366.1004.010	10.5	8.5	3.0	1.0	0.110
LO CV 1000-2.5-2	366.1004.012	10.5	9.5	3.0	1.4	0.110
LO CV 1000-3-1.5	366.1004.014	12.0	9.0	3.8	1.0	0.180
LO CV 1000-3-2	366.1004.020	12.0	10.0	3.8	1.4	0.180
LO CV 1000-4-1.5	366.1004.028	14.5	9.5	5.0	1.0	0.290
LO CV 1000-4-2	366.1004.030	14.5	10.5	5.0	1.4	0.300
LO CV 1000-4-2,5	366.1004.035	14.5	11.5	5.0	1.9	0.310
LO CV 1000-4-3	366.1004.040	14.5	12.5	5.0	2.3	0.320

Tülle mit Schottbefestigung

Douille pour passage de cloison

Panel mount hose nozzle

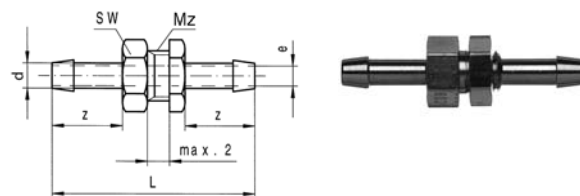

LO 1500

Type -d -Mz	Mat.-Nr.	SW	L	z	e	kg/100
LO CV 1500-1.5-M5	366.1500.006	7	20.0	6.0	1.0	0.240
LO CV 1500-2-M5	366.1500.020	7	22.0	7.0	1.4	0.240
LO CV 1500-2.5-M5	366.1500.030	7	24.0	8.0	1.9	0.250
LO CV 1500-3-M5	366.1500.050	7	26.0	9.0	2.3	0.260
LO CV 1500-4-M8x1	366.1500.090	10	32.0	11.0	3.2	0.670
LO CV 1500-4-G 1/8	366.1501.060	12	34.0	11.0	3.2	1.060

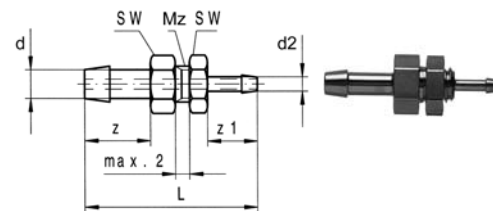
Tülle mit Schottbefestigung reduziert
Douille pour passage de cloison réduite
Panel mount hose nozzle reduced

LO 1500 RED

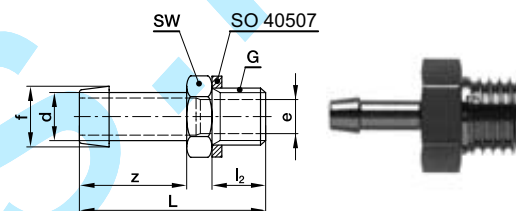
Type -d -d2 -Mz	Mat.-Nr.	SW	L	z1	z	kg/100
LO CV 1500-2-1.5-M5	366.1504.013	7	21.0	6.0	7.0	0.240
LO CV 1500-3-1.5-M5	366.1504.014	7	23.0	6.0	9.0	0.240
LO CV 1500-4-1.5-M5	366.1504.028	7	25.0	6.0	11.0	0.250
LO CV 1500-4-2-M5	366.1504.030	7	26.0	7.0	11.0	0.260
LO CV 1500-4-2.5-M5	366.1504.035	7	27.0	8.0	11.0	0.270
LO CV 1500-4-3-M5	366.1504.040	7	28.0	9.0	11.0	0.290

Einschraubtülle
Douille cannelée à visser
Male adaptor hose nozzle

LO 1100

Type -d -G	Mat.-Nr.	SW	L	f	z	kg/100
G=Rohrgewinde (zylindrisch)	G=Filetage-gaz BSP (cylindrique)	G=BSP thread (straight)				
LO CV 1100-1.5-1/8	366.1141.009	12	18.0	2.0	6.0	0.640
LO CV 1100-2-1/8	366.1141.020	12	19.0	2.5	7.0	0.840
LO CV 1100-2.5-1/8	366.1141.030	12	20.0	3.0	8.0	0.775
LO CV 1100-3-1/8	366.1141.040	12	23.0	3.8	9.0	0.825
LO CV 1100-4-1/8	366.1141.060	12	23.0	5.0	11.0	0.810
LO CV 1100-1.5-M5	366.1143.006	7	14.0	2.0	6.0	0.170
LO CV 1100-2-M5	366.1143.020	7	15.0	2.5	7.0	0.190
LO CV 1100-2.5-M5	366.1143.030	7	16.0	3.0	8.0	0.185
LO CV 1100-3-M5	366.1143.050	7	17.0	3.8	9.0	0.200
LO CV 1100-4-M5	366.1143.080	7	19.0	5.0	11.0	0.210
LO CV 1100-1.5-M8x1	366.1143.011	10	16.0	2.0	6.0	0.490
LO CV 1100-2-M8x1	366.1143.035	10	17.0	2.5	7.0	0.480
LO CV 1100-2.5-M8x1	366.1143.043	10	18.0	3.0	8.0	0.440
LO CV 1100-3-M8X1	366.1143.060	10	19.0	3.8	9.0	0.500
LO CV 1100-4-M8X1	366.1143.090	10	21.0	5.0	11.0	0.460

Die entsprechende Dichtung SO 40507 ist separat zu bestellen.

Le joint correspondant SO 40507 doit être commandé séparément.

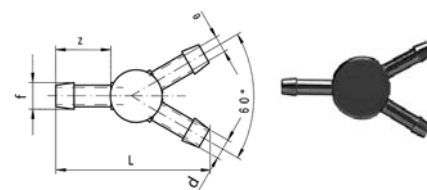
The appropriate washer SO 40507 should be ordered separately.

Winkelverteiler 60°
Distributeur 60°
Distributor 60°

LO 3000 60

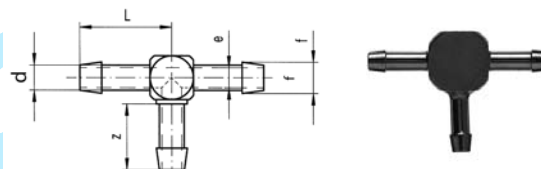
Type -d	Mat.-Nr.	L	f	z	e	kg/100
LO CV 3000-1.5-Y60°	366.5000.015	9.0	2.0	6.0	1.0	0.100
LO CV 3000-2-Y60°	366.5000.020	10.0	2.5	7.0	1.4	0.110
LO CV 3000-2,5-Y60°	366.5000.025	11.5	3.0	8.0	1.9	0.150
LO CV 3000-3-Y60°	366.5000.030	12.0	3.7	9.0	2.3	0.440
LO CV 3000-4-Y60°	366.5000.040	16.0	5.0	11.0	3.2	0.485

T-Stück
Té
Tee hose nipple

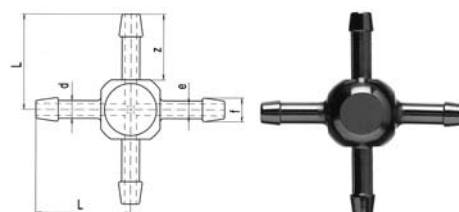
LO 3000 T

Type -d	Mat.-Nr.	L	f	z	e	kg/100
LO CV 3000-1.5	366.3000.015	8.0	2.0	6.0	1.0	0.060
LO CV 3000-2	366.3000.020	9.0	2.5	7.0	1.4	0.092
LO CV 3000-2,5	366.3000.025	11.0	3.0	8.0	1.9	0.150
LO CV 3000-3	366.3000.030	12.0	3.8	9.0	2.3	0.235
LO CV 3000-4	366.3000.040	14.5	5.0	11.0	3.2	0.375

Kreuz-Stück
Croix
Cross hose nipple

LO 4000

Type -d	Mat.-Nr.	L	f	z	e	kg/100
LO CV 4000-1.5	366.4000.015	8.0	2.0	6.0	1.0	0.070
LO CV 4000-2	366.4000.020	9.0	2.5	7.0	1.4	0.085
LO CV 4000-2,5	366.4000.025	10.5	3.0	8.0	1.9	0.175
LO CV 4000-3	366.4000.030	12.0	3.8	9.0	2.3	0.280
LO CV 4000-4	366.4000.040	14.5	5.0	11.0	3.2	0.435