

Muffe kurz G

Manchon court G

Threaded socket short G

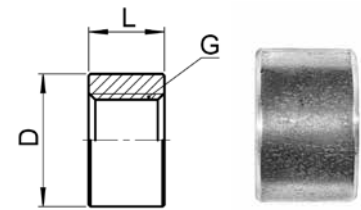

AD CS 50

Type -G	Mat.-Nr.	bar	L	D	kg/100
G=Rohrgewinde (zylindrisch)	G=Filetage-gaz BSP (cylindrique)		G=BSP thread (parallel)		
AD CS 50-1/8	TAD.5200.042	400	8.0	14.0	0.500
AD CS 50-1/4	TAD.5200.104	400	11.0	17.0	0.900
AD CS 50-3/8	TAD.5200.166	400	12.0	22.0	1.550
AD CS 50-1/2	TAD.5200.228	400	15.0	27.0	2.600
AD CS 50-3/4	TAD.5200.292	200	17.0	32.0	3.670
AD CS 50-1	TAD.5200.414	200	19.0	40.0	6.100

Hochdruckanschweissmuffe NPT

Manchon à souder pour haute pression NPT

High-pressure weld-on socket NPT

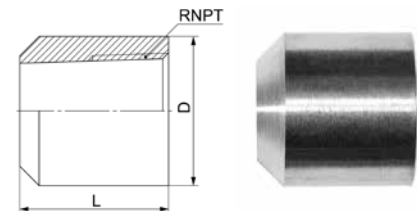

AD FCW 50 NPT

Type -RNPT	Mat.-Nr.	bar	L	D	kg/100
RNPT=NPT Gewinde	RNPT=Filetage NPT		RNPT=NPT thread		
AD FCW 50-1/8 NPT	TAD.5161.042	400	21.0	20.0	3.700
AD FCW 50-1/4 NPT	TAD.5161.104	400	25.0	25.0	6.900
AD FCW 50-3/8 NPT	TAD.5161.166	400	30.0	25.0	7.100
AD FCW 50-1/2 NPT	TAD.5161.228	400	30.0	32.0	11.600
AD FCW 50-1 NPT	TAD.5161.414	200	50.0	50.0	39.500

Sechskantmuffe G

Manchon hexagonal G

Hexagonal threaded socket G

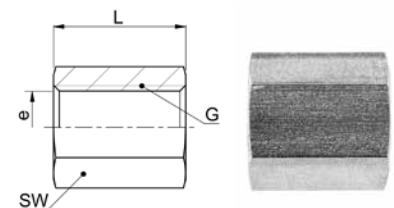

AD HC 50

Type -G	Mat.-Nr.	bar	SW	L	e	kg/100
G=Rohrgewinde (zylindrisch)	G=Filetage-gaz BSP (cylindrique)		G=BSP thread (parallel)			
AD HC 50-1/8	TAD.5100.042	400	17	17.0	8.6	2.280
AD HC 50-1/4	TAD.5100.104	400	22	25.0	11.4	5.500
AD HC 50-3/8	TAD.5100.166	400	22	26.0	15.0	4.400
AD HC 50-1/2	TAD.5100.228	400	27	34.0	18.6	8.430
AD HC 50-3/4	TAD.5100.292	200	32	36.0	24.1	10.690
AD HC 50-1	TAD.5100.414	200	46	43.0	30.3	33.200