

Note! All technical data are based on a working pressure of 6 bar and with oil.
Speed tolerance accuracy is $\pm 10\%$.

For ATEX conformity,
please contact Technical Sales

Note! Inlet and exhaust air flows are critical for reaching the best performances.

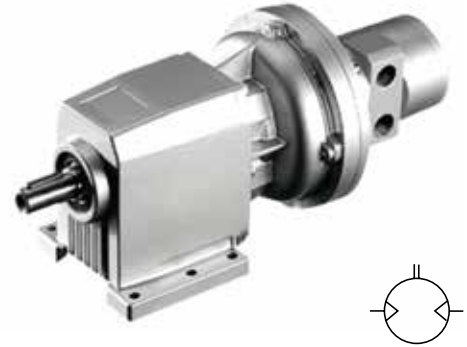

D, E: Reversible motor with helical (spur) gear box, flange (D) or foot bracket (E) mountings

Max power	Free speed	Nominal speed	Nominal torque	Min starting torque	Max gear box permanent torque	Air consumption	Connection	Min pipe ID inlet/ outlet	Weight	Max permissible shaft loading		At B3/2	Mounting	Gear box type & size	Order code	Mounting	Gear box type & size	Order code
Watt	rpm	rpm	Nm	Nm		l/s	BSPP	mm	kg	F radial (N)	F axial (N)	mm						
1600	660	590	24.0	36.0	45.0	31.7	G1/2	15/19	11.2	1140	228	20	Flange	S122F	P1V-A160D0066●●	Foot	S122K	P1V-A160E0066●●
1600	320	280	50.0	75.0	140.0	31.7	G1/2	15/19	12.2	2030	406	25	Flange	S222F	P1V-A160D0032●●	Foot	S222K	P1V-A160E0032●●
1600	140	120	120.0	180.0	280.0	31.7	G1/2	15/19	14.4	4030	806	30	Flange	S322F	P1V-A160D0014●●	Foot	S322K	P1V-A160E0014●●
1600	80	70	197.0	299.0	560.0	31.7	G1/2	15/19	32.2	5800	1160	35	Flange	S413F	P1V-A160D0008●●	Foot	S413K	P1V-A160E0008●●
1600	37	33	430.0	645.0	1000.0	31.7	G1/2	15/19	53.4	10000	2000	40	Flange	S513F	P1V-A160D0004●●	Foot	S513K	P1V-A160E0004●●
1600	21	18	716.0	1084.0	1600.0	31.7	G1/2	15/19	74.7	16000	3200	50	Flange	S614F	P1V-A160D0003●●	Foot	S614K	P1V-A160E0003●●
3200	800	565	51.0	77.0	42.0	65.0	G3/4	19/25	17.3	660	132	20	Flange	S122F	P1V-A320D0080●●	Foot	S122K	P1V-A320E0080●●
3200	520	365	79.5	119.0	115.0	65.0	G3/4	19/25	18.3	1750	350	25	Flange	S222F	P1V-A320D0052●●	Foot	S222K	P1V-A320E0052●●
3200	250	175	165.0	248.0	235.0	65.0	G3/4	19/25	20.3	3290	658	30	Flange	S322F	P1V-A320D0025●●	Foot	S322K	P1V-A320E0025●●
3200	110	80	362.0	544.0	500.0	65.0	G3/4	19/25	39.3	5130	1026	35	Flange	S412F	P1V-A320D0011●●	Foot	S412K	P1V-A320E0011●●
3200	55	40	710.0	1065.0	1000.0	65.0	G3/4	19/25	60.5	10000	2000	40	Flange	S513F	P1V-A320D0006●●	Foot	S513K	P1V-A320E0006●●
3200	30	20	1420.0	2130.0	1600.0	65.0	G3/4	19/25	76.0	16000	3200	50	Flange	S613F	P1V-A320D0003●●	Foot	S613K	P1V-A320E0003●●
5000	1050	625	72.0	108.0	80.0	96.7	G1	25/32	24.6	1370	274	25	Flange	S222F	P1V-A500D0105●●	Foot	S222K	P1V-A500E0105●●
5000	520	310	146.0	220.0	175.0	96.7	G1	25/32	27.0	2580	516	30	Flange	S322F	P1V-A500D0052●●	Foot	S322K	P1V-A500E0052●●
5000	250	150	302.0	450.0	385.0	96.7	G1	25/32	46.0	3880	776	35	Flange	S412F	P1V-A500D0025●●	Foot	S412K	P1V-A500E0025●●
5000	125	74	612.0	920.0	795.0	96.7	G1	25/32	67.2	8870	1770	40	Flange	S512F	P1V-A500D0013●●	Foot	S512K	P1V-A500E0013●●
5000	60	36	1230.0	1850.0	1600.0	96.7	G1	25/32	82.5	14500	2900	50	Flange	S613F	P1V-A500D0006●●	Foot	S613K	P1V-A500E0006●●
5000	30	18	2460.0	3700.0	4000.0	96.7	G1	25/32	164.0	35000	7000	70	Flange	S803F	P1V-A500D0003●●	Foot	S803K	P1V-A500E0003●●

•• Specify installation position in the order code as in the illustrations
Maximum admissible speed (idling)
Air consumption at the maximum air motor power

Note!
specify installation position in the order code as in the illustration below.
Example: P1V-A160D0066B5

Note: Oil-bath gearboxes mean that the installation position must be decided in advance. The installation position determines the volume of oil in the gearbox and location of oil filling and drain plugs.

D: Installation positions, helical gear and flange mounting

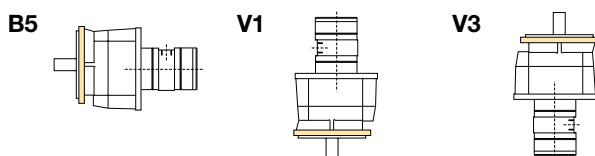

E: Installation positions, helical gear and foot mounting

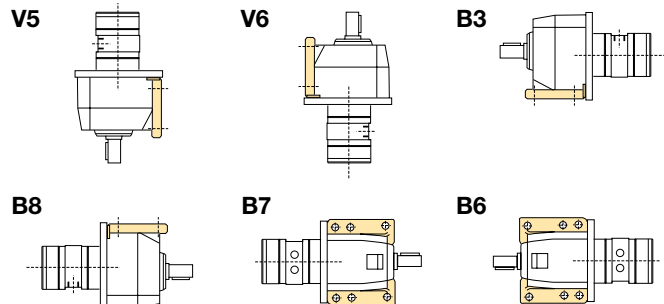

P1V-A160D00****, Spur gear box (D) Flange mounting

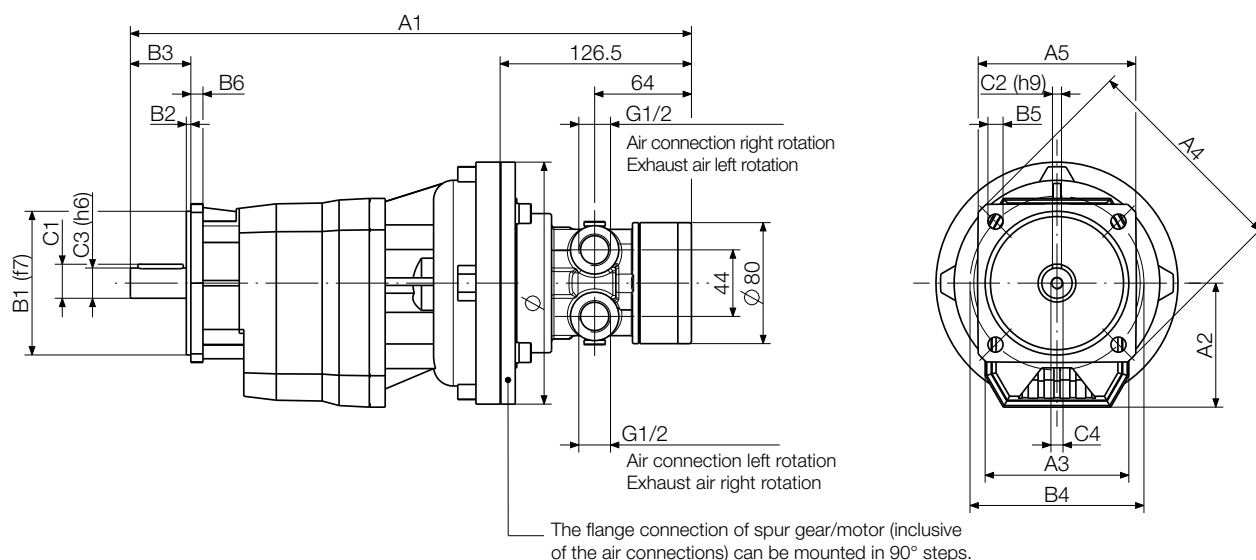

Order code	Dimensions (mm)														
	A1	A2	A3	A4	A5	B1	B2	B3	B4	B5	B6	C1	C2	C3	C4
P1V-A160D0066••	371,0	82,0	95,0	140,0	□ 105	95,0	3,0	40,0	115,0	9,5	8,0	22,5	6,0	20,0	M8 x 19
P1V-A160D0032••	400,0	94,0	110,0	160,0	□ 110	110,0	3,5	50,0	130,0	9,5	10,0	28,0	8,0	25,0	M8 x 19
P1V-A160D0014••	434,0	108,0	130,0	200,0	□ 150	130,0	3,5	60,0	165,0	11,5	12,0	33,0	8,0	30,0	M10 x 22
P1V-A160D0008••	463,0	128,0	155,0	250,0	-	180,0	4,0	70,0	215,0	14,0	13,0	38,0	10,0	35,0	M10 x 22
P1V-A160D0004••	489,0	152,0	185,0	300,0	-	230,0	4,0	80,0	265,0	14,0	16,0	43,0	12,0	40,0	M12 x 28
P1V-A160D0003••	616,0	178,5	210,0	350,0	-	250,0	5,0	100,0	300,0	18,0	18,0	53,5	14,0	50,0	M16 x 36

P1V-A160E00****, Spur gear box (E) Foot Bracket mounting

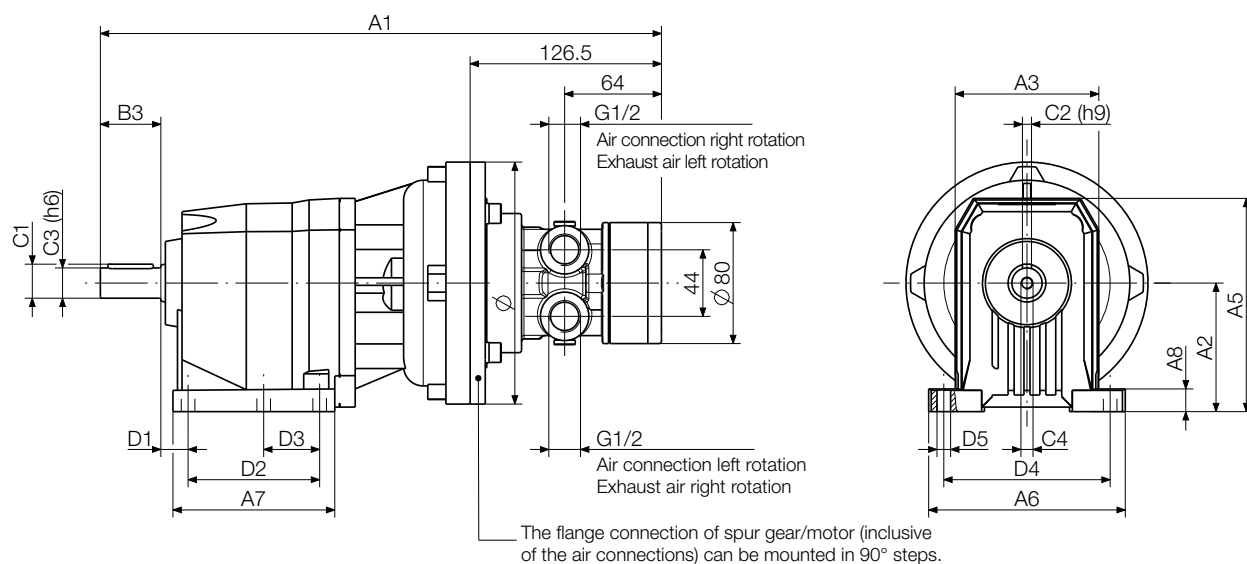

Order code	Dimensions (mm)																
	A1	A2	A3	A5	A6	A7	A8	B3	C1	C2	C3	C4	D1	D2	D3	D4	D5
P1V-A160E0066••	371,0	85,0	95,0	141,0	130,0	107,0	15,0	40,0	22,5	6,0	20,0	M8 x 19	18,0	87,0	37,0	110,0	9,0
P1V-A160E0032••	400,0	100,0	110,0	166,0	155,0	137,0	17,0	50,0	28,0	8,0	25,0	M8 x 19	18,0	107,5	47,5	130,0	11,0
P1V-A160E0014••	434,0	110,0	130,0	181,0	190,0	156,0	20,0	60,0	33,0	8,0	30,0	M10 x 22	18,0	130,0	60,0	160,0	11,0
P1V-A160E0008••	463,0	130,0	155,0	223,0	216,0	185,5	18,0	70,0	38,0	10,0	35,0	M10 x 22	19,5	149,5	-	180,0	14,0
P1V-A160E0004••	489,0	155,0	185,0	278,0	270,0	200,0	22,0	80,0	43,0	12,0	40,0	M12 x 28	25,0	156,0	-	225,0	18,0
P1V-A160E0003••	616,0	195,0	210,0	316,0	300,0	232,0	25,0	100,0	53,5	14,0	50,0	M16 x 36	25,0	180,0	-	250,0	18,0

P1V-A320D00••••, Spur gear box (D) Flange mounting

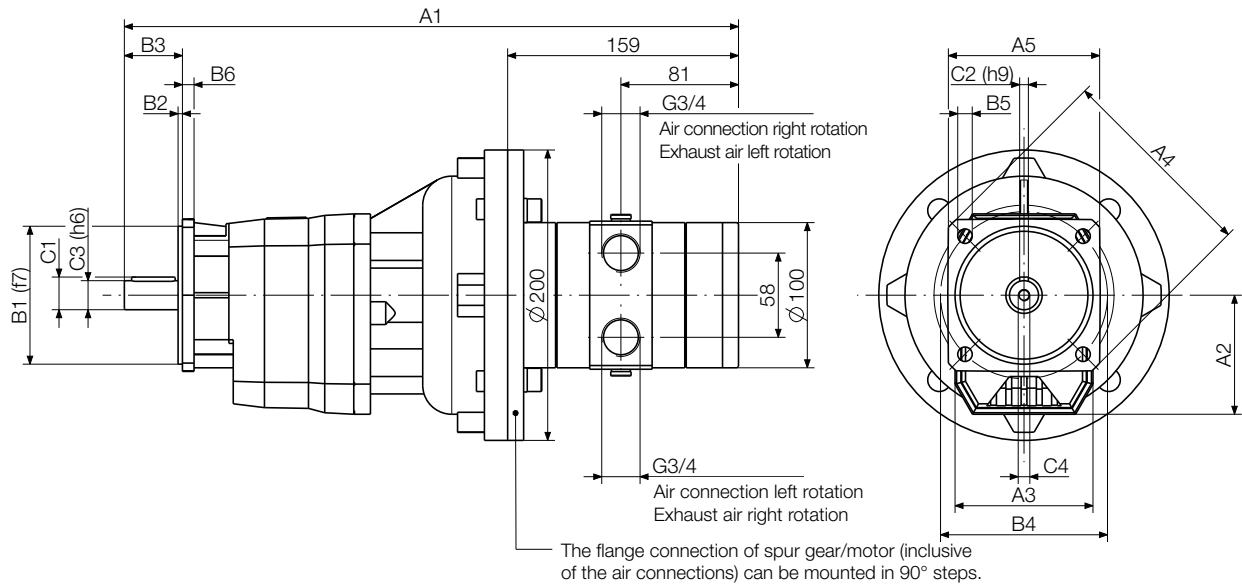

Order code	Dimensions (mm)															
	A1	A2	A3	A4	A5	B1	B2	B3	B4	B5	B6	C1	C2	C3	C4	
P1V-A320D0080••	423,0	82,0	95,0	140,0	□ 105	95,0	3,0	40,0	115,0	9,5	8,0	22,5	6,0	20,0	M8 x 19	
P1V-A320D0052••	451,0	94,0	110,0	160,0	□ 110	110,0	3,5	50,0	130,0	9,5	10,0	28,0	8,0	25,0	M8 x 19	
P1V-A320D0025••	486,0	108,0	130,0	200,0	□ 150	130,0	3,5	60,0	165,0	11,5	12,0	33,0	8,0	30,0	M10 x 22	
P1V-A320D0011••	515,0	128,0	155,0	250,0	-	180,0	4,0	70,0	215,0	14,0	13,0	38,0	10,0	35,0	M10 x 22	
P1V-A320D0006••	541,0	152,0	185,0	300,0	-	230,0	4,0	80,0	265,0	14,0	16,0	43,0	12,0	40,0	M12 x 28	
P1V-A320D0003••	594,0	178,5	210,0	350,0	-	250,0	5,0	100,0	300,0	18,0	18,0	53,5	14,0	50,0	M16 x 36	

P1V-A320E00••••, Spur gear box (E) Foot Bracket mounting

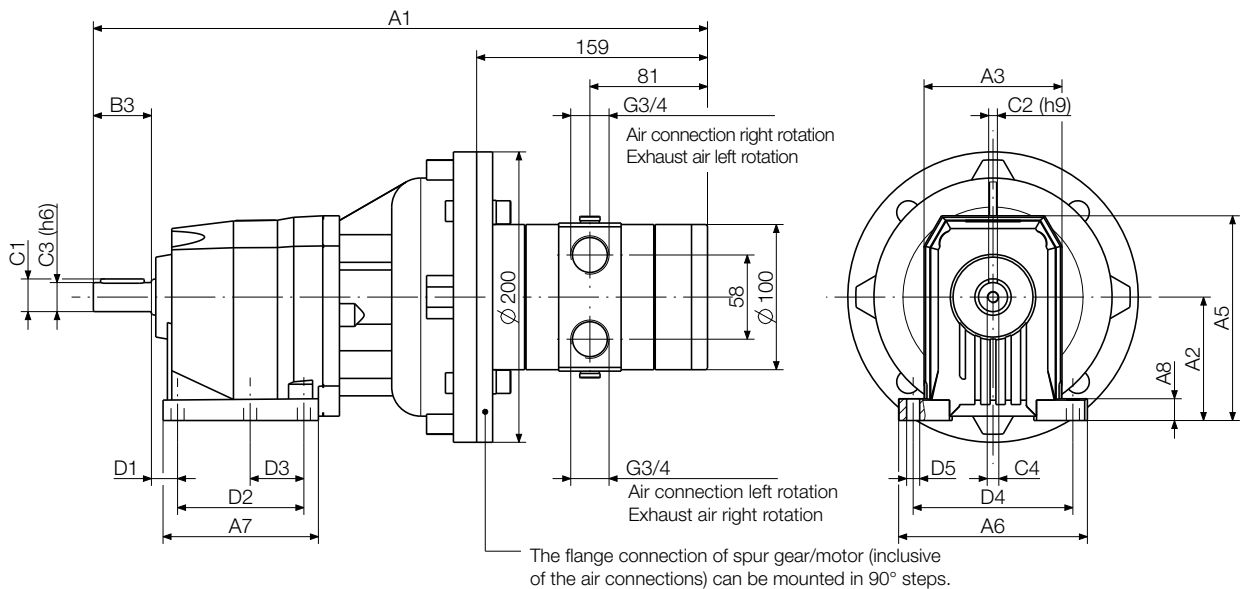

Order code	Dimensions (mm)																
	A1	A2	A3	A5	A6	A7	A8	B3	C1	C2	C3	C4	D1	D2	D3	D4	D5
P1V-A320E0080••	423,0	85,0	95,0	141,0	130,0	107,0	15,0	40,0	22,5	6,0	20,0	M8 x 19	18,0	87,0	37,0	110,0	9,0
P1V-A320E0052••	451,0	100,0	110,0	166,0	155,0	137,0	17,0	50,0	28,0	8,0	25,0	M8 x 19	18,0	107,5	47,5	130,0	11,0
P1V-A320E0025••	486,0	110,0	130,0	181,0	190,0	156,0	20,0	60,0	33,0	8,0	30,0	M10 x 22	18,0	130,0	60,0	160,0	11,0
P1V-A320E0011••	515,0	130,0	155,0	223,0	216,0	185,5	18,0	70,0	38,0	10,0	35,0	M10 x 22	19,5	149,5	-	180,0	14,0
P1V-A320E0006••	541,0	155,0	185,0	278,0	270,0	200,0	22,0	80,0	43,0	12,0	40,0	M12 x 28	25,0	156,0	-	225,0	18,0
P1V-A320E0003••	594,0	195,0	210,0	316,0	300,0	232,0	25,0	100,0	53,5	14,0	50,0	M16 x 36	25,0	180,0	-	250,0	18,0

P1V-A500D00••••, Spur gear box (D) Flange mounting

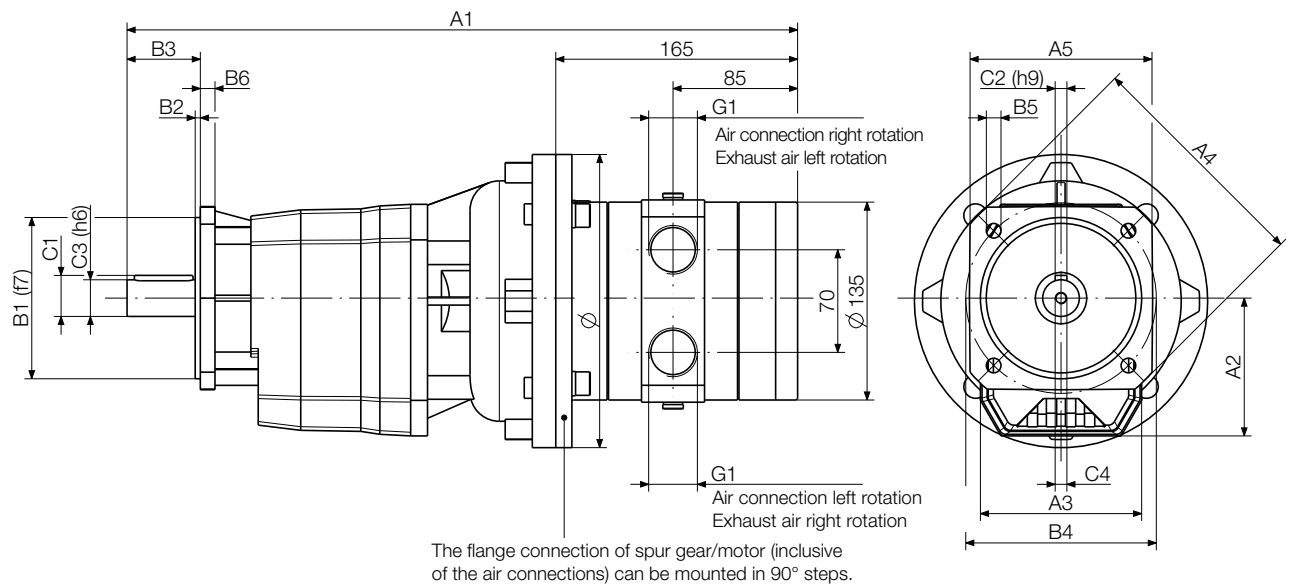

Order code	Dimensions (mm)														
	A1	A2	A3	A4	A5	B1	B2	B3	B4	B5	B6	C1	C2	C3	C4
P1V-A500D0080••	458,0	94,0	110,0	160,0	□ 110	110,0	3,5	50,0	130,0	9,5	10,0	28,0	8,0	25,0	M8 x 19
P1V-A500D0052••	492,0	108,0	130,0	200,0	□ 150	130,0	3,5	60,0	165,0	11,5	12,0	33,0	8,0	30,0	M10 x 22
P1V-A500D0025••	521,0	128,0	155,0	250,0	-	180,0	4,0	70,0	215,0	14,0	13,0	38,0	10,0	35,0	M10 x 22
P1V-A500D0011••	547,0	152,0	185,0	300,0	-	230,0	4,0	80,0	265,0	14,0	16,0	43,0	12,0	40,0	M12 x 28
P1V-A500D0006••	600,0	178,5	210,0	350,0	-	250,0	5,0	100,0	300,0	18,0	18,0	53,5	14,0	50,0	M16 x 36
P1V-A500D0003••	698,0	247,0	320,0	400,0	□ 350	300,0	5,0	140,0	350,0	18,0	20,0	85,0	22,0	80,0	M20 x 42

P1V-A500E00••••, Spur gear box (E) Foot Bracket mounting

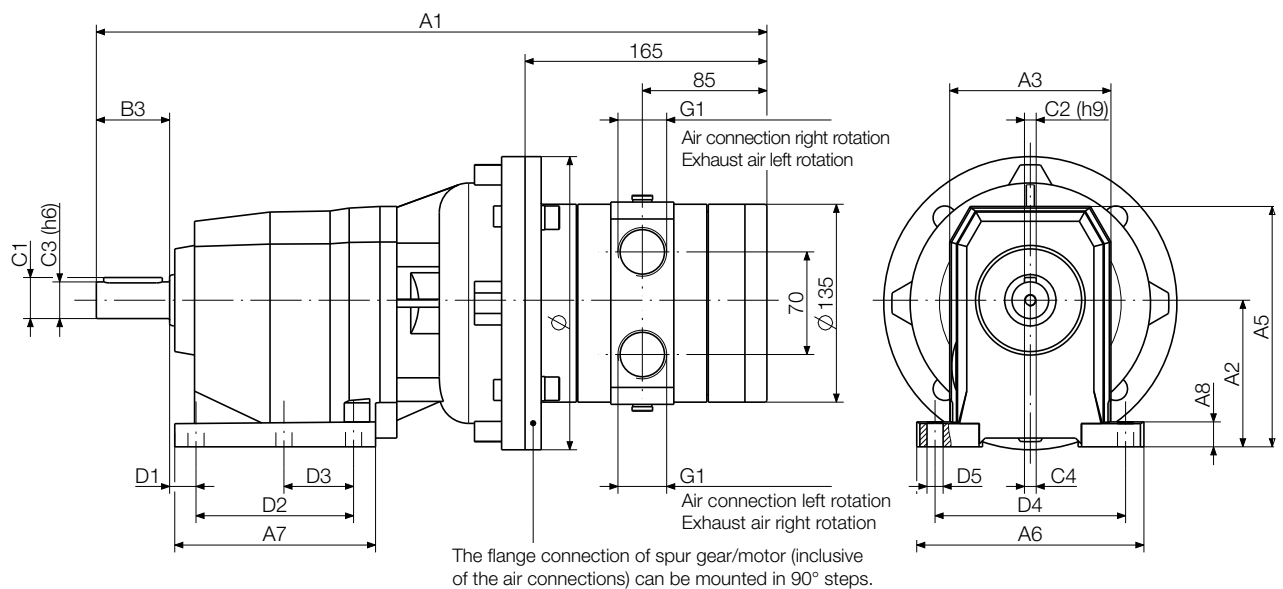

Order code	Dimensions (mm)																
	A1	A2	A3	A5	A6	A7	A8	B3	C1	C2	C3	C4	D1	D2	D3	D4	D5
P1V-A500E0080••	458,0	100,0	110,0	166,0	155,0	137,0	17,0	50,0	28,0	8,0	25,0	M8 x 19	18,0	107,5	47,5	130,0	11,0
P1V-A500E0052••	492,0	110,0	130,0	181,0	190,0	156,0	20,0	60,0	33,0	8,0	30,0	M10 x 22	18,0	130,0	60,0	160,0	11,0
P1V-A500E0025••	521,0	130,0	155,0	223,0	216,0	185,5	18,0	70,0	38,0	10,0	35,0	M10 x 22	19,5	149,5	-	180,0	14,0
P1V-A500E0011••	547,0	155,0	185,0	278,0	270,0	200,0	22,0	80,0	43,0	12,0	40,0	M12 x 28	25,0	156,0	-	225,0	18,0
P1V-A500E0006••	600,0	195,0	210,0	316,0	300,0	232,0	25,0	100,0	53,5	14,0	50,0	M16 x 36	25,0	180,0	-	250,0	18,0
P1V-A500E0003••	698,0	250,0	320,0	420,0	440,0	277,0	35,0	140,0	85,0	22,0	80,0	M20 x 42	33,0	210,0	-	370,0	26,0