

# Brass Adaptors

**0122**

## Barb Connector for Hose



Brass

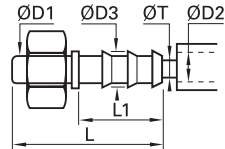

ØD1	ØD2		ØD3	L	L1	ØT min	kg
4	4	<a href="#">0122 04 04</a>	6	37.5	22.5	3	0.004
5	4	<a href="#">0122 05 04</a>	6	37.5	22.5	3	0.003
6	4	<a href="#">0122 06 04</a>	6	37.5	22.5	3	0.005
	7	<a href="#">0122 06 07</a>	9	37.5	22.5	6	0.007
8	6	<a href="#">0122 08 06</a>	8	40	22.5	5	0.007
	7	<a href="#">0122 08 07</a>	9	40	22.5	6	0.008
10	10	<a href="#">0122 08 10</a>	12.5	40	22.5	9	0.013
	7	<a href="#">0122 10 07</a>	9	43	22.5	6	0.010
12	10	<a href="#">0122 10 10</a>	12.5	43	22.5	9	0.014
	10	<a href="#">0122 12 10</a>	12.5	43	22.5	9	0.014
14	13	<a href="#">0122 12 13</a>	15	50	29.5	12	0.018
	13	<a href="#">0122 14 13</a>	15	52	29.5	12	0.019
16	16	<a href="#">0122 14 16</a>	18.5	60.5	38	15	0.308
	13	<a href="#">0122 15 13</a>	15	52	29.5	12	0.019
18	16	<a href="#">0122 15 16</a>	18.5	60.5	38	15	0.032
	13	<a href="#">0122 16 13</a>	15	53.5	29.5	12	0.021
20	16	<a href="#">0122 16 16</a>	18.5	62	38	15	0.032
	16	<a href="#">0122 18 16</a>	18.5	62	38	15	0.032
22	19	<a href="#">0122 18 19</a>	21.5	62	38	18	0.041
	16	<a href="#">0122 20 16</a>	18.5	64	38	15	0.034
25	19	<a href="#">0122 20 19</a>	21.5	64	38	18	0.038
	19	<a href="#">0122 22 19</a>	21.5	64	38	18	0.039
28	19	<a href="#">0122 25 19</a>	21.5	70	38	18	0.049
	25	<a href="#">0122 25 25</a>	27.5	70	38	24	0.054
	25	<a href="#">0122 28 25</a>	27.5	70	38	24	0.087

**0165**

## Barb Connector for Flexible Tubing



Brass

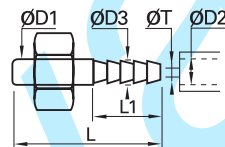

ØD1	ØD2		ØD3	L	L1	ØT min	kg
4	4	<a href="#">0165 04 06</a>	4.3	30	15	2	0.002
5	4	<a href="#">0165 05 06</a>	4.3	30	15	2	0.010
6	4	<a href="#">0165 06 06</a>	4.3	30	15	2	0.003
	6	<a href="#">0165 06 08</a>	6.4	30	15	4	0.004
8	8	<a href="#">0165 06 10</a>	8.4	30	15	4	0.004
	6	<a href="#">0165 08 08</a>	6.4	32.5	15	4	0.006
10	8	<a href="#">0165 08 10</a>	8.4	32.5	15	6	0.006
	10	<a href="#">0165 08 12</a>	10.7	37.5	20	8	0.009
12	8	<a href="#">0165 10 10</a>	8.4	35.5	15	6	0.008
	10	<a href="#">0165 10 12</a>	10.7	40.5	20	8	0.010
14	12	<a href="#">0165 10 14</a>	12.7	40.5	20	8	0.012
	10	<a href="#">0165 12 12</a>	10.7	40.5	20	8	0.011
16	12	<a href="#">0165 12 14</a>	12.7	40.5	20	10	0.013
	12	<a href="#">0165 14 14</a>	12.7	42.5	20	10	0.014
	15	<a href="#">0165 15 16</a>	13.7	42.5	20	11	0.016
	13	<a href="#">0165 16 16</a>	13.7	44	20	11	0.018

### Assembly: Barb Connectors

Our barb connectors 0122 and 0165 are designed to be used with different types of hose. They are secured using the nut and olive provided with the fitting.

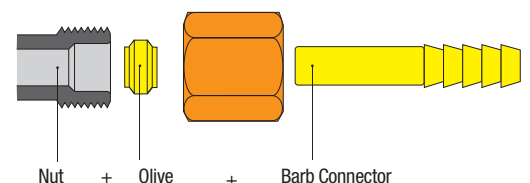



# Brass Adaptors

## 0126 Plug for Compression Fitting

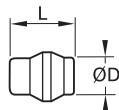

Brass



ØD		L	kg
4	0126 04 00	10	0.001
5	0126 05 00	10	0.003
6	0126 06 00	10	0.003
8	0126 08 00	11.5	0.006
10	0126 10 00	13	0.010
12	0126 12 00	13	0.014
14	0126 14 00	13.5	0.020
15	0126 15 00	13.5	0.022
16	0126 16 00	16	0.029
18	0126 18 00	16	0.039
20	0126 20 00	16	0.045
22	0126 22 00	18	0.003
28	0126 28 00	19.5	0.108

The plug is used to blank off an outlet in a compression fitting, replacing the olive.  
When an open outlet is required, simply dismantle and replace the plug with the tube olive, reusing the nut.  
The plug is also reusable.

## 0125 Tube End Plug for Compression Fitting

Brass

ØD

C

F

L

L1

kg

4

M8x1

0125 04 00

10

12

8

0.006

6

M10x1

0125 06 00

11

13.5

9.5

0.008

8

M12x1

0125 08 00

14

14

9

0.013

10

M16x1.5

0125 10 00

17

18

11

0.025

12

M18x1.5

0125 12 00

19

18

11

0.030

14

M20x1.5

0125 14 00

22

19

11

0.041

This plug enables unused tubes to be blanked off.

The male thread on the plug has the same pitch as the female thread on the sleeve nut of a standard Parker Legris fitting. Therefore the plug screwed into the sleeve nut blanks off the tube.

To reopen the passage, simply unscrew the plug and fit the required coupler.

No further treatment of the tube is required.

## 0220 Hex Head Plug with Captive Sealing Washer, Male BSPP and Metric Thread



Brass, technical polymer

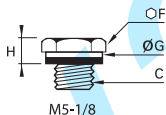

M5-1/8

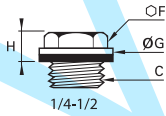

1/4-1/2

C		F	G	H	kg
M5x0.8	0220 19 00	8	8	5	0.002
G1/8	0220 10 00	14	14	7.5	0.011
G1/4	0220 13 00	17	17	7.5	0.019
G3/8	0220 17 00	17	22	8.5	0.024
G1/2	0220 21 00	22	27	10	0.040

Thread with pre-assembled washer.  
M5: with screwdriver slot for tightening.  
Maximum allowable working pressure = 20 bar.  
Part number with suffix 99, maximum allowable working pressure = 250 bar, example: 0220 19 00 99.  
Conforms to BNA 229 (with the exception of M5 model): BSPP thread, ISO ISO 228-1;  
metric thread, ISO NFE 03-054.

## 0220..39 Hex Head Plug with Bi-Material Seal, Male BSPP Thread

Brass, zinc-plated steel with NBR seal

C		F	G	H1	kg
G1/8	0220 10 00 39	14	14	6.5	0.012
G1/4	0220 13 00 39	17	17	6.5	0.020
G3/8	0220 17 00 39	17	22	8	0.025
G1/2	0220 21 00 39	22	26	9	0.043
G3/4	0220 27 00 39	22	32	10	0.060
G1	0220 34 00 39	27	39.5	10.5	0.089

Plug with bi-material seal.  
Bi-material washers part number 0139 can be found in Chapter 9.

# Brass Adaptors

## 0120

### Stud Standpipe, Male BSPT Thread



Brass

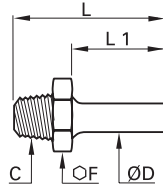

ØD	C		F	L	L1	kg
4	R1/8	<a href="#">0120 04 10</a>	11	25.5	14	0.007
5	R1/8	<a href="#">0120 05 10</a>	11	26	14.5	0.007
6	R1/8	<a href="#">0120 06 10</a>	11	26.5	15	0.008
	R1/4	<a href="#">0120 06 13</a>	14	31	15	0.015
8	R1/8	<a href="#">0120 08 10</a>	11	28.5	17	0.009
	R1/4	<a href="#">0120 08 13</a>	14	33	17	0.016
10	R3/8	<a href="#">0120 08 17</a>	17	33.5	17	0.020
	R1/4	<a href="#">0120 10 13</a>	14	36	20	0.018
	R3/8	<a href="#">0120 10 17</a>	17	36.5	20	0.022
12	R1/2	<a href="#">0120 10 21</a>	22	41	20	0.038
	R1/4	<a href="#">0120 12 13</a>	14	36	20	0.018
14	R3/8	<a href="#">0120 12 17</a>	17	36.5	20	0.022
	R1/2	<a href="#">0120 12 21</a>	22	41	20	0.041
16	R3/8	<a href="#">0120 14 17</a>	17	38	21.5	0.024
	R1/2	<a href="#">0120 14 21</a>	22	42.5	21.5	0.041
18	R3/8	<a href="#">0120 15 17</a>	17	38	21.5	0.023
	R1/2	<a href="#">0120 15 21</a>	22	42.5	21.5	0.041
20	R3/8	<a href="#">0120 16 17</a>	17	39.5	23	0.024
	R1/2	<a href="#">0120 16 21</a>	22	44	23	0.042
22	R1/2	<a href="#">0120 18 21</a>	22	44.5	23.5	0.042
	R3/4	<a href="#">0120 18 27</a>	27	47.5	23.5	0.071
24	R3/4	<a href="#">0120 20 27</a>	27	49	25	0.071
	R3/4	<a href="#">0120 22 27</a>	27	48.5	25.5	0.067
26	R1	<a href="#">0120 22 34</a>	36	52.5	25.5	0.116
	R1	<a href="#">0120 25 34</a>	36	57	30	0.119
28	R1	<a href="#">0120 28 34</a>	36	57	30	0.138

## 0112

### Sleeve Nut for Compression Fitting, Male Metric Thread



Brass

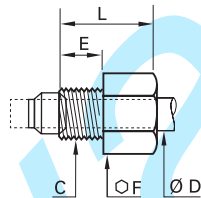

ØD	C		E	F	L	kg
4	M8x1	<a href="#">0112 04 00</a>	7	10	13	0.005
5	M10x1	<a href="#">0112 05 00</a>	7.5	11	13.5	0.007
6	M10x1	<a href="#">0112 06 00</a>	7.5	11	13.5	0.006
8	M12x1	<a href="#">0112 08 00</a>	8	13	15	0.008
10	M16x1.5	<a href="#">0112 10 00</a>	11	17	18	0.018
12	M18x1.5	<a href="#">0112 12 00</a>	11	19	18	0.021
14	M20x1.5	<a href="#">0112 14 00</a>	11	22	18	0.026

This product was designed to allow the tube to be fitted directly into the tapped port in a body using a standard Parker Legris olive.  
For the corresponding drawings (cavity for Parker Legris olive), please consult us.

# Brass Adaptors

## 0128..39 Stud Standpipe with Bi-Material Seal, Male BSPP Thread

	ØD	C		E	F	H	Kg
4	G1/8	0128 04 10 39		7.5	13	20	0.009
	G1/4	0128 04 13 39		9	17	22	0.015
6	G1/8	0128 06 10 39		7.5	13	21	0.010
	G1/4	0128 06 13 39		9	17	23	0.016
8	G1/8	0128 08 10 39		7.5	13	23	0.011
	G1/4	0128 08 13 39		9	17	25	0.017
10	G3/8	0128 08 17 39		12	22	26	0.033
	G1/4	0128 10 13 39		9	17	28	0.018
14	G3/8	0128 10 17 39		12	22	29	0.034
	G1/2	0128 10 21 39		27	27	30	0.048
18	G3/8	0128 14 17 39		12	22	30.5	0.035
	G1/2	0128 14 21 39		27	27	31.5	0.049
22	G1/2	0128 18 21 39		27	27	33.5	0.052
	G3/4	0128 18 27 39		14	32	34.5	0.084
28	G3/4	0128 22 27 39		14	32	36.5	0.082
	G1	0128 22 34 39		16.5	41	38	0.123
28	G1	0128 28 34 39		16.5	41	42.5	0.149

With bi-material seal.  
Bi-material washers part number 0139 can be found in Chapter 9.

## 0151..39 Straight Male Orientable Adaptor, with Bi-Material Seal, Male BSPP Thread

	C		E	E1	F	F1	H	H1	kg
G1/8	0151 10 10 39		5.5	7	13	14	6	6.5	0.017
G1/4	0151 13 13 39		7	8.5	17	19	6.5	9	0.036
G3/8	0151 17 17 39		9.5	9.5	22	22	9	9	0.057
G1/2	0151 21 21 39		10.5	10.5	27	27	10	10	0.083
G3/4	0151 27 27 39		11.5	11.5	32	32	11	10	0.121
G1	0151 34 34 39		13	13.5	41	41	12.5	10.5	0.230

With bi-material seal.  
Bi-material washers part number 0139 can be found in Chapter 9.

## 0168..39 Reducer, with Bi-Material Seal, Male BSPP Thread/Female BSPP and Metric Thread



	C1	C2		E	F	H	kg
G1/8	M5x0.8	0168 10 19 39		8	14	4.5	0.009
G1/4	M5x0.8	0168 13 19 39		8	17	5	0.018
G3/8	G1/8	0168 13 10 39		8	17	5	0.012
	G1/4	0168 17 10 39		10	19	5	0.020
G1/2	G1/8	0168 17 13 39		10	19	5	0.013
	G1/4	0168 21 10 39		12	24	7.5	0.052
G3/4	G1/4	0168 21 13 39		12	24	7.5	0.043
	G3/8	0168 21 17 39		12	24	7.5	0.030
G1	G1/4	0168 27 13 39		12	32	9.5	0.099
	G3/8	0168 27 17 39		12	32	9.5	0.086
G1	G1/2	0168 27 21 39		12	32	9.5	0.065

With bi-material seal.  
Bi-material washers part number 0139 can be found in Chapter 9.

# Brass Adaptors

**0127**

Tube Support for Polymer Tubing

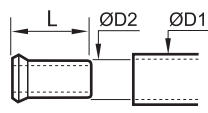
	Brass	ØD1	ØD2		L	kg
		4	2	<a href="#">0127 04 00</a>	11	0.001
			2.7	<a href="#">0127 04 27</a>	11	0.001
		5	3	<a href="#">0127 05 03</a>	11	0.001
			3.3	<a href="#">0127 05 00</a>	11.5	0.009
		6	4	<a href="#">0127 06 00</a>	11.5	0.001
			5.5	<a href="#">0127 08 55</a>	14	0.001
		8	6	<a href="#">0127 08 00</a>	14	0.001
			7	<a href="#">0127 10 07</a>	18	0.001
		10	7.5	<a href="#">0127 10 75</a>	18	0.001
			8	<a href="#">0127 10 00</a>	18	0.002
			8	<a href="#">0127 12 08</a>	18	0.002
		12	9	<a href="#">0127 12 09</a>	18	0.002
			10	<a href="#">0127 12 00</a>	18	0.001
			11	<a href="#">0127 14 11</a>	18	0.002
		14	12	<a href="#">0127 14 00</a>	18	0.002
			12	<a href="#">0127 15 12</a>	18	0.002
		16	13	<a href="#">0127 16 13</a>	18	0.003
			14	<a href="#">0127 18 14</a>	19.5	0.003
		20	15	<a href="#">0127 20 15</a>	20.5	0.003
			16	<a href="#">0127 22 16</a>	21	0.004
		25	19	<a href="#">0127 25 19</a>	25	0.007

This tube support guarantees good gripping, at high temperatures and pressures, by preventing collapsing of the tube.